



2026 WIN CONFERENCE

NAVIGATING THE CURRENTS IN HEALTHCARE AND ACADEMIA:

Bridging Research, Practice, and Education

APRIL 21-24 | SAN FRANCISCO, CA



UNIVERSITY OF
SAN FRANCISCO
School of Nursing and
Health Professions

UCSF School of
Nursing

UCSF Health

MAYO
CLINIC



Samuel Merritt
University



UNIVERSITY OF
SAN FRANCISCO

School of Nursing and
Health Professions

CREATING VISIONARY LEADERS IN HEALTH CARE

The Health Systems Leadership program teaches you to guide a team that identifies and solves issues in health care. The health landscape changes constantly as new technology, treatments, regulations, and challenges develop, and the world needs nurses who can navigate these complexities and deliver care to all. Become a leader at USF and make an impact in your community.

LEARN MORE

usfca.edu/nursing
415.422.2806
health@usfca.edu





Table of Contents

General Information..... 11

2026 WIN Awards and Honors 17

Our Donors..... 18

Program

Tuesday, April 21 21

Wednesday, April 22..... 22

Thursday, April 23..... 33

Friday, April 24 44

Poster Session Floor Plan 46

Poster Sessions

Poster Session 1..... 47-54

Poster Session 2..... 55-62

Poster Session 3..... 63-70

Poster Session 4..... 71-78

Conference Floor Plan..... 79

WIN Board of Governors



President

Lauren Clark, PhD, RN, FAAN
UCLA School of Nursing



Governor-at-Large

Heather Coats, PhD,
APRN-BC, FAAN
University of Colorado
College of Nursing



Governor Representative of Nursing Research

Andrea Wallace, PhD, RN, FAAN
University of Utah
College of Nursing



President-Elect

Austin Nation, PhD, RN,
PHN, NE-BC
California State University,
Fullerton School of Nursing



Governor Representative of Nursing Practice

Annette S. Nasr, PhD, RN,
MPA, NE-BC, FAAN
Stanford Medicine
Children's Health



Governor Representative of Student Members

Kimberly Kassab, MS, APRN,
AGCNS-BC, EBP-C, PMH-BC
University of Colorado
College of Nursing



Secretary-Treasurer

Patricia Daly, PhD, FNP-BC,
ENP-BC, FAANP
University of Arizona
College of Nursing



Governor Representative of Nursing Education

Joanne Noone, PhD, RN, CNE,
ANEF, FAAN
Oregon Health & Science
University School of Nursing

Congratulations

Sandra J. Weiss, PhD, RN, FAAN

*Professor and Robert and Delphine Eschbach Endowed Chair
in Mental Health Nursing*

2026 WIN Distinguished Research Lectureship Award



Sandra's groundbreaking research has profoundly influenced advances in disease prevention and health promotion for very young children and pregnant women. She has contributed to over 540 publications and as a skilled educator, administrator, and mentor, created opportunities for countless emerging nurse scientists to thrive.

*Thank you, Sandra, for shaping
the care and health of generations.*

Mayo Clinic Nurse Scientists

Nursing research that changes lives.



ARE YOU READY TO BE THE NEXT ASSOCIATE DEAN FOR NURSING RESEARCH?

Mayo Clinic in Rochester is hiring a leader that will inspire and shape the future of nursing on a global stage. As the Associate Dean for Nursing Research, you will guide a talented community of nurse scientists dedicated to improving the lives of patients and families through discovery and innovation.

This role is grounded in a patient-centered, collaborative culture that offers strong institutional support and resources. More than a leadership position, it is an opportunity to grow professionally while making a lasting difference in nursing practice and healthcare worldwide.

To learn more about becoming the Associate Dean of Nursing Research, scan the QR code or visit jobs.mayoclinic.org/nurse-scientist-jobs





**Samuel Merritt
University**

A Leader in Nursing Education Since 1909

For more than a century, Samuel Merritt University has advanced healthcare education and prepared graduates to lead with skill, compassion, and innovation.

The SMU Nursing Advantage

- Practice in advanced simulation labs
- Learn from experienced faculty who care
- Train with leading clinical partners
- Join a compassionate, forward-thinking

With campuses across the San Francisco Bay Area and Central Valley, SMU offers nursing programs designed to prepare the next generation of healthcare leaders.

Undergraduate to doctoral pathways available:
BSN | MSN | DNP

Explore Our Other Health Programs:
Physical Therapy | Occupational Therapy
Physician Assistant | Podiatric Medicine



Learn more:
smu.pub/nursing

WIN Program Committee

Chair: Kristin Lutz, PhD, RN,
University of Alaska Anchorage

Alycia A. Bristol, PhD, RN, AGCNS-BC,
University of Utah

Annette Carley, DNP, RN, NP,
University of California, San Francisco

Andra Davis, PhD, MN, RN,
University of Portland

Catherine De Leon, PhD, RN,
University of San Diego

Cara Gallegos, PhD, RN, EBP-C, Providence

Perry Gee, PhD, RN, Intermountain Health

Abigail Gómez-Morales, PhD, RN,
Arizona State University

Martha L. Grubaugh, PhD, RN, NE-BC,
FAONL, University of Colorado Health

Shigeko (Seiko) Izumi, PhD, RN, FPCN,
Oregon Health & Science University

Ahlam J. Adalla, PhD, RN, EBP-C, FAAN,
Hoag and California State University,
Long Beach

Ryoko Kausler, PhD, FNP-BC, MN, RN,
Boise State University

Hannah J. Kim, PhD, RN, CNL, PHN,
Kaiser Permanente

Mary S. Koithan, PhD, RN, CNS-BC, FAAN,
University of Washington

Cherry Leung, PhD, RN, University of
California, San Francisco

Lauri Linder, PhD, APRN, CPON, FAAN,
FAPHON, University of Utah

Annette S. Nasr, PhD, RN, MPA, NE-BC,
FAAN, Stanford Medicine Children's Health

Joanne Noone, PhD, RN, FAAN,
Oregon Health & Science University

Jessica Rainbow, PhD, RN, CNE,
University of Arizona

Teresa L. Rangel, PhD, MSN, RN, CNL,
Eastern Washington University

Krista Scorsone, PhD, RN, Regis University

Ruth E. Taylor-Piliae, PhD, RN, FAHA,
FAAN, University of Arizona

Doria Thiele, PhD, CNM, RN, California
State University, Sacramento

Alice Tse, PhD, APRN, FAAN,
University of Hawaii at Manoa

Andrea Wallace, PhD, RN, FAAN,
University of Utah

Kristi Westphaln, PhD, RN, CPNP-PC,
University of California, Los Angeles

Fang Yu, PhD, RN, FAAN,
Arizona State University

Shumenghui Zhai, PhD, MPH, RN,
Pacific Lutheran University

Abstract Reviewers

Heather Abraham	Cynthia D. Connelly	Martha L. Grubaugh	Ann O. Lawani	Fahad Noshili	Ruth E. Taylor-Piliae
Marife Aczon-Armstrong	Teresita Corvera-Tindel	Carla Hagen	Feng Ping Lee	Nassrine Nouredine	Doria Thiele
Randi Arias-Fontenot	Janice D. Crist	Rhoberta Haley	Hyunhwa "Henna" Lee	Pius Omolewa	Kathleen Thimsen
Cheryl Armstrong	Andra Davis	Kholoud Hardan-Khalil	Jung-Ah Lee	Melissa I. Owen	Hilaire Thompson
Deb Bakerjian	Catherine De Leon	Margaret Heitkemper	Kathryn A. Lee	Eyitayo Omolara Owolabi	Veronica Timple
Patricia Barfield	Tina D. DeLapp	Melissa Henry	Necole Leland	Kelsey Jane Pascoe	Dante Anthony Tolentino
Lisa Ann Barry	Holli DeVon	Natalie Heywood	Cherry Leung	Ginette A. Pepper	Linda Trader
Amy J. Barton	Hanne Dolan	Brenda Hulett	Lauri Linder	Nancy Pike	Alice Tse
Judith Berg	Caroline Etland	Mary M. Hunter	Marie L. Lobo	Elbina Rafizadeh	Andrea Wallace
Jodicy Annalynn Bondurant	Ameera Fayad	Shigeko (Seiko) Izumi	Kristin Lutz	Jessica Rainbow	Elaine Walsh
John Bressan	Bronwyn E. Fields	Ahlam A. Jadalla	Bret Lyman	Teresa Louise Rangel	Shu-Yi Wang
Alycia A. Bristol	Jenny Firkins	Lisa A. Jaurigue	Adrienne Martinez-Hollingsworth	Shelly J. Reed	Theresa Watts
Michael V. Bueno	Brady Franklin	Jasmine Kaneshiro	Jennifer May	Lisa R. Roberts	Allison Webel
Emily Calabro	Cara Gallegos	Ryoko Kausler	Paula M. Meek	Anne G. Rosenfeld	Kristi Westphaln
Hollie Caldwell	Ana Maria Gallo	Katherine Kenny	Cristian Mendoza Ruvalcaba	Amy Miner Ross	Nancy Wiederhold
Annette Carley	Teresa Garrett	Siri Gurunam Kaur Khalsa	Willoughby Moloney	May San-Rozano	Charlene A. Winters
Fang-yu Chou	Perry Gee	Hannah J. Kim	Annette S. Nasr	Krista Scorsone	Kyla F. Woodward
Scott S. Christensen	Sheila Gephart	Yeon Sook Kim	September T. Nelson	Jean Shreffler-Grant	Fang Yu
Lauren Clark	Kathleen Gilchrist	Mary S. Koithan	Fayette K. Nguyen Truax	Jennifer M.L. Stephens	Germin Zaki
Heather Coats	Abigail Gómez-Morales	Cheryl Lacasse	Joanne Noone	Asma Taha	Lisa S. Zenoni
					Shumenghui Zhai

THANK YOU TO OUR SPONSORS

PRESENTING SPONSORS



GOLD SPONSORS



SILVER SPONSORS



SCHOLARS ACADEMY

10 YEARS | A LEGACY OF TRANSFORMATION



An Ecosystem of Excellence and System Transformation

The promise of tomorrow is already here: a future where technology amplifies caring, where innovation strengthens humanity, and where professional nursing stands as both a steward of compassion and an architect of progress in a world yet to be realized.

Within integrated health care systems, nurses serve not only as clinicians and leaders, but as scientists generating new knowledge. The role of the nurse scientist affirms nursing's responsibility to lead research that informs practice, leadership decisions, and system design. This progress is realized through PhD-DNP partnerships, linking discovery to implementation, evidence to outcomes, and scholarship to transformation across health systems.



Love people and serve them!

~ Henry J. Kaiser

SAVE THE DATE

2027 WIN CONFERENCE



Shining and Redesigning:
Celebrating 60 Years of Nursing Excellence
in Research, Practice, and Education

APRIL 6-9 | BELLEVUE, WA

State of the Science Speakers:

RESEARCH

Teri Hernandez, PhD, RN, FAAN, Professor, Associate Dean of Research and Scholarship, University of Colorado College of Nursing

PRACTICE

Jim D'Alfonso, DNP, RN, PhD(h), NEA-BC, FNAP, FAAN, Executive Director, Professional Excellence and the Kaiser Permanente Scholars Academy, Kaiser Permanente Northern California Regional Patient Care Services

EDUCATION

Sarah Shannon, PhD, RN, FAAN, Dean and Professor, Montana State University Mark and Robyn Jones College of Nursing

WWW.WINURSING.ORG



General Information

The Western Institute of Nursing acknowledges that the conference is being held on the unceded Ancestral homeland of the Ramaytush Ohlone peoples, who are the original inhabitants of the San Francisco Peninsula. We recognize that the Ramaytush Ohlone understand the interconnectedness of all things and have maintained harmony with nature for millennia. We honor the Ramaytush Ohlone peoples for their enduring commitment to Mother Earth. As the Indigenous protectors of this land and in accordance with their traditions, the Ramaytush Ohlone have never ceded, lost, nor forgotten their responsibilities as the caretakers of this place, as well as for all peoples who reside in their traditional territory. As uninvited guests, we affirm their sovereign rights as First Peoples and wish to pay our respects to the Ancestors, Elders and Relatives of the Ramaytush Community.

Registration

All participants must register for the conference and wear their name badges at all times.

Continuing Nursing Education Credit

This nursing continuing professional development activity was approved by Oregon Nurses Association, an accredited approver by the American Nurses Credentialing Center's Commission on Accreditation.

A maximum of 19.0 contact hours is available for the conference. The expiration date for awarding contact hours is December 31, 2026. All evaluations are completed online.

None of the presenters or planners for this activity have relevant financial relationships with ineligible companies to disclose.

To receive your certificate:

- Visit the online evaluation site, which will be emailed to you along with log-in information, and complete an evaluation of every **preconference**, **plenary**, and **concurrent session** you attend. You may log in during the conference or following the conference to complete the evaluations.
- Complete the overall conference evaluation form, which will be available after the conference has adjourned.
- Once all evaluations are complete, including the overall conference evaluation form, the system will calculate your contact hours and you may print your certificate. The print option will not be available until the conference has adjourned, at which time the overall evaluation form will be available.

The WIN Program Committee uses your feedback to assist in planning future conferences.

Silent Auction

WIN's annual Silent Auction will be held in Yosemite beginning at 1 p.m. on Wednesday and ending at 5 p.m. on Thursday. All proceeds benefit the WIN Endowment Fund, which supports the annual WIN awards and grants.

Awards Lunch

WIN awards will be presented during the Awards Lunch on Wednesday from 12:30 to 1:30 p.m. Pre-registration is required.

Special Interest Groups

Special Interest Group meetings will be held on Wednesday and Thursday evenings and are open to all.

Exhibits

We welcome our exhibitors and encourage all participants to visit their booths in Grand Ballroom A.

Booth #	Exhibitor
100	Montana State University Mark and Robyn Jones College of Nursing
101	Boise State University School of Nursing
102	Orvis School of Nursing at University of Nevada, Reno
103	Kaiser Permanente Scholars Academy
104	Unitek College
105	UC Davis Health
106	University of Washington School of Nursing
107	Arizona State University Edson College of Nursing and Health Innovation
108	University of Utah College of Nursing
109	American Nurses Credentialing Center
110	Doruk Silver
111	Second to None Wellness
112	University of Portland School of Nursing & Health Innovations
113	City of Hope ELNEC
114	Risepoint
115	SentinelU
116	University of New Mexico College of Nursing
117	University of Arizona College of Nursing
118	University of California, San Francisco School of Nursing
119	Samuel Merritt University College of Nursing
120	NEXus, The Nursing Education Xchange
121	University of San Francisco School of Nursing and Health Professions

Posters

WIN peer-reviewed posters have been grouped by keyword/topic. Research and Information Exchange (R&IE) posters have been grouped by member institution. There is one hour during each of the four poster sessions in which the primary scheduled activity is viewing posters. Presenters should stand by their posters during these hours.

Special Appreciation

We extend our gratitude to our Board of Governors, Program Committee, abstract reviewers, moderators, and to all WIN committee members. A list of committee members appears in the back section of the conference proceedings.



MONTANA
STATE UNIVERSITY

MARK & ROBYN JONES
College of
NURSING *1*30*

- Experts and leaders in rural health research
- Recently developed Indigenous Rural Health PhD program
- Established the Caring for Our Own Program in 1999 - the largest supplier of baccalaureate and advanced practice native nurses in the state

1,200 nursing students across nine programs:

- Bachelor of Science in Nursing (BSN)
- Accelerated Bachelor of Science in Nursing (ABSN)
- Master of Nursing (MN)
- Post Masters Doctor of Nursing Practice (DNP)
- Doctor of Nursing Practice Family Nurse Practitioner (DNP)
- Doctor of Nursing Practice Psychiatric Mental Health Nurse Practitioner (DNP)
- Doctor of Nursing Practice Nurse-Midwifery (DNP)
- Post-graduate APRN Certificate - PMHNP
- Certificate in Nursing Education

GLOBAL OPPORTUNITIES!



FOR UNDERGRADUATE
AND GRADUATE STUDENTS

5 New state-of-the-art learning facilities opening in 2026



Billings



Bozeman



Great Falls



Missoula



Kalispell

Montana State University

- Bozeman, MT
- Largest University in Montana
- 17,000+ Students
- Carnegie R1 Research Institution



Rural Health
Research Leaders



EXPLORE THE POSSIBILITIES OF AI IN NURSING



DISCOVER HOW THE TOOLS OF THE FUTURE CAN BE THE TOOLS OF TODAY

Face it: few AI tools in healthcare are created with nurses in mind. Thanks to a team of Boise State researchers, that's changing. Their work explores the possibilities of AI and how nurses can ethically incorporate it into their education and practice.

“We need nurses to engage,” said Dr. Jason Blomquist, a member of the research team. “None of us are going to be computer scientists, but we should have some basic knowledge about AI so that we can know how to contribute to the conversation.”

Boise State students are prepared to thrive in the evolving landscape of nursing. They study healthcare technology & informatics, design thinking and innovation so they can be a part of the discussion and development of healthcare technology.

**JOIN THE CONVERSATION AND
ENGAGE THE FUTURE OF NURSING**



BOISE STATE UNIVERSITY

SCHOOL OF NURSING DEGREE PROGRAMS

Online RN-BS Completion
AGNP
FNP
Post-Master's DNP
Vulnerable Populations
Certificate



University of Nevada, Reno

Orvis School of Nursing

www.unr.edu/nursing

Advancing Health, Transforming Lives

Ranked #5 in the Nation

Best Online Master's in Nursing Program

BSN | RN-BSN | MSN | DNP



We are hiring!
Nurse Scientist
Apply now.

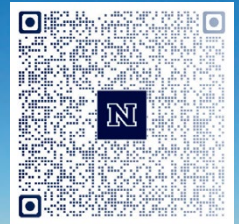

Proud Sponsor of the 2026 WIN Conference



The countdown is on!

We can't wait to connect with nursing leaders and educators.

Stop by our booth #104 at the
2026 WIN Conference

Explore faculty opportunities,
connect with our team, and discover
how you can make an impact in the
next generation of nursing leaders.





2026 WIN AWARDS AND HONORS

DISTINGUISHED RESEARCH LECTURESHIP



Sandra Weiss,
PhD, DNSc, RN, FAAN

Professor and Robert C. and Delphine Wentland Eschbach Chair in Mental Health, UCSF School of Nursing

CAROL A. LINDEMAN AWARD FOR A NEW RESEARCHER



Roque Anthony F. Velasco,
PhD, APRN, AGPCNP-BC

Director of Gender Health and Wellness Services, University of Colorado College of Nursing

MARTHA J. LENTZ DISSERTATION GRANT



Devon Cobos Garcia,
MS, BSN, RN

PhD Candidate, University of Arizona College of Nursing

MARTHA J. LENTZ DISSERTATION GRANT



Hyunhae Lee,
MSN, BSN

PhD Candidate, University of Washington School of Nursing

SIGMA / WIN RESEARCH GRANT



Stephanie St. Clair,
RN, BSN

PhD and Women's Health Nurse Practitioner Student, University of Utah College of Nursing

ANN M. VODA AMERICAN INDIAN/ALASKA NATIVE/FIRST NATION CONFERENCE AWARD



Cynthia Taylor Greywolf,
PhD, DNP, PMHNP-BC, APRN

Assistant Professor, University of Hawaii at Manoa School of Nursing and Dental Hygiene

ANNA M. SHANNON MENTORSHIP AWARD



Ruth Taylor-Piliae,
PhD, RN, FAHA, FAAN

Professor, University of Arizona College of Nursing

WIN EMERITI



Joan Shaver,
PhD, RN, FAAN

Professor and Dean Emerita, University of Arizona College of Nursing

WESTERN ACADEMY OF NURSES



Mary Nies,
PhD, RN, FAAN, FFAHB

Professor, Idaho State University School of Nursing

WESTERN ACADEMY OF NURSES



Shu-Yi Wang,
PhD, RN, APRN-CNS, CGNC

Teaching Professor, Co-Interim Specialty Director of CNS, University of Colorado College of Nursing

Not Pictured:

WIN / NLN RESEARCH GRANT, Ling Xu, RN, BSN, PhD Candidate, UCSF School of Nursing

OUR DONORS

We extend our deepest gratitude to our donors.



WIN has launched a 60x60 campaign to support the Endowment Fund, which supports the annual WIN awards and research grants.

Help us raise \$60K by the 60th anniversary of WIN's Communicating Nursing Research conference (April 2027).

DIAMOND DONORS (\$5,000+)

Ellen D'Errico - *In Memory of Ralph D'Errico Jr.**

PLATINUM DONORS (\$2,500 – \$4,999)

Marjorie Batey - *In Honor of Marty Lentz*

Judith A. Berg

Tina & John DeLapp

GOLD DONORS (\$1,000 – \$2,499)

Kathryn Lee - *In Memory of Marty Lentz*

Marie Lobo

Joan Shaver

Jim and Nancy Woods

Heather Young - *In Honor of Nancy Woods and Joan Shaver*

SILVER DONORS (\$500 – \$999)

Beverly Hoeffler - *In Honor of Dr. Carol Lindeman*

Ginny Pepper

BRONZE DONORS (\$100 TO \$499)

Terry Badger

Anne Boerner*

Lauren Clark

Tina DeLapp - *In Honor of Cherie Rector*

Joanne Noone

Bo Perry

Kathleen Thimsen

Hilaire Thompson - *In Honor of Dr. Marjorie (Marge) Batey*

Sandra Weiss

Kyla Woodward

COPPER DONORS (UP TO \$99)

Cheryl Armstrong - *In Honor of Janice Stewart*

Christina Baker - *In Honor of LaRayne Oakes Anderson*

Cathy Childers - *In Honor of Cherie Rector*

Susan Fraser - *In Honor of Cherie Rector*

Kathleen Gilchrist - *In Honor of Professor Emeritus, Dr. Cherie Rector*

Margaret Heitkemper

Mary Hunter

Kimberly Rosenbaum - *In Honor of Dylan and Caitlin*

Diane Vines

Charlie Winters - *In Honor of Maureen O'Malley*

*Donation to NEXus - The Nursing Education Xchange

Save time and money

Join schools of nursing from
across the country

NEXUS

THE NURSING EDUCATION XCHANGE

Visit our Booth
at WIN for
20th Anniversary
Discount



Arizona State University
Oregon Health and Science University
The University of Oklahoma
University of Colorado Denver
University of Kansas
University of Northern Colorado
Virginia Commonwealth University

Loma Linda University
The University of Iowa
The University of Texas at Tyler
University of Hawaii at Manoa
University of New Mexico
University of Utah
Washington State University

www.winnexus.org/info

A trailblazer in nursing and AI-integrated health care education

ASU
Edson College
of Nursing and
Health Innovation
Arizona State
University

#1
in the U.S. for
innovation
BEST COLLEGES
U.S. News
MOST INNOVATIVE
2025
ASU ahead of MIT and Stanford
— U.S. News & World Report,
10 years, 2016–25

Learn more



nursingandhealth.asu.edu

BUILDING SYSTEMS OF CARE AROUND THE WHOLE PERSON

Andrea Wallace, PhD, RN, FAAN, and her colleagues at the University of Utah College of Nursing are bridging health systems and communities to improve outcomes for every patient. Explore the work of our nurse researchers at nursing.utah.edu.

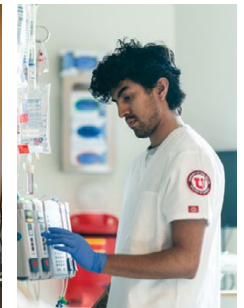
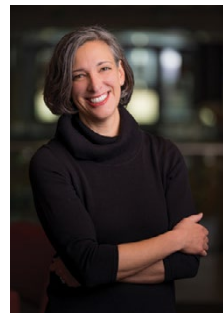

U COLLEGE OF
NURSING
UNIVERSITY OF UTAH



2026 WIN CONFERENCE

NAVIGATING THE CURRENTS IN HEALTHCARE AND ACADEMIA: BRIDGING RESEARCH, PRACTICE, AND EDUCATION

TUESDAY, APRIL 21

11 AM - 8 PM

Conference Registration Open

Location: Yosemite

12 - 3 PM

Preconference: Preparing the Next Generation: Teaching Serious Illness and Palliative Care Competencies

Pre-registration required

Location: Franciscan CD

Facilitators: Andra Davis, PhD, MN, RN; University of Portland; Megan Pfitzinger Lippe, PhD, MSN, RN, CNE, ANEF, FPCN, FAAN; UT Health San Antonio; Rhoberta Haley, PhD, RN; Pacific Lutheran University

Preparing the nursing workforce to provide high-quality care for individuals with serious illness requires the purposeful integration of palliative care competencies across the curriculum. This interactive workshop will introduce nursing faculty to practical tools and strategies for incorporating serious illness and palliative care content into classroom, clinical, and simulation learning environments. Led by ELNEC education champions who are advancing innovative models of palliative care education, the session will guide participants in aligning palliative care competencies with the AACN Essentials, applying competency-based teaching and evaluation methods, and engaging students through experiential learning activities. Faculty will leave with concrete strategies, ready-to-use resources, and a curated toolkit to strengthen their teaching and leadership in preparing the next generation of nurses to competently and compassionately care for individuals and families facing serious illness.

3:30 - 6:30 PM

Preconference: AI Essentials for Nursing: Practical Strategies for Education & Research

Pre-registration required

Location: Franciscan CD

Facilitators: Sarah Llewellyn, PhD, RN; Boise State University, Anthony Tolentino, PhD, RN, NI-BC, FAMIA; University of California, Los Angeles; Jason Blomquist, MAOL, BSN, RN, NEA-BC, CHSE; Boise State University

This foundational session is designed for nursing researchers and educators who are new to artificial intelligence or are seeking to better understand AI's increasing role in healthcare and nursing education. Participants will gain essential knowledge about AI fundamentals, explore the current landscape of AI applications in nursing and healthcare settings, and engage in discussions about the critical importance of integrating AI literacy and fluency into nursing curricula to prepare future nurses for technology-enhanced practice environments. The session will also provide hands-on guidance for getting started with AI tools, offering practical strategies for initial exploration and interaction that participants can immediately apply in their own research and educational contexts. By the end of this session, attendees will have both the conceptual framework and practical foundation needed to confidently begin incorporating AI considerations into their work as nursing educators and researchers.

7 - 8:30 PM

Welcome Reception

Location: Yosemite

All conference participants are invited to this informal reception. Light hors d'oeuvres / cash bar.

WEDNESDAY, APRIL 22

7 AM - 5 PM

Conference Registration Open

Location: Yosemite

7 - 8 AM

Welcome Breakfast (Non-Student)

Presented by Unitek College

Location: Yosemite

All conference participants are invited to this informal continental breakfast.

Welcome Breakfast for Student Attendees

Presented by the Mark & Robyn Jones College of Nursing at Montana State University

Location: Imperial Ballroom AB

Open to all student participants.

8:10 - 8:40 AM

Opening Session

Presiding: Lauren Clark, PhD, RN, FAAN, President, Western Institute of Nursing

Location: Grand Ballroom B

8:40 - 9:40 AM

Keynote Address: A Tale of Two Cities — Nursing at the Crossroads of Generations

Speaker: Jennifer S. Mensik Kennedy, PhD, MBA, RN, NEA-BC, FAAN, President, American Nurses Association

10 - 11 AM

CONCURRENT SESSION 1

Adolescent Health and Illness

Moderator: Alexa Curtis, PhD, MPH, APRN, FAANP, FAAN, Associate Dean for Research & Innovation, University of Nevada, Reno

Location: Franciscan B

Adolescents' Perspectives of Life after Metabolic Bariatric Surgery

Annette Nasr

Patterns of Adversity and NSSI Addiction Among Psychiatric Adolescents

Zengyu Chen, Juan He, Jianjun Ou, Yamin Li

Bullying Victimization Experiences of Adolescents in a Psychiatric Unit

Leilanie Ayala

Project Revive: A Mixed Methods Youth Participatory Action Research Project

Dawn Bounds, Sarah Rodrigues, Afsaneh Saghafi, Jayla Aldridge, Maruko Myint

Adult Health and Illness

Moderator: Nancy Pike, PhD, CPNP-AC/PC, FAHA, FAAN, Professor and Associate Dean for Research, University of California, Irvine

Location: Franciscan A

Nurse Perceptions of Inpatient Use of Wearable Insulin Pumps and CGMS

Ruth Robb, Kim Franson, Perry Gee

SDOH Biomarkers, and Cognitive Trajectories after a Subarachnoid Hemorrhage

Lalipat Phianhasin, Hilaire Thompson, Donald Fogelberg, Michael Levitt, Eeeseung Byun

Effects of Walking Exercise on QoL and Metabolic Syndrome in Korean Women with Menopause

Nah-Mee Shin, Jihyun Kim, JiWon Choi

Immigrant / Refugee Health

Moderator: Sigrid Barrett, PhD, RN, PNP, CNE, FAAN, Dean and Professor, University of Nevada, Las Vegas

Location: Franciscan C

A Framework for Addressing Underuse of Interpreter Services in Emergency Departments

Keri L. Baker

Cultural Adaptation of a Reproductive Health Curriculum for Refugees: A Pilot Project

Marcy Hanson, Molly Secor

Mental Health Predictors Among Filipino Americans

Razel Milo, Nicole Martinez, Patricia Calero, Maria Luisa Ramira, Cynthia D. Connelly

Symposium: Methods to Advance Precision Health: Invaluable Additions to the Research Repertoire

Moderator: Sandra J. Weiss, PhD, DNSc, RN, FAAN, Professor and Robert C. and Delphine Wentland Eschbach Chair in Mental Health, University of California, San Francisco

Location: Franciscan D

Overview: Methods to Advance Precision Health: Invaluable Additions to the Research Repertoire

Sandra J. Weiss

Latent Class and Profile Analyses: Identifying More Precise Clinical Phenotypes

Sandra J. Weiss

Epigenetic Clocks as Tools for Precision Health

Shaimaa Elrefaay, Sandra J. Weiss

A Systems-Level Approach to Advancing Precision Health: Multi-Omics Methods

Kayla Longoria

Organizational and Workforce Issues

Moderator: Maria Yefimova, PhD, RN, Lead Nurse Scientist, UCSF Health

Location: Imperial Ballroom A

Moral Resilience and Ethics Consultation Participation Among ICU Nurses

Sarah Sumner

Nurse Managers' Perspectives on Intent to Leave and Substance Use Risk

Yitong Wang, Karen Foli, Zachary Hass, Nicole Adams, Seungyoon Lee

Workplace Incivility: A Multipronged Mitigation Plan for New RNs

Mary Field, Juliette Ofamen, Sarah Lewicki-Hendrix, Bonnie Fryzlewicz

Creating and Validating the REPORT Scale to Foster Nursing Safety Reporting

Scott S. Christensen, Robert P. Lubeznik-Warner, Mykel Winter

Best Practices in Evidence-Based Teaching

Moderator: Shu-Yi Wang, PhD, RN, APRN-CNS, CGNC, Professor, University of Colorado

Location: Imperial Ballroom B

Enhancing Engagement through Team-Based Testing in Undergraduate Nursing Education

Marife Aczon-Armstrong

Enhancing Empathy and Communication through Nonviolent Communication Training

Julia Kaimana Tsuzaki, Donna-Marie Palakiko

Connecting Classroom and Practice: A Competency-Based Online Approach

Angela Fenton, Sydnie LaValley, Tiffany Noss, Lisa Broome, Mari Kimoto, Rebekah Perkins

Incivility Perceptions Among Students and Faculty in Pre-Licensure Nursing Programs

Mindy B. Zeitzer, Mihee Chung, Kiki Fornero, Cheryl Langford, Julie Fitzwater, Kathy Kuskie

11:15 AM - 12:15 PM

CONCURRENT SESSION 2

Topics in Oncology

Moderator: Rachel H. Adler, PhD, APRN, PMHNP-BC, AGNP-C, Professor, University of Arizona

Location: Franciscan A

Multifactorial Model of Cancer-Related Accelerated Aging

Lisa Morse, Sandra J. Weiss, Christine Ritchie, Melisa Wong, Thomas Hoffmann, Margaret Wallhagen, Christine Miaskowski

Cancer Survivorship in Under-Represented Minority Populations

Ebere Ume, Ragi George, Diana Lynn Woods

Care in the Context of Public Health

Moderator: Randi Arias-Fontenot, PhD, Assistant Professor, University of Nevada, Reno

Location: Imperial B

Kind Room: Blending Children’s Art and AI Methods in Pediatric Space Design

Julie Alexander-Ruff, Elizabeth A. Johnson

Going Viral: An Analysis of How Memes Are Infecting Vaccination Discourse

Michael Todd Coriasco

Mothers’ Perspectives on Discussing Adverse Childhood Experiences during a Home Visit

Julianne Ballard, Carol Dawson-Rose, Jacqueline Carrillo

Faith-Based Perinatal Support: A Community-Engaged Qualitative Study

Ryoko Kausler, Cindi Bennett, Chinma E. Njoku, Emma J. Stover

Symposium: From Evidence to Action: How Can Nurses Use Implementation Science to Address Complex Environmental Health Problems?

Moderator: Lisa M. Thompson, PhD, MS, RN, FNP, FAAN, Professor, University of California, San Francisco

Location: Franciscan B

Overview of Implementation Science for Intervention Development

Lisa M. Thompson

Ecolectivos Trial: Developing an Intervention to Address Air Pollution in Guatemala

Lisa M. Thompson

Knowledge into Action: Co-Creating Knowledge on Environmental Determinants of Health

Daniel J. Smith

Adapting a COM-B Survey: Insights from Cognitive Interviews

Elizabeth Mizelle

Strengthening the Healthcare Workforce: Education, Equity, and Leadership

Moderator: Marianne Biangone, PhD, RN, FAAN, Professor and Associate Dean, Education Programs, University of California, San Francisco

Location: Franciscan C

Bridging the Academic–Practice Gap: A Delphi Study on Essential Skills

Fara Bowler, Susan Hebert, Beth Hallmark

Racism and Discrimination Contributing to Attrition of the Midwifery Workforce

E. Brie Thumm, Elizabeth Phillips, Emily L. Gamm, Karie Stewart, Amy Goh

Sustaining Nursing Leadership Development: Rwanda’s HRH Program

Nanyombi Lubimbi, Jillian Pintye, Sarah Abboud, Natasha Crooks, Rohan Jeremiah, Madeleine Mukeshimana, Leah Neubauer, Cynthia Fritschi

Chronic Illness: Supporting Patients and Caregivers

Moderator: Catherine E. Elmore, PhD, MSN, RN, CNL, Research Assistant Professor, University of Utah

Location: Franciscan D

Fragmented Healthcare Among Older Asian Americans Living with HIV

Wei-Ti Chen

Understanding Care Transition Needs of Black and African Americans with Heart Failure

Shaterra Davis

Digital Supports for Families Transitioning to Long-Term Care

Zih-Ling Wang, Yanjing Liang, Oleg Zaslavsky

Persons with ALS and Caregivers Living at Home: A Grounded Theory of Service Sufficiency

Bronwyn E. Fields, Jessica Famula, Orly Tonkikh, Everlyne Ogugu, Bjorn Oskarsson, Janice F. Bell, Heather M. Young

Technology in Nursing Education

Moderator: Lisa A. Jaurigue, PhD, RN, CNE, Clinical Assistant Professor, Arizona State University

Location: Imperial A

Course-Sharing: Cutting Costs, Boosting Faculty, and Enhancing Learning

Alice M. Tse, Anne Boerner

Walking in Patients' Shoes: Virtual Reality and Social Determinants of Health

Julie Peila Gee, Katherine Doyon, Harshitha Naidu, Christine Buena, Ann L. Butt, Roger Altizer, Nancy Allen

Practices and Pitfalls of Using Artificial Intelligence in Research

Hannah J. Kim, Mary Anne Schultz, Evangeline Fangonil-Gagalang, Sarah Flores, Fang-yu Chou

12:30 - 1:30 PM

Awards Lunch – Reservation required

Location: Yosemite B

1 PM

Silent Auction Opens

Location: Yosemite

1 - 5 PM

Exhibits and Poster Session 1

Location: Grand Ballroom A

1:45 - 2:45 PM

State of the Science Address in Research: The State of Nursing Science in a Culture of Chaos and Anti-Intellectualism

Presented by Orvis School of Nursing, University of Nevada, Reno

Speaker: Holli A. DeVon, PhD, RN, FAAN, FAHA, Emerita Professor and Emerita Audrienne H. Moseley Endowed Chair in Community Research, UCLA School of Nursing

Moderator: Andrea Wallace, PhD, RN, FAAN, WIN Governor Representative of Nursing Research

Location: Grand Ballroom B

2:45 - 3:45 PM

Poster Viewing with Authors – Exhibits – Networking

Location: Grand Ballroom A

2:50 - 3:35 PM

National Institutes of Health (NIH) and National Institute of Nursing Research (NINR) Updates

This session will provide an overview of NIH's and NINR's mission and research priorities. Information on policy changes, and funding opportunities will be described, followed by Q&A.

Session will repeat Thursday morning.

Moderators: Julia Seay, PhD, Program Director and Joshua Wolff, PhD, Program Officer, Division of Extramural Science Programs, National Institute of Nursing Research, National Institutes of Health

Location: Imperial Ballroom A

UNIVERSITY of WASHINGTON | SCHOOL OF NURSING

**LEADING THE FUTURE
OF NURSING *today.***

The University of Washington School of Nursing is redesigning education, research and practice to push nursing into new frontiers. From harnessing technology in patient care to advancing health equity and community-based solutions, we prepare nurses to lead in rapidly evolving healthcare landscape.



JOIN US IN OUR MISSION
NURSING.UW.EDU/HR



3:45 - 5:15 PM

CONCURRENT SESSION 3

Addressing Clinical and Policy Implications

Moderator: Marife Aczon-Armstrong, PhD, MSN, MSCP, RN-BC, FAAN, Associate Professor, Chaminade University of Honolulu

Location: Imperial B

Responding to Violent Patients: Race, Gender, and Age as Factors

Darcy Copeland

Dedicated Defibrillator Nurse Improves in-Hospital Cardiac Arrest Outcomes

Ellen M. Anderson, Nicole Staring

State Policy Gaps in AI and Nursing: A Mapped Review of Regulation

Elizabeth A. Johnson

Scoping Review on Professional Wellbeing in the Nursing Research Literature

Ari Meyers

Caregiver Availability Buffers Impact of Geographic Disadvantage on Health Outcomes

Sumin Park, Andrea Wallace, Alycia A. Bristol, Jia-Wen Guo, Kelvin G. Opore, Catherine E. Elmore, Paula M. Meek

From Perception to Action: Fall Prevention Behavior and Balance Confidence

Andrew Daniels, Jimei Zhang, Keenan Pituch, Hanne Dolan

Symposium: Leveraging Nurses' Expertise for Meaningful Workforce Research and Policy

Moderator: Kyla F. Woodward, PhD, RN, Assistant Professor, University of Washington

Location: Franciscan A

Overview: Leveraging Nurses' Expertise for Meaningful Workforce Research and Policy

Kyla F. Woodward

The Impact of Non-Nursing Tasks on Nurse Work Outcomes

Kyla F. Woodward, Paula M. Kett, Natalia Oster

School Nursing Workforce Models and Implications on Healthcare Access and Policy

Mayumi Willgerodt, Benjamin Michael White

Methodological Approaches to Enumerating the Public Health Nursing Workforce

Paula M. Kett, Betty Bekemeier, Greg Whitman

Public Health Nurses' Unique Contributions to Health Equity

Betty Bekemeier, Paula M. Kett, Selina A. Mohammed, Shahida F. Shahrir, Grace Guenther

Nurses at the Intersection of Public Health and Primary Care

Janelle Zamora Martelino

Perinatal and Infant Health

Moderator: Lauri Linder, PhD, APRN, CPON, FAAN, FAPHON, Professor and Clinical Nurse Specialist, University of Utah

Location: Franciscan B

Postnatal Adaptation Model: Developing a Conceptual Framework for Neonatal Care

Nancy Brashear, Ellen D'Errico

Black Mothers' Journeys to Advocacy in Navigating Health Systems

Cherisse Erika Watts, Lauren Clark, Felesia Bowen, Kristen Choi, MarySue V. Heilemann

Freestanding Birth Center to Hospital Transfers of Care in Arizona

Erin George, Laurie S. Wood, Elise N. Erickson

Nocturnal Sleep in Breastfeeding and Formula Feeding Mothers, Infants, and Dyads

Kathryn A. Lee, Caryl L. Gay

Maternal Stress and Infant Regulation Associations with Infant Telomere Length

Harry Adynski, Sandra J. Weiss

Trusting Telehealth in Colorado's Nurse-Family Partnership: A Secondary Analysis

Elizabeth Phillips, Sophia Centi, Amy J. Barton

Promoting Health and Wellbeing Among Older Adults

Moderator: Omotayo O. Omotowa, PhD, MPA, MA, MSN, RN, Assistant Professor, Idaho State University

Location: Franciscan C

Independent and Synergistic Effects of Social Isolation and Loneliness on Well-Being

Jinseon Hwang, Wenting Peng

DST-Camm Model: Meaning-Making through Digital Storytelling for Dementia Caregivers

Raheleh Bahrami, Raena Nolan, Julie Fleury, Sunny Wonsun Kim

Functional Fitness for Mental Health in Older Women: A Systematic Review

Tracy Hellem, Brittney Howell

Stigma and Primary Care Access Among Trans Older Adults in the Inland Empire, California

Roque Anthony F. Velasco, Kimberly June Skeete, Anne Blakeley, Mita Beach, Ethan Cicero, Christina J. Sun, Scott Harpin, Ashley R. Turner, Kate Coleman-Minahan

Feeding the Brain: Linking Gut-Brain Axis Theory to Nursing Research

Kristina Wechsler, Ross Andel, Judith Klein-Seetharaman, Johannah Uriri-Glover

Drawing Insight: Sequential Art Narratives in Hermeneutic Nursing Research

Julie Grant, Jacqueline Jones, Kathy Oman, Sean M. Reed

Topics in Rural Health

Moderator: Siri Gurunam Kaur Khalsa, PhD, MSN, RN, Assistant Professor of Nursing, New Mexico Highlands University

Location: Franciscan D

Nurse-Led Telehealth Diabetes Coaching: Advancing Equity in Rural Black Communities

Arshpreet Kaur

Developing a Rural Ready Nurse Practitioner Program in Rural Montana

Stacy Stellflug, Alicia Crane, Shea McGuiness

Expanding Nurse Educator Capacity through the Retain Initiative: Results from Year One

Deb Bakerjian, Amy A. Nichols, Ana Marin Cachu, Jonathan Kwan, Kristen Bettega

Inhalers & Obstacles: A Qualitative Inquiry into School Nurse Asthma Management

Jodie Bondurant, Julia Reedy, Amy Huebschmann, Lisa Cicutto, Stanley J. Szeffler, Sarah E. Brewer

Travel Impacts for Oncology Patients Living in the Rural Mountain West

Margaret Hammersla, Rebecca Hoover, Hazel Afroilan, Janette Merrill

Transforming Rural Nursing Practice: Advancing Quality through Mindful Collaboration

Kristin Grimes

Excellence in Clinical Education

Moderator: Leslie S. Barnum, MSN, RN, CNE, Clinical Assistant Professor, Arizona State University

Location: Imperial A

Feedback That Sticks: Nursing Students Reflect on What Helps Them Learn

Jodi A. Erickson, SarahAnn Marie McFadden, Hannah Pye, Kristina D. Kenning

Compassionate Communication in Healthcare Students' Substance Use Encounters

Fatemeh Hashemi, Ira Kantrowitz-Gordon

Self-Efficacy and Professional Identity Growth in Nursing Student Peer Coaches

LeAnn Dykstra, M. Margaret Calacci, Kim Day

Diving Deep to Achieve Competency-Based Outcomes in Undergraduate Clinical Teaching

Cynthia Johnson, Jennifer Rigby, Kristen Erekson

Simulation to Build Nurse Practitioner Confidence in Human Trafficking Care

Grace Ellison, Hannya Ornelas, Molly Prengaman, Tracee Chapman

Future Nurse Researcher in the Making: Mentorship of Undergraduate Students

Lina Najib Kwar, Veronica Timple, Stacey A. Warner

5:30 - 6:15 PM

SPECIAL INTEREST GROUP MEETINGS (GROUP 1)

Integrative Health Connection at WIN

Moderator: Mary S. Koithan, PhD, RN, CNS-BC, FAAN, University of Washington

Location: Franciscan B

Integrative Health (IH) is a whole person/whole system approach to health care that uses a full spectrum of strategies to improve health and wellbeing. In an integrative health approach to care, providers choose across a variety of evidence-informed choices that includes complementary/alternative modalities (CAM) as well as more traditional biomedical interventions. With the goal of choosing the best approach to care, IH is the ultimate interprofessional approach to care, drawing from a variety of practitioners, modalities and systems of medicine. WIN members with interest in research and education that has an IH focus are invited to creatively discuss how to support an integrative health presence at future research conferences through posters, presentations and symposiums.

PhD/DNP Collaboration and Clinical Networking Special Interest Group

Moderator: Trisha Saul, PhD, RN, Director of Research, Providence Health & Services

Location: Franciscan C

The purpose of this interest group is to foster networking and collaboration among members with PhD and DNP degrees. Interest group members will have the opportunity to collaborate on abstract submissions, develop and implement projects, and provide collegial support to one another.

Trauma Informed Pedagogy in Healthcare Education

Moderator: Doria K. Thiele, PhD, CNM, RN, Associate Professor, California State University, Sacramento

Location: Franciscan D

Members of the Trauma Informed Pedagogy in Healthcare Education Special Interest Group seek to generate new knowledge regarding trauma informed teaching practices through research, and to infuse trauma informed best practices into our teaching. Our members teach across healthcare disciplines and programs, with the common interest of creating trauma informed learning environments.

WIN Gero-SIG

Moderator: Corinna Trujillo Tanner, PhD, RN, Assistant Professor, Brigham Young University

Location: Imperial Ballroom A

This interest group is building a cadre of gerontological nurses to advance the mission of WIN in the context of improving care for the older adult. Student and non-student abstract awards will be presented for excellence in gerontological research, theory development/conceptual, or methodological papers.

WIN-E (Environmental Health Special Interest Group)

Moderator: Tara Marko, PhD, RN, Assistant Professor, California State University, San Marcos

Location: Imperial Ballroom B

This is a forum for environmental health researchers, educators, and advocates, and anyone interested in the relationships between the natural environment and health, and between nursing practice and the environment. This is a chance to learn of the interests of others and explore opportunities for collaboration.

Associate Deans for Education and Directors of Academic Programs/Affairs

Moderator: Joanne Noone, PhD, RN, CNE, ANEF, FAAN, WIN Governor Representative of Nursing Education

Location: Franciscan A

This special forum is for associate deans and directors of academic programs/affairs. The focus is on issues relevant to academic program quality, curriculum development, accreditation, and student performance.

Associate Deans and Directors for DEI

Moderator: Jung-Ah Lee, PhD, RN, FAAN, Professor, Sue & Bill Gross School of Nursing, University of California, Irvine

Location: Green Room

All Associate Deans and Directors for DEI are invited to attend this special forum.

6:30 - 8 PM

School of Nursing Receptions

University of California Consortium Reception

Location: Vista Lounge

University of Utah College of Nursing Reception

Location: Yosemite A

University of Portland School of Nursing and Health Innovations Reception

Location: Yosemite B

Arizona State University Edson College of Nursing and Health Innovation Reception

Location: Yosemite C

University of Nevada, Las Vegas School of Nursing & University of Nevada, Reno Orvis School of Nursing Reception

Location: Cityscape

University of San Diego Hahn School of Nursing and Health Science Beyster Institute for Nursing Research Reception

Location: Cityscape

University of Washington School of Nursing Reception

Location: Plaza Ballroom

THURSDAY, APRIL 23

7 AM - 5 PM

Conference Registration Open

Location: Yosemite

7 - 8 AM

Continental Breakfast (Non-Student)

Location: Yosemite

Continental Breakfast for Students

Presented by the Boise State University School of Nursing

Location: Imperial Ballroom AB

Program Committee Breakfast – by invitation only

Location: Franciscan B

8 AM - 12 PM

Exhibit and Poster Session 2

Location: Grand Ballroom A

8 AM - 5 PM

Silent Auction Open

Location: Yosemite

8:15 - 9:15 AM

2026 Distinguished Research Lectureship: The Salience of Crosstalk among Biological, Psychological and Social Domains of Health to Knowledge Development in Nursing Science

Presented by Orvis School of Nursing, University of Nevada, Reno

Speaker: Sandra J. Weiss, PhD, DNSc, RN, FAAN, Professor and Robert C. and Delphine Wentland Eschbach Chair in Mental Health, UCSF School of Nursing

Moderator: Andrea Wallace, PhD, RN, FAAN, WIN Governor Representative of Nursing Research

Location: Grand Ballroom B

9:15 - 10:15 AM

Poster Viewing with Authors – Exhibits – Networking

Location: Grand Ballroom A

9:20 - 10:05 AM

National Institutes of Health (NIH) and National Institute of Nursing Research (NINR) Updates

This session will provide an overview of NIH's and NINR's mission and research priorities. Information on policy changes, and funding opportunities will be described, followed by Q&A. Repeat of session on Wednesday afternoon.

Moderators: Julia Seay, PhD, Program Director and Joshua Wolff, PhD, Program Officer, Division of Extramural Science Programs, National Institute of Nursing Research, National Institutes of Health

Location: Imperial Ballroom A

10:15 AM - 11:30 AM

CONCURRENT SESSION 4

Symposium: Foundational Work of Embedding Caring Science for New Graduate Nurses

Moderator: Hannah J. Kim, PhD, RN, CNL, PHN, Nurse Scientist and Senior Director, Healthcare Data Analytics, Kaiser Permanente

Location: Franciscan B

Overview: Foundational Work of Embedding Caring Science for New Graduate Nurses

Linda Ackerman

Caritas Process and Caring Science in Northern California

Erica D. Anderson

Impact of Healing Circles on Quality of Life, Social Connectedness, and Self-Care

Hannah J. Kim

Healing Circles in Nurse Residency Programs: A Qualitative Exploration

Anjal Y. Pong

Transformational Impact of Healing Circles and Caritas Processes

Katherine Ricossa

Symposium: From Fields to Frontlines: Nursing Related Responses to Latino Farmworker Health Risks

Moderator: Alma A. Manzo, Graduate Research Assistant, Arizona State University

Location: Franciscan A

Overview: From Fields to Frontlines: Nursing Related Responses to Latino Farmworker Health Risks

Alma A. Manzo, Fiorella L. Carlos Chavez, Nuria M. Tobar, Kylie Hescoock

Exploring the Hydration Practices of Latino Farmworkers during the Summer in Arizona

Fiorella L. Carlos Chavez, Alma A. Manzo, Nuria M. Tobar, Adrian Laborin, Amber Wutich, Alexandra Brewis

Health Policies & Protections for Latino Farmworkers Experiencing Extreme Heat

Alma A. Manzo, Fiorella L. Carlos Chavez, Nuria M. Tobar, Adrian Laborin, Alexandra Brewis, Amber Wutich

The Double Burden of Caregiving and Agricultural Labor Among Latina Farmworkers

Nuria M. Tobar, Fiorella L. Carlos Chavez, Alma Manzo, Adrian Laborin, Alexandra Brewis, Amber Wutich

Between Worlds: Unpacking the Intersections of Migration, Socialization, and Health

Kylie Hescoock, Fiorella L. Carlos Chavez

Innovative Interventions Across Populations

Moderator: Kathleen Thimsen, DNP, MSN, WOCN/CETN, FNS, DF-AFN, AFN-BC, Associate Professor and DNP Program Director, University of Nevada, Las Vegas

Location: Imperial Ballroom B

Gender Differences in Diabetes Distress within a Digital Intervention

Chunyu Wang, Minal R. Patel, Dante Anthony Tolentino

Diverse Caregiver Emotions after Mindfulness Breathing Intervention

Jung-Ah Lee, Hyun Jung Kim, Julie Rousseau, Eunae Ju, Seon Young Kim, Vicky Ngo, Stephanie Samame, Hannah Jung, Jiyoung Amy An, Eunbee A. Kim, Yessica Garcia Castaneda, Celeste Penney, Adey Nyamathi

Impact of Pre-Injury Adversity on Recovery after Dual-Task Exercise in mTBI

Hyunhwa 'Henna' Lee

Developing SAFE: A Nurse-Led, Community Approach to Financial Toxicity

Djin Tay, Megan Rose, Sumin Park, Mackenzie Mitchell, Carrie Bellerive, Junko Fowles, Mary Steinbach, Angie Fausett, Erin Bradshaw, Kathleen Gallagher, Jennifer Stephens, Patricia Brooks, Carilee Ellis, Duane Pannell, Selena Pannell, Erika Patronas, Joseph Patronas, Rachel Scott, Kathi Mooney

The Transcreation Framework to Develop an Intervention for Perinatal Substance Use

E. Brie Thumm, Britt Westmoreland, Elizabeth Phillips, Sarah Lopez, Liza Creel, Jessica Anderson

Maternal Health and Illness

Moderator: Gwen Latendresse, PhD, CNM, FACNM, FAAN, Professor, University of Utah

Location: Imperial Ballroom A

Concept Analysis: Impact of Climate Change on Pregnant Women with Sickle Cell Disease

Rachelle Chanmany Pastor, Lisa R. Roberts

Classifying Maternal Healthcare across the Continuum Using AI and Rules

Jennifer Vanderlaan

Maternal Biopsychosocial Adaptation in the Great Obstetrical Syndromes: A Framework

Stefanie L. Boyles, Ruth E. Taylor-Piliae, Elise N. Erickson

Sleep Disturbances and Hypertensive Disorders of Pregnancy: An Integrative Review

Jingying Yang, Becca Gates, Yuqing Guo

Investigating Associations of Placental Biomarkers with Term Birth

Erin K. George, Elise N. Erickson, Stephanie Lapsley, Lily Woods, Mary Dawn Koenig, Julienne Rutherford

Symposium: Navigating Work and Health: Nursing Perspectives on Occupation as a Social Determinant

Moderator: Elizabeth Kohout, MSN, RN, PhD Candidate, University of California, Los Angeles

Location: Franciscan C

Overview: Navigating Work and Health: Nursing Perspectives on Occupation as a Social Determinant

Elizabeth Kohout, Sungwon Park, Sandra Domeracki, Suyoung Kwon, Soo-Jeong Lee

Occupational Trajectories and Mental Health Among Filipino Immigrants

Suyoung Kwon, Natalie Rejto, AB de Castro

Knee and Lower Extremity Pain Among Construction Workers: A Scoping Review

Sandra Domeracki

Occupation, Health Behaviors, and Metabolic Syndrome Among Middle-Aged Women Workers

Sungwon Park, Victoria Zhang, Michelle Hood, Aleda Leis, Carrie Karvonen-Gutierrez, Sung Kyun Park

Disinfectant Exposure and Gut Microbiome of Cleaning Staff during COVID-19 Pandemic

Soo-Jeong Lee, Cherry Leung, Lu Yang, Abdur Rahim Khan, Kellie Redmond, Ryan Seguin, Libin Xu

Symposium: Symptom Self-Management Framework for Individuals with Complex Health Conditions

Moderator: Linda L. Chlan, PhD, RN, ATSF, FAAN, Associate Dean for Nursing Research, Mayo Clinic

Location: Franciscan D

Overview: Symptom Self-Management Framework for Individuals with Complex Health Conditions

Linda L. Chlan

Sleep Self-Management Preferences of Solid Organ Transplant Recipients

Stacy A. Al-Saleh, Samantha Conley, Linda L. Chlan

Application of Symptom Self-Management Framework to Alleviate Cancer Related Fatigue

Komal Singh

Untangling Symptoms from Functioning in Inflammatory Bowel Disease

Samantha Conley, Stacy A. Al-Saleh

ICU Patients' Appraisal of Sedation Self-Management for Anxiety

Linda L. Chlan

11:30 AM - 1 PM

Lunch On Your Own

1 - 5 PM

Exhibits and Poster Session 3

Location: Grand Ballroom A

1 - 2:15 PM

CONCURRENT SESSION 5

Symposium: Currents of Crisis and Creativity: Adapting Care in Nursing Homes

Moderator: Caroline Stephens, PhD, RN, GNP-BC, FGSA, FAAN, Professor, University of Utah

Location: Franciscan A

Overview: Currents of Crisis and Creativity: Adapting Care in Nursing Homes

Caroline Stephens, Rebekah Perkins, Amy Powell-Versteeg, Pamela Barrientos, Rachael Alexander, Laura Block

Crisis within a Crisis—Sustaining Connection in Dementia Care during COVID

Rebekah Perkins, Amy Powell-Versteeg, Pamela Barrientos, Rachael Alexander, Laura Block, Caroline Stephens

Leading from the Heart: Perspectives on Nursing Home Leadership in Crisis

Amy Powell-Versteeg, Rebekah Perkins, Pamela Barrientos, Rachael Alexander, Laura Block, Caroline Stephens

Telehealth in Nursing Homes: Experiences and Strategies for Integration

Rachael Alexander, Rebekah Perkins, Amy Powell-Versteeg, Pamela Barrientos, Laura Block, Caroline Stephens

Creative Solutions and Silver Linings Developed during the COVID-19 Crisis

Laura Block, Amy Powell-Versteeg, Pamela Barrientos, Rachael Alexander, Rebekah Perkins, Caroline Stephens

Building Capacity for Clinical Research and EBP

Moderator: Carol Dawson-Rose, PhD, RN, FAAN, Dean and Professor of Nursing, University of California, San Francisco

Location: Imperial Ballroom B

Strategies to Build and Sustain Excellence in a Hospital Based Nursing Research Program

Debra Ridling, Elaine Walsh

A Cross-Sectional Study of EBP Competencies of Nurses and Leaders at a Magnet Hospital

Lynette Low, Monica Sanchez, Lisa Arnold, Rick Martin, Ahlam A. Jadalla

Building Research Capacity through a Nurse Scientist Collaborative

Sarina A. Fazio, Maria Yefimova, Lori S. Kennedy, Kimberly A. Lewis, Heather Abraham, Michael Bueno, Lisa Wilhelm, Sandra Staveski, Heather Leutwyler, Christine Miaskowski

Research Capacity Assessment and Planning: Outcomes and Lessons Learned

Marjory D. Williams, Caitlin McVey, Bryan Sisk

Clinical Inquiry Capacity Building Initiative in an Academic Health System

Maria Yefimova, Elisa Jang, Renae Waneka, Adam Cooper

Bridging Research & Practice: The Clinical Nursing Research Fellowship

Karen Hessler, Maureen Varty, Martha Grubaugh

Leadership, Advocacy, and Innovation in Advancing Health Equity Panel Presentation

Presented by WIN's Committee on Diversity, Equity, and Inclusion

Moderators: Marife Aczon-Armstrong, PhD, RN-BC, FAAN, Chaminade University of Honolulu; Patrick Luna, MSN, RN, CEN, University of Colorado Anschutz Medical Campus; Razel Milo, PhD, DNP, FNP-C, AAOPM-BC, University of San Diego

Panelists: Dr. Marlon Saria, President & Dr. Bob Gahol, President-Elect, Philippine Nurses Association of America (PNAA); Dr. Brian Ahn, President, Asian American Pacific Islander Nurse Association (AAPINA); Ms. Kim Scott, Past President Bay Area, National Black Nurses Association (NBNA); Dr. Veronica Vital, President, National Association of Hispanic Nurses (NAHN); Dr. Lina Najib Kawar, Middle East Nurses Association (MENA); Dr. Rosario Jaime-Lara, Co-President, WIN Latino/a/x SIG; Dr. John Bressan & Dr. Dawn Taylor, Co-Chairs, WIN LGBTQIA SIG; Dr. Ali Tayyeb, Chair, WIN Military/Veterans SIG; Dr. Juvel Velasco, Chair, WIN FANS SIG

This year's panel will explore the evolving role of diverse healthcare professionals and educators in driving equitable change and shaping the future of health and education.

Location: Imperial Ballroom A

Mental and Behavioral Health

Moderator: Anne Brown, PhD, RN, Assistant Professor, Montana State University

Location: Franciscan D

Posttraumatic Stress Disorder and Cardiovascular Disease in Women Veterans

Caroline Dancu, Jenny Cohen, Oi Saeng Hong, Linda Park, Beth Cohen

Psilocybin-Assisted Psychotherapy, PMHNPs' Legal Risks, and Patient Benefits

Zachary Paul Ulrich

Symbolic Amplification: Expanding Nursing Research through Jungian Theory

Krista Scorsone

Disclosure of Suicidal Ideation Predicts Help-Seeking Among Nurses

Zengyu Chen, Juan He, Yusheng Tian, Meng Ning, Yamin Li

Motivation and Barriers to Change for Those with Housing Instability and Substance Use

Lindsay Benes

Symposium: Microbiome Insights into Stress and Depressive Symptoms: Maternal, Infant, and Adolescent Populations

Moderator: Cherry Leung, PhD, RN, Associate Professor, University of California, San Francisco

Location: Franciscan B

Overview: Microbiome Insights into Stress and Depressive Symptoms

Cherry Leung

Prenatal Microbiota Predict Women's Depression from Pregnancy through the Postpartum

Sandra J. Weiss

Prenatal Hair Cortisol Concentration and Infant Microbiome Richness

Madeline Dunlay, Sandra J. Weiss

Prenatal PM Exposure, Gut Microbiome Changes, and Telomere Length: Mediation Analysis

Nina Ahlers, Cherry Leung, Sandra J. Weiss

Gut Microbiota Associations with Mild Depressive Symptoms in Adolescents

Cherry Leung, Sandra J. Weiss

Symposium: Operationalizing Critical Pedagogy through Trauma Informed Approaches

Moderator: Rana Najjar, PhD, RN, CPNP, Associate Professor, Oregon Health & Science University

Location: Franciscan C

Overview: Operationalizing Critical Pedagogy through Trauma Informed Approaches

Rana Najjar

Critical Lens and Trauma-Informed Approaches Syllabi Evaluation

Marjorie Attis-Josias

Analysis of Inclusive and Exclusive Content in Open Access Nursing Fundamentals Texts

Joanne Noone, Angie Docherty, Willow Buswell, Julianna Joshua, Kelsie Peterson, Marcos Sanchez

Co-Evaluation of North American Nursing Curricula Using an Equity Lens

Claire McKinley Yoder, Kala Mayer, Cheryl Pollard

Evaluating BSN Student Responses to Trauma Informed Flexible Teaching Practices

Doria K. Thiele, Karen Bean

2:15 - 3:15 PM

Poster Viewing with Authors – Exhibits – Networking

Location: Grand Ballroom A

3:15 - 4:15 PM

State of the Science Address in Practice: The Professional Governance Imperative: Translating Trust into Impact

Speaker: Marla J. Weston, PhD, RN, FAAN, Chief Executive Officer, Weston Consulting, LLC and Former Chief Executive Officer, American Nurses Association

Moderator: Annette Nasr, PhD, RN, MPA, NE-BC, FAAN, WIN Governor Representative of Nursing Practice

Location: Grand Ballroom B

4:30 - 5:30 PM

CONCURRENT SESSION 6

Factors Influencing Mental and Physical Wellbeing

Moderator: Annette Joan Thomas, PhD, RN, Associate Professor, Seattle University

Location: Franciscan D

Overdose and Cardiac Emergency Simulation for Nurse Led Mobile Clinic Learners

Holly Kirkland-Kyhn, Michael Helton, Ashlyn Prasad, Deb Bakerjian

Reducing Stigma in Opioid Use Disorder Care: An Evidence-Based Training Approach

John Bressan, Marianne Hultgren, Roxanne Garbez, Susan Orozco

Effects of Sleep Regularity on Sleep Quality, Depression, and Fatigue in Shift Workers

Jinyoung Kim, Kevin Dangler, Stephanie J. Nam

EHR Automation and an Online Patient Education Portal to Prevent Perinatal Depression

Gwen Latendresse, Sara Simonsen, Ryoko Kausler, Eli Iacob, Wen Tu, Lauren Gimbel, Marcela Smid, Justin D. Smith

Clinical Education and Professional Development

Moderator: September T. Nelson, PhD, RN, CNL, Associate Professor, University of Portland

Location: Franciscan B

Virtual Reality Training Improves New Graduate Nurses' Medication Administration

Crystal Ramos, Kimberly Mullen, Brenda Nguyen, Rick Martin, Ahlam A. Jadalla

Bridging Education and Practice: Preparing APN Students for Healthcare Shortage Areas

Angel Kuo, Elizabeth Gatewood, Carrie Evans, Mary Anne Israel, Janet Coffman, Jody Diala

Symposium: Evidence Demonstrating the Implementation of the Clinical Nurse Leader Care Delivery Model for Creating Positive Healthcare System Work Environments

Moderator: Miriam Bender, PhD, RN, FAAN, Professor, University of California, Irvine

Location: Franciscan C

Overview: Organizing Nursing Care to Create Positive Healthcare Work Environments

Miriam Bender, Ariadne Meyers, Marjory D. Williams

A Conceptual Synthesis to Address Nurse Burnout through Improved Work Environments

Ari Meyers

Administrator Perceptions of Influence of the CNL Care Model on Care Environments

Marjory D. Williams, Miriam Bender

Linking Implementation Strategies to Care Environment Outcomes in the CNL Care Model

Miriam Bender, Marjory D. Williams

Behavioral and Social Factors in Sexual Health and Violence

Moderator: Emma Aquino-Maneja, PhD, DNP, RN, MEd, CCRN, Clinical Consultant, Kaiser Permanente Southern California

Location: Franciscan A

Survivors' Voices: Lived Experiences of Sexual Violence in British Columbia

Ann Pederson, Jila Mirlashari, Kate Rossiter, Chandra Berkan Hozempa

Sexual Motivation as a Pathway from Self-Control to Condom Use Resistance in Young Men

Raheleh Bahrami, Kavya Juwadi, Sarah Sarandos, Weiqi Chen, Julia Hammett, Kelly Cue Davis

A Theoretical Approach to Sexual Assault of Women in Later Life

Alyssa Lark, Julie Valentine, Cathy Maxwell

A Scoping Review of Law Enforcement-Involved Domestic Violence

Patricia Zrelak, Craig Wetterer

Breakthroughs in Aging and Chronic Disease Management

Moderator: Patricia Barfield, PhD, PMHNP-BC, Campus Associate Dean & Assistant Professor, Oregon Health & Science University

Location: Imperial Ballroom A

Epidemiologic Association between Blue Zones Features with Longevity

Hyunhae Lee, Alexi Vasbinder, Michael J. LaMonte, Bernhard Haring, Karen C. Johnson, Candyce H. Kroenke, Warren Szewczyk, Chi-Shan Tsai, Khyobeni Mozhui, Lorena Garcia, Lauren Hale, Matthew S. Nudy, Chris A. Andrews, Kathyleen Hovey, Allison Webel, Oleg Zaslavsky, Dorothy Lane, JoAnn E. Manson, Kerryn W. Reding

Home-Based Brain Stimulation and Mindfulness for Knee Osteoarthritis Pain

Juyoung Park, Chiyoung Lee, Hongyu Miao, Lifeng Lin, Ilknur Telkes, Stephen Dahmer, Jason Hoang, Lindsey Park, Hyochol Ahn

Implementation of Enhance®Fitness: A Scoping Review Using the RE-AIM Framework

Wenting Peng, Sarah McKiddy, Michiyo Tomioka, Dina L. Maruca, Nancy M. Gell, Matthew Lee Smith, Caitlin Maloy, Basia Belza

Sounds in Pneumonia (SiP): AI-Driven Cough Analysis for Early Detection in Older Adults

Zih-Ling Wang, Nicholas Ryan Rasmussen, Charles Kwanin, Les Atlas, Oleg Zaslavsky

Promoting Student Confidence, Engagement, and Wellbeing

Moderator: Jodi A. Erickson, PhD, RN, CNL, CNE, Assistant Professor, University of Washington, Tacoma

Location: Imperial Ballroom B

Impact of SBIRT Training and Simulation on Confidence in Nursing Students

Manal Alatrash, Muder Alkrisat

Participation for the WIN

Michael Bueno, Lindsay Holt, Kimberly Hicks, Jessica Oliver

Understanding Global Stress and Depression in Nursing Students: A Systematic Review

Ling Xu, Michael Joshua G. Morales, Marianne Biangone, Thomas Hoffmann, Cherry Leung

Promoting Self-Care in Graduate Nursing Students through Mindfulness and Acupressure

Sarah Campbell, Angela Jun, Paola German, Yuqing Guo

5 PM

Silent Auction Ends

Location: Yosemite

5:45 - 6:30 PM

SPECIAL INTEREST GROUP MEETINGS (GROUP 2)

Conducting Research with Latino/a/x Individuals Special Interest Group

Moderator: Rosario Jaime-Lara, Assistant Professor, University of California, Los Angeles

Location: Imperial Ballroom A

Members discuss various aspects of Latino/a/x health and inequalities that exist and illustrate, through both theory and research, potential ways to improve health for Latinos across the lifespan. Our WIN Special Interest Group members are interdisciplinary scientists conducting research with Latino/a/x individuals, families, and communities.

(FANS) Filipino American Nurse Scholars Special Interest Group

Moderator: Juvel-lou Velasco, PhD, MSN, RN, APRN-ANP, AGACNP-BC, CCRN, CHFN, University of Arizona

Location: Green Room

To advance the understanding of the Filipino population as both providers and recipients of care through impactful research, education, advocacy, mentorship, and collaboration, with a focus on strengthening the presence and impact of Filipino American scholars in the Western Region.

LGBTQIA Special Interest Group

Moderator: John Bressan, DNP, RN, ACNP-BC, Assistant Clinical Professor, University of the Pacific

Location: Franciscan A

All nurses interested in raising awareness of the needs of LGBTQIA communities are invited to attend this meeting.

MENA (Middle East North African) Special Interest Group

Moderator: Rana Halabi Najjar, PhD, RN, CPNP, Associate Professor, Oregon Health & Science University

Location: Executive Boardroom

All nurses interested in MENA initiatives, including raising awareness of the needs of the MENA communities, are invited to join this meeting.

Military/Veterans Special Interest Group

Moderator: Consuelo (Coco) Grant, PhD, RN, Assistant Professor, University of Portland

Location: Franciscan C

The mission of the Military/Veterans Special Interest Group is to advance the quality of healthcare for Servicemembers, Veterans and their families through research, education, advocacy, and collaboration. Our aims are to foster recognition of Servicemembers, Veterans and their families as unique and underserved populations. We will achieve this by advocating prioritization, promotion, and inclusion of Servicemembers, Veterans and their families in nursing research, education, and practice.

Pediatric Special Interest Group

Moderator: Kristi K. Westphal, PhD, RN, CPNP-PC, Assistant Professor, University of California, Los Angeles

Location: Franciscan B

The mission of WIN's pediatric special interest group (SIG) is to foster connections and community that contribute to high quality health care for infants, children, adolescents, and their families through research, scholarly projects (evidence-based practice, quality improvement), education, advocacy, and mentorship.

Academic/Practice Partnerships in Research, EBP, QI

Moderator: Annette Nasr, PhD, RN, MPA, NE-BC, FAAN, WIN Governor Representative of Nursing Practice

Location: Imperial Ballroom B

This special forum is for research directors, clinical researchers, and nurse scientists from clinical agencies. The focus is on issues relevant to clinical practice as they relate to research and evidence-based practice, Magnet destination, and applying research in the practice setting.

Associate Deans and Directors for Research

Moderator: Andrea Wallace, PhD, RN, FAAN, WIN Governor Representative of Nursing Research

Location: Franciscan D

This special forum is specifically for research deans/directors at research-intensive schools of nursing. The agenda is focused on issues relevant to these types of programs and faculty.

FRIDAY, APRIL 24

6:45 – 7:30 AM

Tai Chi provided by WIN's Gero SIG

Location: Franciscan C

7-11 AM

Conference Registration Open

Location: Yosemite

7:30 - 8:30 AM

Continental Breakfast

Location: Yosemite

Western Academy of Nurses Business Meeting - by invitation only

Members of WAN are invited to this annual business meeting.

Location: Franciscan B

8 AM - 12 PM

Exhibit and Poster Session 4

Location: Grand Ballroom A

8:45 – 9:45 AM

State of the Science Address in Education: From Disruption to Design: Strengthening the Future of Nursing Education

Heather M. Young, PhD, RN, FAAN, Professor and Dean Emerita, Betty Irene Moore School of Nursing at UC Davis

Moderator: Joanne Noone, PhD, RN, CNE, ANEF, FAAN, WIN Governor Representative of Nursing Education

Location: Grand Ballroom B

9:45 – 10:45 AM

Poster Viewing with Authors – Exhibits – Networking

Location: Grand Ballroom A

10:45 AM - 12 PM

Closing Session/Raffle

Location: Grand Ballroom A

Navigating Challenges with a Beacon of Hope

Presented by the Western Academy of Nurses (WAN)

Moderator: Adrienne Martinez-Hollingsworth, PhD, RN, PHN, WAN, Director of Research & Evaluation, AltaMed Institute for Health Equity

This is an interactive, arts-based session designed to reconnect nurses with their foundational motivations for choosing the profession and re-illuminate their inner sources of strength during times of professional and personal

challenges. This session builds upon Jean Watson's Theory of Human Caring and emphasis on caritas, the deep moral commitment to human dignity, altruism, and interconnectedness. Through this lens, participants will explore the essence of caring as a unifying ethos that transcends practice settings, generations, politics, and cultures. Following an introduction, participants will be invited to engage in a hands-on, non-verbal reflective exercise: decorating a small wooden lighthouse ornament that symbolizes their personal "beacon of hope." Each lighthouse represents an internal motivator, core value, or guiding belief that sustains their commitment to nursing. Art supplies will be provided. Following the exercise, participants will share the meaning of their lighthouse within small table groups, fostering dialogue, mutual support, and peer recognition.

12 PM

Conference Adjourns

POSTER SESSION FLOOR PLAN

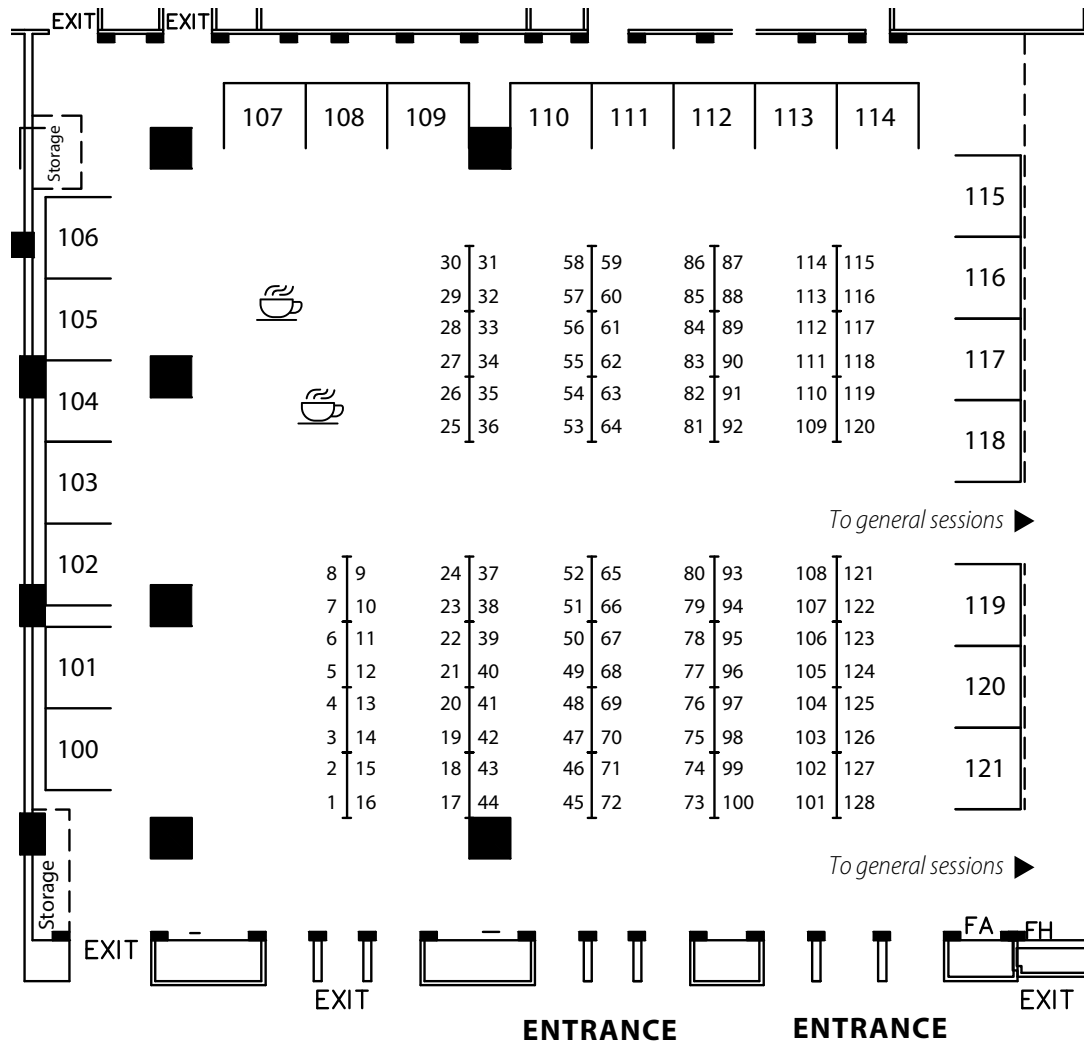

Booth # Exhibitor

- 100** Montana State University Mark and Robyn Jones College of Nursing
- 101** Boise State University School of Nursing
- 102** Orvis School of Nursing at University of Nevada, Reno
- 103** Kaiser Permanente Scholars Academy
- 104** Unitek College
- 105** UC Davis Health
- 106** University of Washington School of Nursing
- 107** Arizona State University Edson College of Nursing and Health Innovation
- 108** University of Utah College of Nursing
- 109** American Nurses Credentialing Center
- 110** Doruk Silver

Booth # Exhibitor

- 111** Second to None Wellness
- 112** University of Portland School of Nursing & Health Innovations
- 113** City of Hope ELNEC
- 114** Risepoint
- 115** SentinelU
- 116** University of New Mexico College of Nursing
- 117** University of Arizona College of Nursing
- 118** University of California, San Francisco School of Nursing
- 119** Samuel Merritt University College of Nursing
- 120** NEXus, The Nursing Education Xchange
- 121** University of San Francisco School of Nursing and Health Professions

POSTER SESSION 1 | WEDNESDAY, APRIL 22 | 1 - 5 PM

Poster presenters in Poster Session 1 should stand by their posters from 2:45 – 3:45 PM.

WIN PEER-REVIEWED POSTERS

MATERNAL HEALTH AND ILLNESS

- 1. Associations between Maternal Anemia and Placental Growth Factor across Pregnancy**
Stephanie Lapsley, Erin George, Lily Woods, Elise N. Erickson, Mary Dawn Koenig, Julienne Rutherford
- 2. Clinic Staff Perspectives on mHealth for Perinatal Depression**
Wen Tu, Uma P. Dorn, Ryoko Kausler, Sara Simonsen, Tumilara B. Aderibigbe, Gwen Latendresse
- 3. Co-Morbid Ripple Effect: Systems Approach to Postpartum PTSD and Depression**
Alissa Fox, Amy J. Barton
- 4. Digital Platform for Prevention and Management of Perinatal Hypertension**
Yuqing Guo, Laura Narvaez, Jiacheng Zhuo, Amanda Chang, Sergio Gago-Masague
- 5. Empowering Your Birth: Comfort and Control**
Cora Bori
- 6. How the Impact of Adversity Shapes Maternal Resilience**
Allysen Kelly, Aleeca F. Bell
- 7. Impacts of Culturally-Tailored Community-Based Prenatal Education Program (CCPEP)**
Kyoung Eun Lee, Carmen H. Linhares, Lina Monfort, Holly B. Fontenot
- 8. Prevalence and Disparities of Substance Use Disorder in Pregnancy in Colorado**
Sara Bidinost, Mustafa Ozkaynak, Vesile Kocak
- 9. Prevalence of Postpartum Contraception Among Younger Versus Older Women in Kenya**
Harison Lagat, Tessa Concepcion, Jerusha N. Mogaka, John Kinuthia, Lauren Gomez, Ben Odhiambo, Jillian Pintye
- 10. Promoting Cardiovascular Health in Postpartum Patients with Hypertension**
Esther Hong, Yuqing Guo, Leanne Burke, Margo Minissian
- 11. Telehealth Group Prevention for Perinatal Mental Health: A Pilot Study**
Ryoko Kausler, Amber Baranek, Gwen Latendresse
- 12. Perinatal Mental Wellness & Prevention Program Engagement in mHealth Portal**
Ryoko Kausler, Sara Simonsen, Eli Iacob, Wen Tu, Gwen Latendresse
- 13. Trajectory and Determinants of Fear of Childbirth Among Childbirth Women in Malawi**
Madalitso Khwepeya, Kaboni Whitney Gondwe, Shu-Yu Kuo
- 14. Understanding the Experience of Black African Immigrant Mothers**
Suheilah Abdalla, Adey Nyamathi, Jung-Ah Lee, Yuqing Guo
- 15. Unmet Perinatal Mental Health Needs of Pregnant Birthing Persons**
Courtney Sholar

NEWBORN/INFANT HEALTH AND ILLNESS

- 16. Exclusive Breastmilk Expression: Parental Needs and Clinical Best Practice**
Kimberly Rosenbaum, Lisa Anders, Barbara McAlister

17. **Lactation Network of Support in Idaho: A Statewide Needs Assessment**
Kristie Karroum, Caitlin Kerr
18. **Nurse Practitioner-Led Prenatal Care in Rural Oregon: A Program Evaluation**
Emily Hobbs, Yolanda L. Rodriguez, Ivy Seaburg, Candice Hunter
19. **Passing the Baton: Structured Handoff and Care Transfer from or to the Pediatric CVICU**
Grace Schroeder, Nancy Pike, Leigh Mohler, Shelly Burke
20. **RSV Provider Knowledge, Screening Confidence and Acceptance Rates in Primary Care**
Caitlin Eileen McNamara Powers, Yuqing Guo, Danielle Crook, Nancy Pike

CHILD HEALTH AND ILLNESS

21. **Big Data Answers the Question: Mapping Pediatric Infection Risk Patterns**
Kristin M. Stagg, Jan M. Nick, Safiye Sahin
22. **Development of an Evidence-Based Policy Handbook Utilizing a HUB and Spoke MODEL**
Leah M. Coffman
23. **Exploring Sleep, Clinical, and Demographic Factors in Pediatric CNO**
Hector Valdivia
24. **Innovation in Health Information Exchange: Engaging School Nurses**
Christina Baker
25. **Maternal Justice Involvement and Young Children's Mental Health**
Bailey Elizabeth Martin, Rhonda Douglas Brown, Randi Bates, Aaron Murnan, Samantha Boch
26. **Physical Stressors Increase Delirium after Pediatric Cardiac Surgery**
Lindsey Lee Scheller, Matee Ur Rehman, Thomas Hoffmann, Sandra Staveski
27. **Shifts in Hawaii Parents' Attitudes Toward Routine Childhood Vaccines Post-COVID-19**
Gary Glauber, Eunjung Lim, Holly B. Fontenot
28. **The Cumulative Influence of PAE and ACE on Maternal Circulating miRNA Expression**
Sharon L. Ruyak, Xiaozhong Yu, Shahani Noor, Erin Milligan

ADOLESCENT HEALTH AND ILLNESS

29. **Facilitators and Barriers to Implementing a Rheumatology Transition Clinic**
Clare Peckenpaugh, Echo L. Warner, Tressie Rollins, Sarah Wallgren, Suzy Richins, Katherine A. Sward, Aimee O. Hersh, Rebecca S. Overbury
30. **HPV Vaccine Access for Youth with Developmental Disabilities and PCCS**
Dorothy J. Wiley, Lauren Clark, Mary-Lynn Brecht, Umme Warda, Emily C. Bloom
31. **Integrating Mental Health Screening into Metabolic Care Clinic Workflows**
Ashely Andrews, Scott S. Christensen

ADULT HEALTH AND ILLNESS

32. **Comprehensive Checklist for Opioid Use Disorder Care in Primary Care**
Sophia Rose Madden
33. **Enhancing Hypertension Control through Home Blood Pressure Monitoring in Primary Care**
Kayla Ann Smietanka, Nisa Zacharias, Sarah Campbell
34. **Integrating Digital Cognitive Behavioral Therapy for Insomnia in Behavioral Health**
Edgar Rodriguez, Autumn Roque, Katie Lais

35. **Telehealth Preference, Delayed Care, and ED Visits Among Adults with Chronic Disease**
Jessica Rayo, Smita Mathews, Janice F. Bell, Victoria Keeton

OLDER ADULTS/GERONTOLOGY

36. **Breathwork and the Surgical Stress Response Among Older Adults: A Feasibility Study**
Devon E. Cobos Garcia, Thaddeus W. Pace, Ruth E. Taylor-Piliae
37. **Caring in the Background: A Scoping Review of Secondary ADRD Caregivers**
Raheleh Bahrami, Abigail Gómez-Morales
38. **Collaborative Protocol for Enhancing Geriatric Daily Oral Care in Skilled Nursing**
Jessie Corlito
39. **Enhancing Fall Prevention through Proactive Rounding in the Trauma Neuro ICU**
Nicole Osterholt, Michelle Hancock, Felicia Thongpet, Olivia Michie
40. **Evaluating Compensatory Inactivity in Older Caregivers During a 1-Week Coaching Trial**
Deatra R. Bear, Dawon Baik
41. **How Older Family Caregivers of Heart Failure Patients Engage in Physical Activity**
Chan mi Lee, Catherine Jankowski, Paul Cook, Larry Allen, Dawon Baik
42. **Program Evaluation: The Chronic Suicide Pathway in a Senior Psychiatric Unit**
Julia Victoria B. Salve
43. **Reframing Fall Prevention for Older Adults to Promoting Balance Management**
Jimei Zhang, Hanne Dolan
44. **Technology-Assisted Horticultural Therapy and Autonomic Regulation in Older Adults**
Qiu Feng Hu, Chia-Jung Hsieh, Chia Mei Tsai
45. **Using CALM to Improve Nurse Workforce Stability for Those with Dementia in Long Term Care**
Diana Woods, Linda R. Phillips, Mary Lynn Brecht

WOMEN'S HEALTH ACROSS THE LIFESPAN

46. **Health Perceptions, Aging and Reproductive Aging: Midlife Women**
Nancy Woods, Ellen Mitchell
47. **Joyful Experiences of Midlife Women**
Annette Joan Thomas, Nancy Woods
48. **Multimorbidity Patterns and Health-Related Quality of Life by Menopausal Status**
Yoongi Chung, Ji-Su Kim
49. **Novel Biomarkers of Inflammation in Survivors of Intimate Partner Violence**
Loretta Tsu
50. **The Cytologic-Histologic Correlation with Abnormal Pap Results in Guatemala**
Cheryl Armstrong, Jill Johnson, Kimberly Garcia

CLINICAL EDUCATION

51. **Evaluation of a Mentoring and Onboarding Program for Early-Career Nurse Faculty**
Cheryl Armstrong, Diane Chapman, Carolyn Scheese, Rebecca Wilson
52. **Accessible Futures: Breaking Barriers in Clinical Nursing Education**
Kayla Sullivan, Angela Silvestri-Elmore, Wendy Huynh, Matthew Nishimoto

53. **Advancing Clinical Judgment through a Nursing Priorities Framework**
Monica Godden
54. **Advancing Regional Preceptor Education to Strengthen Rural Nursing**
Cathlyn J. Mendijs, Sara Schmidt, Danika Lee Comey
55. **Enhancing Tardive Dyskinesia Screening: A Quality Improvement Initiative**
Ariel Davalos, Briony Marie DuBose, Autumn Roque
56. **Focused SUD Curriculum for DNP Students Leads to Improved Confidence in SUD Patient Care**
Michelle Anderson, Gina Clarkson
57. **Rooted in Rural, Ready for Anything: The Oregon Rural Nurse Scholars Program**
Patricia Barfield, Cynthia Taylor, Tamara Rose, Sherri Bailey, Robin Claudson, Nick Miehl
58. **The Feasibility of School Nursing as an Undergraduate Pediatric Clinical Experience**
Benjamin Michael White, Daniel D. Cline
59. **The Impact of Clinical Experiences on Nurses' Attitudes Toward Homelessness**
Sarah Brown Blake, Rich Burton

CROSS-CULTURAL & GLOBAL HEALTH

60. **Feasibility of Coach Mpilo to Support Men's HIV and TB Treatment Adherence**
Victoria Nakamoga, Lindsey de Vos, Mziwabantu Fosi, Zibele Mhaleni, Siyabonga Sibulawa, Kelly Rutt, Andrew Medina-Marino, Joseph Daniels
61. **From Discrimination to Depression: The Roles of Sleep and Mindfulness in Thai PLHIV**
Wei-Ti Chen
62. **Gender, TB and HIV-Related Stigma and Mental Health Outcomes in Botswana**
Emmanuel Sakyi, Annabel Wu, Davena Duru, Tamara Jimah, Nakia C. Best, Keneilwe Molebatsi, Chawangwa Modongo; Sanghyuk Shin
63. **Providers' Perspectives on Mental Health in West African Neonatal Intensive Care Wards**
Evelyn Bigini, Orlando O. Harris, Ifeyinwa Asiodu

HEALTH PROMOTION/ILLNESS PREVENTION

64. **Caregiving between the Lines: What Literature Misses and Lived Experience Reveals**
Kimberly Y. Ito, Malek Alnajjar, Mutiu Olawumi Fakorede, Sara Small, Megan C. Thomas Hebdon, Catherine E. Elmore
65. **Hospital-Acquired Pneumonia Prevention by Engaging Nurses (HAPPEN)**
Bonnie S. St John, Shaelyn L. Hogue, Janine S. Roberts
66. **Implementing Standardized Training for Blood Pressure Protocol in Clinic and at Home**
Alexis Hnatiak
67. **Improving Oral Health Care in the Underserved Population**
Susan Harris
68. **Spiral Comparison within a Mixed Methods-Grounded Theory Study**
Ashley R. Turner, Timothy Guetterman
69. **Who Should Pay Attention to Readiness for Aging?**
Yanjing Liang, Wenting Peng

RESEARCH AND INFORMATION EXCHANGE POSTERS (R&IE)

Azusa Pacific College of Nursing and Health Sciences

70. **BSN Student Participation in a Mindfulness-Based Practice for Spiritual Well-Being**
Melinda McLaughlin, Ruth Paul, Lawrence Santiago
71. **Caregiver Perspectives on Support Group Participation: A Thematic Analysis**
Jessica Kim, Ebere Ume, Ragi George
72. **Do Online Cases Affect Clinical Judgment Scores in Pre-licensure Nursing Students?**
Nancy Mukai, Mildred Gonzales, Mary Lynn Knighten
73. **Effects of Psychotherapy and Medication Management in Major Depressive Disorder**
Fines Pruett, Meaghan Ellis, Lisa Cowan
74. **Hospital Simulation Enhances Confidence of Obstetric Nurses in Postpartum Hemorrhage**
Andrea Smith, Christina Bivona-Tellez, Amanda Thurman
75. **Prompt List in Primary Care: Effect on Patient Collaboration and Satisfaction**
Maria Henin, Amanda Thurman, Kathleen Ruccione
76. **The Effect of Holistic Self-care on the Resilience of Sophomore Level Nursing Students**
Kristine Mandani, Amanda Thurman, Juli McGinnis
77. **Transforming Homelessness with Relationship Centered Care: Voices of Female Veterans**
Jennifer Tran, Diana Lynn Woods, Pamela Cone, Marie Fongwa

Intermountain Health

78. **Reassessing Ipsilateral Arm Restrictions: Safety of BP and IV use after Sentinel Lymph Node Biopsy**
Jessica Holm, Josie McDonald
79. **Saving Clicks, Saving Time: How Automation Transformed Program Efficiency**
Cami Perry
80. **Transforming Care into Scholarship: Empowering Nurses to Publish**
Cecile Evans, Janine Roberts, Jeffrey Boone

Linfield University School of Nursing

81. **Identifying Nursing Student Perspectives: Trialing the Campus Accessibility Measure**
Julie Fitzwater, Sari Platt, Paul Smith
82. **Updating Policy with an Equity Lens: Technical Standards for Schools of Nursing**
Julie Fitzwater, Sari Platt, Paul Smith

Oregon Health & Science University School of Nursing

83. **AI-Assisted Diagnostic Judgment in Acute Care: A Concept Analysis**
Steven Cole
84. **Bridging Gaps in Transgender Nursing Care with Undergraduate Simulation**
Han Jasper
85. **Consistency of Subjective vs Objective Sleep Regularity Measurement**
Yasmine Robles, Brooke Shafer, Andrew McHill
86. **Determinants of Emergency Clinicians' Use of Advance Care Planning: A Scoping Review**
Ki Rog Lee, Shigeko Izumi

87. **Exploring Family Language and Psychosocial Risk During Child's Open-Heart Surgery**
Aunnah Anderson, Kristin Cloyes, Meganne Leach, Kelly Mansfield, Sarah Wawrzynski
88. **Frailty Among Informal Caregivers: Prevalence, Determinants, and Health Consequences**
Zijiao Wang
89. **Healthcare Access in Rural Houseless Populations**
Natalia Hernandez, Elli Smith, Daniela Torres
90. **Improving Childhood Vaccination Through Evidence-Based Vaccine Communication**
Gabi Rasmussen
91. **Sex-Specific Relationships Between General Pain and the Circadian Timing of Sleep**
Sophia Kogan, Brooke Shafer, Steven Shea, Ryan Olson, Andrew McHill
92. **Sleep Timing in Relation to Circadian Phase and Turnover in Early-Morning Shift Workers**
Kathryn McAuliffe, Brooke Shafer, Andrew McHill

Providence Health and Services

93. **BEE HEARD: Buzzing for Better Patient Experience Through Structured Nurse Communication Using AIDET**
Juan Guerrero, Sohl Chapman, Jerome Codilla, Nkiru Chukwudi
94. **Creating Culture Change Around Stroke: Integrating Process Improvement to Reduce Door-to-Needle Time**
Shayna Brewer, Benedict Pereira, Rose Bisellach, Jason Greenspan
95. **Guiding Growth: A Mentorship Initiative for Unit-Based Councils**
Annika Daphne Bilog
96. **Impact of Co-Caring Model on Caregivers' Perceptions of Stress, Burnout, and the Caregiver Experience**
Rosemary Timmerman, Cara Gallegos
97. **Impacting Nurse Leader Satisfaction and Retention Through Standardized Support and Education**
Rebecca Hawkins
98. **Improving Door to EKG Time in the Emergency Department**
Juleene McGowan
99. **Integrating Licensed Vocational Nurses (LVNs) Back into the Acute Care Setting**
Mindy Luebs, Amanda Espinosa
100. **Professional Quality of Life Among Medical Surgical and Telemetry Registered Nurses**
William Lim, Emylee Ricafrente, Jenny Carrillo
101. **Resuscitating Rapid Response and Code Blue Education**
Danielle Fogel
102. **The Lived Experience of New Nurses in a Medical-Surgical/Telemetry Float Pool Residency**
Tanya Hartley, Martha Highfield
103. **The Lived Experiences of Registered Nurses in the ICU Utilizing a Novel Prophylactic Sacral Dressing**
Jason Miranda, Rofelina Madlambayan, Paolo Roca
104. **Utilizing Virtual RNs to Decrease Length of Stay on an Acute Care Unit**
Sarah Culbert, Lillian Embree

University of California, Irvine Sue & Bill Gross School of Nursing

105. **Effect of Intervention on Care Coordination between Primary Care and Behavioral Health**
Christopher Cleary

University of California, Los Angeles, Joe C. Wen School of Nursing

106. **Aging with Down Syndrome: Inclusive, Cross-cultural, AI-Supported Protocol**
Yuri Matsuo, Lauren Clark
107. **Cognitive Impairment Among People Living with HIV Experiencing Homelessness**
Yuka Imai, Wei-Ti Chen
108. **Enhancing Labor Management with Evidence Based Care**
Pratima Subedee, Wei-Ti Chen, Dana Beck
109. **Implementing Measurement-Based Care in an Outpatient Psychiatric Clinic**
Loren Neiswender, Lauren Clark, Stacey Green, Kristi Westphaln
110. **Empowering Adolescents with Stop the Bleed Training: A Rapid Review**
Ronald P. Braga, Lorena E. Smith, Kristi Westphaln
111. **Understanding Feeding Challenges in Autistic Children via the Socioecological Model:
A Qualitative Synthesis**
Sarah Moreau, Kristi Westphaln
112. **Nurse-Led Integration of Cardiac Myosin Inhibitors in Obstructive Hypertrophic Cardiomyopathy:
Evidence from Five Randomized Trials**
Hyerim Yun, Kristi Westphaln, Mary Rezk-Hanna
113. **Exploring Motivations and Barriers: A Study of Precepting Among Behavioral Health APRNS**
Stacey Green, Lynda Creighton-Wong, Vandy Loth, Elizabeth Rice
114. **Preliminary Impact of a Mini Mindfulness-based Modules (MMM) Intervention on Depression and Anxiety**
Denice Economou, Danielle Paisley, S. Lazaro, B. Demman, Eden Brauer
115. **Rurality and Resource-Limited Hospital Classification in the United States**
Charlotte Bryant
116. **Lung Cancer Risk Advocacy**
Elsa Cai, Sofia Hilario, Karley Morales, Cristal Moran, David Nam
117. **Mapping the Evidence on Stress, Burnout, and Loneliness Among Advanced Practice Providers:
A Scoping Review**
Paul Boy, Wendie Robbins, Paul Macey, Felicia Hodge

University of Nevada – Reno, Orvis School of Nursing

118. **Healthcare Post Suicide Attempt and the Native American: A Scoping Review of the Literature**
Randi Arias Fontenot
119. **Implementation of a Moral Resilience Training in Final Semester Pre-licensure Nursing Students**
Janelle Willis, Shannon Richard

University of Northern Colorado School of Nursing

120. **Protecting the Public: The Impact of Continued Competence Regulations on Nursing Disciplinary Rates**
Laura Blackhurst
121. **The Anchored Leadership Framework: A Confidence-Mediated System for Translating Evidence into Rescue**
Cris McAfee

University of Portland School of Nursing and Health Innovations

122. **Engaging Students Across Disciplines: Nursing Education and the Humanities**
Nicole Harvey, Daniel Greenberg, Alex Mirowski

Samuel Merritt University College of Nursing

123. **Moving Forward with Change: Improving an Established Nursing Exchange Program**
Laurie Rosa, Fusae Abbott, Zahra Asiabar, Michele Santilhano, Jessica Tellier

University of New Mexico College of Nursing

124. **Spatial Analysis of an Ongoing Multidrug-Resistant *Shigella flexneri* Outbreak in Bernalillo County, New Mexico**
Michael Baker
125. **Burnout Among Critical Care Providers**
My Ha
126. **Educating the Leadership Response to Workplace Aggression (WPA): Changing Culture Through Effective Leaders**
Lyric Nakashima
127. **The Laboratory Assessment of Secretory Activation in Women with Gestational Diabetes**
Sandra Cardenas

POSTER SESSION 2 | THURSDAY, APRIL 23 | 8 AM - 12 PM

Poster presenters in Poster Session 2 should stand by their posters from 9:15 – 10:15 AM.

WIN PEER-REVIEWED POSTERS

ACUTE AND CRITICAL ILLNESS

- Caregiver Presence As a Factor in Patient Readiness for Hospital Discharge**
Kelvin G. Opare, Paula M. Meek, Jia-Wen Guo, Alycia A. Bristol, Catherine E. Elmore, Andrea Wallace
- Chronotype and Cognitive Training Adherence in Older Adult ICU Survivors**
Jessica K. Japra, An-Doan N. Nguyen, Fiona M. Wang, Chi-shan Tsai, Maya N. Elias
- Combined Use of Mews and Qsofa in Rapid Sepsis Identification of Hospital-Onset-Sepsis**
Anthony Michael Velasquez-Bernardo
- Efficacy of Zinc Oxide with Petroleum Jelly for ICU Incontinence Dermatitis**
Shamsa Al Sharji
- Nurses' Perspectives on Caring for Critically Ill Children during a Measles Outbreak**
Cara Gallegos, Melissa Robinson, Brittany Ayola, Lacey Kovar, Nicole Roehrig
- Feasibility of Journaling for Parents of Critically Ill Children**
Cara Gallegos, Lauren E. Kemp
- Implementing a Noise Reduction Protocol in the Intensive Care Unit**
Soh Jeon, Robin Pueschel, Salem Dehom
- Optimizing TBI Care: Brain Oxygen Monitoring in Nursing**
Alyssa Grisham
- Physiologic Responses Associated with Alcohol Withdrawal Syndrome**
Dawn Troeger, Hildy Schell-Chaple, Heather Leutwyler, Shannon Smith-Bernardin, Michele Pelter
- Transdisciplinary Team Research – Bridging Research and Practice**
Grace Kistner, Fabio Badilini, David W. Mortara, Geoff Tison, Lamberto Isola, Priya Prasad, Michele M. Pelter

ADVANCED PRACTICE

- Bridging Education and Practice: Evaluating Pmhnp Readiness Via Simulation**
Cynthia Garbett, Lisa Ann Barry, Isaac Harmon, Dezmond Swain, Caylynn Mcevoy, Rebekah Perkins
- Engaging Near Peers to Bridge Competency and Professional Identity**
Lisa Ann Barry, Cynthia Garbett, Rebekah Perkins
- Innovating Advance Practice Nursing Education for Treating Substance Use Disorders**
Elizabeth Castillo, Matt Tierney, Emily Huang
- Integrating a Nurse Driven Preop Order Set & CHG Hygiene Protocol Guided By ERAS**
Saul Jorge Palomar-Corti
- Optimizing Care for Patients with Skin and Soft Tissue Infections in the ED**
Nicole Martinez, Razel Bacuetes Milo

CANCER

16. **Epigenetic Age Acceleration and Cardiovascular Event Risk in Cancer Survivors**
Warren J. Szewczyk, Claire Han, Vidhya Nair, Elizabeth M. Cespedes Feliciano, Alexandra Binder, Aladdin Shadyab, Karen C. Johnson, Philippe Gradidge, Yangbo Sun, Gretchen Wells, Su Yon Jung, Lisa Warsinger Martin, Mara Vitolins, Matthew S. Nudy, Phyllis Richey, JoAnn E. Manson, Kerry W. Reding, Alexi Vasbinder
17. **Ethics of Treating Cancer-Related Depression in Indigenous Cancer Survivors**
Rey Paolo Ernesto J. Roca III, Paul Boy, Christine Samuel-Nakamura, Felicia Hodge
18. **Increasing Colorectal Cancer Screenings in Direct Primary Care**
Annie McLean Bilauca, Jennifer Hanlon-Wilde, Jacqueline Baker
19. **Instruments to Measure Symptom Self-Management By Children with Cancer and Parents**
Lauri Linder, Jia-Wen Guo, Christine Platt, Kristin Stegenga
20. **Mixed-Method Study to Refine the ASHA Health Intervention for Women in India**
Adey Nyamathi
21. **Physical Function Changes from Pre- to Post-Transplant in Allo-HCT Patients**
Makena M. Kraft, Jazmine Gillett, Julia Palmer, Mohamed Sorrow, Alexi Vasbinder
22. **Qigong for Stress Reduction in Adult Cancer Survivors: A Systematic Review**
Yingying Chen, Fang Yu, Ruth E. Taylor-Piliae

CV DISEASE

23. **Increasing Repeat Blood Pressure Compliance Rates in a Primary Care Clinic**
Anne Maria Giampietro
24. **Prevalence of Volume Overload in Adults with Heart Failure and Dysphagia**
Juvel-lou Velasco
25. **Quality Improvement: Referral Algorithm for Team-Based Care of Blood Pressure Control**
Hai-Yen L. Tang, Mary Jo Russo, Jud L. Simonds, Mary Elisabeth Gibson, Taryn K. Johnson
26. **Reduce Inappropriate Cardiac Stress Tests By Adherence to Educational Guidelines**
Melinda Daley, Tarnia Newton, Patricia Daly, Rajesh Pradhan
27. **Social Factors Influencing Symptoms and Quality of Life in Atrial Fibrillation**
Elizabeth Frazier, Linda Yoo, Cynthia M Dougherty

COMMUNITY/PUBLIC HEALTH

28. **Baseline Findings of Unhoused Women with Multimorbidity: The Healthy Beginnings Study**
Benissa E. Salem, Nicholas Jackson, Angelique Rubio, Andrea Loera, Tori Prescott, Christina Abdishoo, Soomin Son, Adey Nyamathi, Barbara Riegel, Lillian Gelberg, Melissa Y. Wei, Dana Rose Garfin, Stephanie S. Covington, Evelyn Vega
29. **Behavioral Interventions to Increase Contraceptive Use Among Women Living with HIV**
Michael Deynu, Sarah Gutin, Ifeyinwa Asiodu, Jerry Nutor, Glenn-Milo Santos
30. **Empowering Reproductive Health Decision-Making Among Young Adults with Sickle Cell**
Lisa R. Roberts, Carlene O. Fider, Safiye Sahin
31. **Improving PrEP Access and Uptake for Cisgender Women at Planned Parenthood**
Britanie Lynn Speziale, Barbara Bennett-Wolcott

32. **Nurses in Emergency Preparedness in Marginalized Communities: A Conceptual Framework**
Renata Do Couto Pereira, Roberta P. Lavin
33. **Simulation Based Training for Sexual Assault Nurse Examiners**
Rachael Julian, Carrie Hintz
34. **Substance Use and HIV/HCV Prevention in Transitional-Age Youth**
Tinney Leong, Carol Dawson-Rose
35. **Weaponized Spirits: Alcohol, and Family Violence in a Native Hawaiian Community**
Cynthia Greywolf

DIABETES

36. **A Clinical Tool to Improve Monitoring of Chronic Kidney Disease in Diabetes**
Mckaylin Maie Shirey Wood
37. **Barriers & Nurse Attitudes on Inpatient Cgm/Insulin Pump Use Evaluation**
Hodan Omar, Jennifer Hanlon-Wilde, Devorah Overbay
38. **Blending Digital and Traditional Diabetes Education for Vietnamese Patients**
Uyen Duy Tran, Vanessa Rodriguez, Angela Jun
39. **Culturally Tailored Outpatient Case Management Program for Filipino Americans with DM**
Ralph Fontejon, Yeonsu Song, Emma Cuenca, Dante Anthony Tolentino
40. **Diabetes Fatalism, Self-Efficacy, and Self-Management Among Arab Americans**
Ani S. Harter
41. **Diabetes Prevention Efforts in Arizona: How Do Organizations Consider Social Needs?**
Aliria Rascón, Niko Verdecias-Pellum
42. **Diabetic Retinopathy Screening Rates in Primary Care Settings: A Program Evaluation**
Cosmos Buendasi, Jennifer Hanlon-Wilde
43. **Health Literacy, Social Factors & Diabetes: An Intersectional Approach**
Jisook Ko, Nicole Murry
44. **Improving Albuminuria Screening in Primary Care: A Quality Improvement Initiative**
Kristy Huffman, Michael Bueno
45. **Recruitment of Native Hawaiians in a Convergent MIXED Methods Diabetes Screening Study**
Anela LaBore, Ruth E. Taylor-Piliae

HEALTH EQUITY

46. **Creative Course Design for Care Work: Disability Justice and Health Care**
Lauren Clark, Yuriko Matsuo, Cherrisse Erika Watts
47. **Cultivating Change Agents: Building a Pipeline for Social Justice Advocacy in Nursing**
Mariel L. Nguyen, Emebet R. Aklilu, Coretta Jenerette
48. **Delphi Panel with Disability Experts on Supported Decision-Making Resources**
Kristen Choi, Lauren Clark, Emily Hotez, Kathryn Kietzman, Aryan Pandey, Linda Demer
49. **P-Hisb for Children with IDD**
Amanda R. Berumen, Robert J. Lucero

IMMIGRANT HEALTH

50. **Bridging Voices: CBPR with Refugee Communities and Healthcare Team**
Alice Mwamba, Adebisola Oluwatoba-Adeyemi, Hannya Ornelas, Sadia Abdulkadir, Sunny Smart, Katherine Doyon
51. **Factors Associated with COVID-19 Vaccine Hesitancy Among Refugees Women in Malawi**
Kaboni Whitney Gondwe, Mary O. Hearst, Hellen R. Mbutuka, Madalitso Kwepheya, Hanan Abusbaitan, Alinane Linda Nyondo-Mipando, Sarah J. Hoffman, Annie E. Dressel, Anwar Eyadat, Patience B. Jaman, Alexa A. Lopez, Lucy Mkandawire-Valhmu
52. **Heat, Rain, or Dehydration: Latino Farmworkers Keep Working**
Alma A. Manzo, Fiorella L. Carlos Chavez, Nuria M. Tobar, Adrian Laborin, Alexandra Brewis, Amber Wutich
53. **Multi-Sector Training in Migrant Health Justice for Nursing and Neuroscience**
Hafifa Siddiq Shabaik, Matthew Kilzi, Sanam Ahadi
54. **Social Determinants of Health Screening Tools Used with Immigrant Populations**
Madeline Metcalf, Sally Moyce
55. **Estimating Undiagnosed Diabetes in a Sample of Latino Immigrants**
Sally Moyce, Danika Lee Comey, Jeffrey Lee

VETERAN HEALTH

56. **Assessing Violence in Healthcare: Psychometric Review of Workplace Violence Measures**
Chad Mitchel Osteen, Lisa Burkhart, Elizabeth Huggins, Rebecca Brown, Jennifer J. Orshak, Qiyang Mu, Ginger Shroers, Amy Kiefer, Frances M. Weaver, Kathy Sliwinski, Eleanor S. McConnel, Marysol C. Cacciata
57. **Combined Stellate Ganglionic Block and Healing Touch on Veterans with PTSD: Pilot Study**
Marysol C. Cacciata, Alan Ooka, Melissa M. Brown, Amy Treadwell
58. **Non-Pharmacologic Sleep Interventions for Military Personnel: A Systematic Review**
Heather King, Allison Ferro, Tatiana Gonzalez, Kristen Shear, Shelby Mueller, Dana Brackup, Stuart Hitchcock, Christopher Morrell, Joshua Lennon, Lin Wu, Jesse Hilner Sr., Jane Persaud, Jeffery Metter, Laura Talbot
59. **Veterans, Families, & Neighborhood Safety: Gun Storage Practices in California**
Jennifer Jean Edwards, Smita Mathews, Emily Thatcher, Janice F. Bell, Victoria Keeton

INTERPROFESSIONAL EDUCATION/COLLABORATION

60. **Academic-Practice Partnership: Deepening Faith & Spirituality for Whole-Person Care**
Lisa S. Zenoni, Bianca B. Calderon, Linda C. Osterlund, Krishna Clopton, Michael Podolak, Julia Prinz
61. **Antibiotic Stewardship: Evaluating Nurses' Knowledge and Attitudes across New Mexico**
Maryam Hamidi, Michael Baker, Sarah Llanque-White
62. **Building a Culture of Partnership: Shared Governance in Academic Nursing**
Staci L. Shanks, Michelle DeCoux Hampton
63. **Enhancing Course Review: A Multi-Functional Approach for Health Education**
Shauna Mangum, Lisa A. Jaurigue, Christina Penn, Angel Algarin, Therese Speer, Katherine Kenny
64. **From Anchor to Ripple: A Confidence-Mediated Ecosystem in Nursing**
Cristina McAfee
65. **Improving Emergency Medical Services to Emergency Department Handoff**
Makena Brooke Ackerman, Mary Jo Russo

- 66. **Pediatric Transplant Admission Huddle: A Quality Improvement Project**
Kaylee Fauvell, Gabriel Chavez, Michele Schmidt, Karee Nicholson
- 67. **The Brilliancy of Creating an Authentic Connection**
Janet Sohal, Tara Rynders
- 68. **Validating the Icet: A Tool for Interprofessional Competency Assessment**
Stephanie Au, Candice Whealon

INTERVENTION

- 69. **Bridging the Gap: Implementation of a Standardized OB Transport Workflow**
Amanda Faye Wilford
- 70. **Implementing Signage to Identify & Prevent Workplace Violence in the Hospital Setting**
Katie Whitehead, Mary Wineinger, Rose Hernandez, Lisa Balesteri, Jamie Margain
- 71. **The Art of Resilience: A Mindful Approach to Nurse Wellness**
Kindra D. Brooks

RESEARCH AND INFORMATION EXCHANGE POSTERS (R&IE)

BOISE STATE UNIVERSITY SCHOOL OF NURSING

- 72. **Integrating Genomics into Nursing Education to Advance Preventative Care**
Cora Serafine, Makenna Moseley
- 73. **Medical Mistrust During Pregnancy and Post-Partum: A Scoping Review**
Julia Armstrong
- 74. **Patient Voices: A Qualitative Exploration to Enhance Simulation Based Learning in Nursing Education**
Isabel McGregor, Grace Ellison, Hannya Ornelas
- 75. **Pulse Oximetry Accuracy: Racial Disparities in Hypoxia Detection**
Alice Mwamba, Gabby Lane, Katie Martins
- 76. **Retention Crisis in Nursing: A Social Media Survey of Intent to Stay Among Hospital Nurses**
Edward Zepeda, Ava Templeton

HOAG MEMORIAL HOSPITAL

- 77. **Increasing the Rate of Adult Patient Discharges Before Noon Using an Electronic Health Record Tool**
Janell Griggs

KAISER PERMANENTE SCHOLARS ACADEMY

- 78. **Bullying among Nurses: Assessment and Implications for Retention**
Lina Kawar, Veronica Timple, Quincyann Tsai, Regina M. Valdez
- 79. **Operationalizing Caring Science Across a Multi-Hospital Nursing Workforce**
Rayne Soriano
- 80. **Predictive Models and Analytic Tools for Delirium in the Acute Hospital Setting:
A Review of the Evidence**
Quincyann Tsai, Lina Najib Kawar, Veronica Timple, Emma Aquino-Maneja, Joria Rainbolt-Clemente, Belen Thornfield, Becky Campbell, Hannah Jang Kim

81. **The Brilliancy of Creating an Authentic Connection**

Janet Sohal, Kathy Ricossa, Tara Rynders

MONTANA STATE UNIVERSITY, MARK AND ROBYN JONES COLLEGE OF NURSING

82. **Increasing the Rural SANE Workforce in Montana**

Sarah Wangerin, Julie Ruff, Sydney Hunsaker

SAN JOSÉ STATE UNIVERSITY, THE VALLEY FOUNDATION SCHOOL OF NURSING

83. **A Pilot Project on Improving ICU Nurses' Confidence in Early Defibrillation**

Adetutu Obadina, Wei-Chen Tung, Denise Dawkins

84. **Are Nursing Informaticists Ready for AI? Insights from a Needs Assessment**

Jerri Westphal, Ruth Rosenblum, Heather Zuhn

85. **Building a ROAD to Mitigate APOT**

William Manguil, Denise Dawkins, Christopher Britton, Rosie Cortez

86. **Caritas Literacy and Resilience Training (CLARITY) Program**

Pakeeza Ali, Robin Whitney, Jannette Moreno

87. **Educational Program for Nurse Managers: Leading Nurses Towards Clinical Ladder Progression**

Michelle Chlebinski, Lisa Walker-Vischer, Janet Moreno

88. **Headset to Reset: Virtual Reality Therapy in Postoperative Heart and Lung Transplant Patients**

Michaela Sanchez, Tamara McKinnon, Kendra Look, Carol Chen, Vishnu Nair

89. **Implementation of a Nurse-Driven Early Mobility Algorithm in Critically Ill Adults**

Andrea Saito, Elaine Ware

90. **Improving Graft-versus-Host Disease Documentation Through Provider Education and Audit Feedback**

Emily Shearon, Robin Whitney, Lisa Walker-Vischer

91. **Improving Hyaluronic Acid Filler Safety Through a Structured, Evidence-Based Training Program**

Carlos Sandoval Madrigal, Nicole Zhang

92. **Nurse-Led Post-Discharge Calls for Prevention of Readmissions in Type II Diabetes Mellitus**

Sierra Kane, Tamara McKinnon, Lisa Walker-Vischer

93. **Patient Reported Outcome Measures in Heart Transplant Care**

Nichole Cote, Ruth Rosenblum, Monica Nandwani

94. **Retrospective Evaluation of Frailty to Optimize Postoperative Spinal Fusion Outcomes in Older Adults**

Sheri Loo, Wei-Chen Tung, Anand Veeravagu

UNIVERSITY OF ALASKA, ANCHORAGE SCHOOL OF NURSING

95. **Assessing Readiness for Point of Care Ultrasound Implementation in a Neonatal Intensive Care Unit**

Stacy Brunquist

UNIVERSITY OF ARIZONA COLLEGE OF NURSING

96. **Categorizing Indigenous Community Collaborative Research: A Scoping Review**

Deidre Chase, Beth Meyerson, Ruth Taylor-Piliae

97. **Herding Orders: Developing A Practical Data Explorer for Inpatient T2DM**

Pankaj Vyas, Sheila M. Gephart, Artin Majdi

UNIVERSITY OF COLORADO ANSCHUTZ COLLEGE OF NURSING

98. **Adjustment to Illness & Technology Support for Patients with Heart Failure**
Shannon Nottingham, Rachel Johnson, Nora T. Kakati, Ruth Lewis, Jacqueline Jones
99. **Best Practices for Recruitment in Marginalized Adult Populations**
Loretta Tsu, Ashley R. Turner, Roque Anthony F. Velasco, Heather Coats, Teri Hernandez
100. **Can Loyalty Make Household 6 A Force Multiplier: A Nursing Framework**
Amy Crisp, Mona Pearl Treyball, Deborah J. Kenny, Lorraine M. Gdanetz, Catherine G. Ling
101. **Implementation of an Educational Aid to Enhance Novice Advanced Practice Provider Skills**
Hannah Lee, Laura Rosenthal
102. **Improving Syphilis Screening and Management in Pregnancy: A QI Project**
Leah Rashidyan, Scott Harpin
103. **In-Class PPE Activity Aligned with AACN Subcompetencies**
Brian Umbarger, Patrick Luna, Liana Hall
104. **Nursing Process for Veterans: A Theoretical Practice Model**
Rachel Tyler, Catherine Jankowski, Katherine Kissler
105. **Prognostic Concordance as a Foundation to Improve Advanced Care in Thoracic Oncology Patients**
Carey Ramirez, Kathy Shaw
106. **Program Evaluation of Tele-Medical Nutrition Therapy in Class II Obesity**
Joe Martinez, Kathy Shaw
107. **Smart Rooms to Improve Nurse Efficiency and Satisfaction in Acute Care Units**
Melissa Stalp

UNIVERSITY OF NEVADA, LAS VEGAS, SCHOOL OF NURSING

108. **Decreasing Door-to-ECG Times in Frontier NV: A Quality Improvement Project**
Breanna Schumacher, Kathleen Thimsen
109. **Developing Strategies and Tactics to Address the Resolution of Neonatal Hypothermia**
Sarah Musovski, Kathleen Thimsen, Janice Enriquez, Necole Leland, Nicole DeVille
110. **Dual Pathways of Uncertainty at End-of-Life: A Conceptual Model**
Kaitlyn Piantoni, Nirmala Lekhak, Andrew Reyes
111. **Empowering Educators: Transforming Online Classrooms Through Interactive Training**
Jodie Peterson, Kathleen Thimsen
112. **Evaluating an Educational Intervention on Screen-Time and Behavior Change**
Kayla Sweeney, Kathleen Thimsen, Jill Schwartz, Emily Boyce, Jay Shen
113. **Fall Prevention Education to Reduce Falls and Improve Knowledge QI Project**
Ashley Wood, Amy Haycraft, Kathleen Thimsen
114. **From Hand-Off to Hands-On: AI Chatbot Prebriefing in Nursing Simulation**
Nikki Rose Ty-Albright, Hyunhwa Lee
115. **Health Insurance and Provider Exercise Advice among Employed Adults with Arthritis: BRFSS Secondary Analysis**
Joseph Cadiz, Jinyoung Kim

116. **How Gen Z Nursing Students Learn During Clinical Rotations: A Grounded Theory Study**
Andrea Koplin, Andrew Reyes
117. **Impact of Dementia Care Training on Nursing Practice and Care Quality**
Dihini Perera, Brenda Delgado, Hyunhwa Lee
118. **Improving Nurses' Knowledge, Attitudes, and Skills in LGBTQ+ Inclusive Care**
Victoria Seidman, Rhigel (Jay) Tan
119. **Measuring Cultural Humility Among Nurse Educators: A Review of Instruments**
Sandy Phan, Reimund Serafica

UNIVERSITY OF SAN FRANCISCO SCHOOL OF NURSING AND HEALTH PROFESSIONS

120. **The USF CNA Training Program: A Pipeline for Minority Workforce**
Kelsey Green
121. **Leveraging the AACN Student Policy Summit to Support Policy Competency among Nursing Students**
Eileen Fry-Bowers, Carolina Echeverria
122. **The Nurse Health Equity Scholars Initiative (NHESI): Developing a Diverse Nursing Workforce Pipeline**
Eileen Fry-Bowers, Carolina Echeverria, Ann Lawani
123. **Retention of Nurses in the Hospital Sector: Nurse Self-Efficacy, Education, and Patient Satisfaction**
Sophia Aragoza, Madeline Novatt, Laura Sullivan
124. **Strengthening School Nurses' Capacity to Identify and Support Adolescents with Eating Disorders**
Michelle Concepcion
125. **Transforming Nursing Leadership Through Caring Science and Jesuit Pedagogy**
Sara Horton-Deutsche, Rayne Soriano, Priscilla Javed, Gwen McKinney
126. **Transitioning Expert Clinicians to Novice Prelicensure Part-Time Clinical Faculty**
Robert Patterson

SAMUEL MERRITT UNIVERSITY COLLEGE OF NURSING

127. **Artificial Intelligence Versus Traditional Methods in Designing Curriculum for Pre-Licensure Medical-Surgical Nursing**
Nadine Pruitt, Tammy Valenta, Zahra Naderi-Asiabar, Michele Santilhano, Annemarie Marchi

POSTER SESSION 3 | THURSDAY, APRIL 23 | 1 - 5 PM

Poster presenters in Poster Session 3 should stand by their posters from 2:15 – 3:15 PM.

WIN PEER-REVIEWED POSTERS

ALIGNMENT OF RESEARCH AS CAPACITY BUILDING STRATEGY IN A HEALTHCARE SYSTEM SETTING

1. **Alignment of Research as Capacity Building in a Health Care System Setting**
Marjory D. Williams, Tajudaullah Bhaloo, Jessica Peterson, Jody Collins, Caitlin McVey
2. **A System Wide Evaluation of Professional Governance**
Jessica Peterson, Marjory D. Williams, Jody Collins, Tajudaullah Bhaloo, Caitlin McVey
3. **A Conceptual Framework for Evaluating Virtual Nursing Models**
Tajudaullah Bhaloo, Patricia R. DeLucia, Heidi Gilroy, Caitlin McVey, Jessica Peterson, Marjory D. Williams
4. **Participatory Research Approach to Evaluating a Health Professions High School**
Marjory D. Williams, Tajudaullah Bhaloo, Caitlin McVey

ENVIRONMENTAL HEALTH

5. **ACEs and Health Impacts from Hazardous Weather Events Among Adults in California**
Alexis Ross, Kristen Choi
6. **Autoimmunity in a Warming World: Wildfires, Lupus, and the Social Ecological Model**
Elizabeth Kohout
7. **Environmental Hazards and Depressive Symptoms in Arizona**
Fiorella L. Carlos Chavez, Keenan A. Pituch, Priscilla Carmiol-Rodriguez, Alma A. Manzo, Nuria M. Tobar, Amal Juma AL-Hadabi, Adrian Laborin, Kylie Hescoock, Tammy F. Tang, Khushi Bypan, Tracy Tang, Maribel Cachu
8. **Lead Screening by Primary Care Providers: A Survey of Knowledge and Clinical Practice**
Max Veltman
9. **Perceived Needs, Barriers, & Practices Related to Infection Prevention on Dairy Farms**
Natalie Rejto, Vickie Ramirez, Peter Rabinowitz, Nancy J. Simcox, Dennise Drury, Pablo Palmández, Hannah Fenelon, Craig McConnel, Julianne Meisner
10. **Unequal Burden: Geographic and Demographic Trends of Valley Fever in San Joaquin County**
Lyndsay Wilson Anderson, Michael Hill
11. **Water Insecurity as an Existential Threat to Neonatal Health: An Isem Model**
Stephanie Lapsley, Julienne Rutherford
12. **Wildfire Risk Communication during Pregnancy: A Scoping Review Protocol**
Kristy I. Lanciotti, Julie Postma

EVIDENCE-BASED TEACHING

13. **An Education Program to Empower Evidence-Based Practice Mentors**
Isabel Soto Rivera
14. **Bridging Learner, School and Partner Needs in Developing BSN-DNP Scholarly Projects**
Annette Carley, KT Waxman

15. **Designing a Faculty Peer Development Process – A Quality Improvement Project**
Doria Thiele, Cristian Mendoza Ruvalcaba
16. **Developing Confidence and Improving Resilience for Future Nurses VIA Simulation**
Jeanette M. Wells
17. **Enhancing Nursing Specialty Certification through a Peer-Led Preparation Course**
Dana Ho, Stephanie Au
18. **Enhancing Women’s Health Education in DNP Programs**
Rachel C. Jensen
19. **Evaluating a Flipped Classroom Model: A Prelicensure Quality Improvement Project**
Tullamora T. Landis, Mariana Neeway
20. **Identifying, Quantifying, and Contextualizing Anti-Racism & DEI in Nursing Curricula**
Hongyu Yu, Emily Leaver, Joycelyn Thomas, Bethany Rolfe Witham, M. Rebecca O’Connor
21. **Implementation Science: Using a Hybrid Type-2 Effectiveness-Implementation Model**
Dian Baker, Karen Giuliano

LGBTQIA HEALTH

22. **Addressing Health Equity through Simulation Education**
Eve Wohlert, Molly Covington, Melissa Lehan Mackin
23. **Behavioral & Biomedical Correlates of STI Among SMM in SF Bay Area**
Fareshta Jan, Michael Deynu, Hannah Whitmore, Alexandria Dunham, Glenn-Milo Santos
24. **Confidence and Competence: LGBTQ Health Education for APRN at Idaho State University**
Colten Boyd
25. **Inclusive By Design: Advancing Transgender Health in Nursing Curricula**
Megan Pratt, Jacqueline Ferdowsali, Deborah Lowell Shindell
26. **Implementation Evaluation of a SGM Peer-Led School Mental Health Intervention**
Harry Adynski, Thye Peng Ngo, Brian Garcia, Key Edyburn

HEALTH POLICY, SYSTEMS, AND LEADERSHIP

27. **Abortion at the Crossroads: A Comparative Policy Analysis between California and Texas**
Sarah Sarandos, Derek R. Manis
28. **Assessing Progress: Integrated Review of LGBTQ+ Faculty Experiences in Academia**
Ellen Garcia
29. **Promoting Inclusivity for Nursing Faculty to Advance Health Equity**
Ellen Garcia
30. **Manual Lifting Standards in Washington Nursing Programs and Safety Laws**
Sydni Sullivan, Jenny Alderden, Sarah Llewellyn
31. **Nurses’ Perceptions of Shared Governance, Psych Empowerment, and Retention**
Emma Aquino-Maneja, Linda Searle-Leach, Hong Li, Juli McGinnis
32. **Pacific Nursing Program Standards Exceed Federal Safe Lifting Guidelines Despite Laws**
Meesha K. Seusy, Sarah Llewellyn, Jenny Alderden
33. **Physician-Assisted Dying Policy: A Comparative Analysis in Arizona and Colorado**
Raheleh Bahrami, Derek R. Manis

34. **State of Shared Governance and Nurses' Engagement in Decision-Making Post-Pandemic**
Linda Searle Leach, Emira Nisrina, Natajia Swift, Hannah Villanueva
35. **Uniting Theory: Psychological Safety and the Intention to Leave**
Kimberly R. Spray, Melissa Lehan Mackin
36. **Using Co-Design and Change Management to Reduce Early Career Nurse Burnout**
Willoughby Moloney, Stephen J. Cavanagh

ORGANIZATIONAL AND WORKFORCE ISSUES

37. **A Program Evaluation of an Organization's Violence in the Workplace Prevention Program**
Sean Patrick Fogarty
38. **A Workforce Pipeline for Healthcare Simulation Technology Specialists**
Molly Kokenge, Haley McNeil, Andy Garcia
39. **Accelerating Confidence: New Instrument for Nurse Leader Role Transition**
Ryan Fuller, Kathy Casey
40. **Becoming Better Leaders and Better Humans: Quarterly Workshops for Nurse Leaders**
Angela Van Zandt, Jessica Schaefer
41. **Ethics and Moral Distress in Aesthetic Medicine: A Mixed-Methods Study in Development**
E Myrick
42. **How Labor Market Mismatches Are Driving Oregon's Nursing Vacancy Crisis**
Richard Allgeyer, Dawne Schoenthal
43. **Prevalence and Risk Factors for Depression Among Registered Nurses: A Scoping Review**
Karley Mariano, Cherry Leung, Jyu-Lin Chen, Ifeyinwa Asiodu, Daniel Tawfik, Sandra J. Weiss
44. **Quality Improvement: Conflict Resolution Amongst Nursing Home Aides**
Ann V. Yang
45. **Resiliency Among Southern California Healthcare System Nurses**
Lina Najib Kawar, Rosalina Mayorga
46. **Self-Care Practices and Retention Intent Among Early-Career Bedside Nurses**
Mikayla Farley, Edward Zepeda, Jenny Alderden
47. **Spiritual Well-Being and Nurse Burnout within Non-Faith Based Hospital Settings**
Quincyann Tsai, Diana Lynn Woods
48. **System-Level Well-Being: Reductions in Stress through Stakeholder-Driven Design**
Dawne Schoenthal, Richard Allgeyer

RACIAL/ETHNIC MINORITIES

49. **An 8-Week Text Message-Based Program for Korean American Dementia Caregivers**
JiWon Choi, Hayoung Yoon, Sonia Picht, Hannah You, Janice Tsoh
50. **Black Families' Anticipatory Grief in the ICU: Insights from Mixed Methods**
Krista K. Wonderly
51. **Colonialism in Healthcare: Experiences of Filipino Americans**
Sorina Neang Long, Paul Boy, Taylor Aguinaldo, Haley E. Dablo, Eunice U. Atienza, Lalaine Sevillano, Dante Anthony Tolentino

52. **Cultural Adaptation of an Asthma mHealth Tool: Qualitative Findings**
Donna-Marie Palakiko, Alyssa Tomlinson, Holly B. Fontenot, Anthony Peruma
53. **Developing a Connectiveness Measure for American Indian Adults with Loneliness**
Paul Boy, Yuriko Matsuo, Felicia Schanche Hodge
54. **Efficacy of Behavioral Interventions on the HIV Care Continuum**
Nneka Umeh, Matt Demonbrun, Jerry Ouner, Glen-Milo Santos
55. **Intimate Partner Violence Among College-Aged South Asian Americans**
Kavya Juwadi, Sunny Wonsun Kim, Julia Hammett
56. **Risk Factors for Intimate Partner Violence in the Latina Population**
Jodi B. Patterson, Bea Ade-Oshifogun, Virginia Herrera, Kwabena Adu Agyemang, Anjelica Carabagal
57. **Strands of Inclusion: Advancing Cultural Competence in Hair Care Education**
Ariel Hale
58. **The Double Burden: Caregiving and Farm Labor Among Latina Migrant Workers**
N. Maggie Tobar, Fiorella L. Carlos Chavez, Alma Manzo, Alexandra Brewis, Amber Wutich

RURAL HEALTH

59. **Addressing Firearm Risks Among Rural Residents with Substance Use Disorder**
Alexa Curtis, Erin Grinshteyn
60. **Addressing Rural Behavioral Health: Collaborative Care and Project ECHO**
Christopher D. Hernandez, Larry C. Garrett, Megan L. McClure, Rebekah Perkins
61. **Assessing the Knowledge Base of Valley Fever to Seek Prompt Treatment**
Annie Boehning, Amberlynn Quick, Maria Gonzales, Hiladia Foster
62. **Project Evaluation of a Workplace Violence Prevention Program at a Rural Hospital**
Stacy Ochoa-Sofaifa, Yolanda L. Rodriguez, Melissa Bowe, Teresa Mendoza
63. **System-Level Impacts of Rural Hospital Closures: An Integrative Review**
Charlotte Bryant, Dorothy J. Wiley
64. **Transitioning to School-Based Health in a Rural Indigenous Community**
Madeline Metcalf, Laura S. Larsson, Shelly Hogan, Nicole Krueger, Ann Galloway

SYSTEMATIC REVIEWS/META-ANALYSES/SCOPING REVIEWS/INTEGRATIVE REVIEWS

65. **High Fidelity Simulation in Prelicensure Nursing Programs: A Systematic Review**
Pius Omolewa, John Bressan, Feng Ping (Sarah) Lee
66. **Lived Experiences of Men Working in Both White-Collar and Blue-Collar Jobs**
Pius Omolewa, John Bressan, Nassrine Nouredine
67. **Information Needs in Early-Stage Chronic Kidney Disease: An Integrative Review**
Chan mi Lee, E. Brie Thumm, Samantha Stonbraker
68. **Problematic Digital Media Use in Young Adults: Systematic Review Protocol**
Rachelle Chanmany Pastor, Fayette K. Nguyen Truax, Safiye Sahin, Janet Donnelly, Jan M. Nick, Shan Tamares
69. **Values Conflicts, Burnout, and Moral Injury Among U.S. Nurses: A Scoping Review**
Natalie L. Nguyen, Tiana Luong, Cody Allen Navarro, Lindsey Blake, Olivia Liuson, Trinity Yang, Josiah Kira, E. Alison Holman

70. **Weight Loss Interventions to Support Latinas in the United States: A Systematic Review**
Rosario B. Jaime-Lara

TECHNOLOGY IN NURSING EDUCATION

71. **Advancing Nursing Outcomes through Virtual Reality and Experiential Learning**
Kimberly Dunker, Kevin Little, Tony Chung
72. **Design, Implementation, and Evaluation of a Beta-Testing Model for New Simulations**
Ruth Mielke, Ebere Ume, Ragi George, Hong Li
73. **Enhancing Student Engagement in an RN–BSN Program: An Ongoing Program Evaluation**
Germin Zaki
74. **Improving Compliance Via Mobile Barcode Scanning with Rover App**
Jeni George Varghese, Lilia Preston
75. **Point of Care Ultrasound Curriculum Implementation in the Fnp Program**
Haesook Kim, Jane Perlas, Tal Sraboyants
76. **Turning Presentations into Conversations: Strategies for Engaging Learners**
Lisa A. Jaurigue, Victoria Voit, Salina Bednarek

RESEARCH AND INFORMATION EXCHANGE POSTERS (R&IE)

CALIFORNIA STATE UNIVERSITY SAN BERNARDINO DEPARTMENT OF NURSING

77. **A Conceptual Analysis of Using Art to Teach Nursing Theory**
Nicole Ringo
78. **AI-Generated Clinical Simulations and Student Learning Outcome**
Kattiya Podimuang
79. **Building Resilience with AI and Vital-sign Engagement (BRAVE) for Nursing Students**
Jacqueline Orozco, Daisy Rosas, Samantha Juan
80. **Burnout and Self-Care Challenges Among Pre-Licensure Nursing Students**
Timothy Ortiz, Pinthusorn Pattayakorn, Anne Lama, May San-Rozano, Justin Schneider, Kattiya Podimuang
81. **Compassionate Hearts: A Jean Watson Approach to Street Medicine**
Anne Lama, David Ramos, Nancy Amador, Genesis Barrientos
82. **Expanding Horizons: International Engagement Through Nursing Speakers**
Pinthusorn Pattayakorn, May San-Rozano
83. **Higher Education and Learning: Belonging in Nursing Students (HEALS)**
Daisy Rosas, Jacqueline Orozco, Samantha Juan, Yeon Kim, May San-Rozano
84. **Systematic Review of Clinical Incivility Interventions in Nursing**
Younglee Kim, Anne Lama, Henrietta Nwamu

UNIVERSITY OF CALIFORNIA SAN FRANCISCO SCHOOL OF NURSING

85. **Behavioral Interventions to Increase Contraceptive Use Among Women Living with HIV**
Michael Deynu, Sarah Gutin, Ifeyinwa Asiodu, Jerry Nutor, Glenn-Milo Santos
86. **Burnout Prevalence and Contributing Factors among Nurse Residency Program Graduates**
Kellie Redmond

87. **Efficacy of Behavioral Interventions on the HIV Care Continuum**
Nneka Umeh, Matt Demonbrun, Jerry Ouner, Glenn-Milo Santos
88. **Moral Distress Experienced by the Certified Nursing Assistants Working in Nursing Home**
Kirsi Toivanen-Atilla
89. **Physiologic Responses Associated with Alcohol Withdrawal Syndrome**
Dawn Troeger, Hildy Schell-Chaple, Heather Leutwyler, Shannon Smith-Bernardin, Michele Pelter
90. **Prevalence and Risk Factors for Depression Among Registered Nurses: A Scoping Review**
Karley Mariano, Cherry Leung, Jyu-Lin Chen, Ifeyinwa Asiodu, Daniel Tawfik, Sandra J. Weiss
91. **Providers' Perspectives on Mental Health in West African Neonatal Intensive Care Wards**
Evelyn Bigini, Orlando O. Harris, Ifeyinwa Asiodu
92. **The Conceptualization of the Experience of Surgical Smoke**
Merideth Lewis

UNIVERSITY OF THE PACIFIC SCHOOL OF HEALTH SCIENCES

93. **From Bedside to Blackboard: Institutional Supports for Novice Nurse Educators**
Christine Early, Michael Hill
94. **Stress Management and Resilience Among Students Enrolled in the Entry Level Master of Science in Nursing (ELMSN) Program**
Pius Omolewa, Nassrine Nouredine, Loue Ella
95. **Camino a la Salud: Culturally Tailored Diabetes Education for Hispanic Older Adults in Stockton, California**
Feng Ping (Sarah) Lee, Alondra Aldaba, Alexis Irvine, Jazmyn Monares, Marissa Doblados-Wood
96. **Nurses' Competency at Hospital-at-Home: A Scoping Review**
Feng Ping (Sarah) Lee, Alex Chiu, Hsiu-Fang Hsieh
97. **The Artful Aging Project Bridging Social Connections and Movement Through Art Therapy in Older Adults**
Feng Ping (Sarah) Lee, Maria Fernandez, Sah'Neya Fryer, Kathleen Morris, Maya Price
98. **The Safe Steps Project: Fall Prevention Amongst Older Adults in a Skilled Nursing Facility**
Feng Ping (Sarah) Lee, Maiana Cabrera, Yen Tran, Nicole Le
99. **Addressing Nursing Student Burnout through Mindfulness and Zen Den at University of the Pacific**
Dian Baker, Tanairi Ingram, Jeremy Seaton, Natalia Zelayandia
100. **Enhancing Pediatric Sun Safety: A Parent-Focused Intervention in El Dorado**
Dian Baker, Alaina Godwin, Ashley Riley, Calvin Nauer
101. **Fall Prevention in the Emergency Department at Sutter Medical Center Sacramento**
Dian Baker, Vaneza Espino, Roshni Hayer, Yajari Mendoza, Tanya Rodriguez Duarte
102. **Hospital-Acquired Pressure Injury Prevention in ICUs: A Quality Improvement Initiative at Sutter Medical Center Sacramento**
Dian Baker, Mijung Lim, Daniela Tobler, Raquel Youkhana
103. **Hygiene Heroes**
Dian Baker, Sidney Clymer-Engelhart, Kirstie Shulman
104. **The Kangaroo Care Project: Educating Nurses and Parents to Improve STS Rates in the NICU**
Dian Baker, Martha Calero, Katherine Do, Lydia Nambala, Bianca Wong

**UNIVERSITY OF SAN DIEGO HAHN SCHOOL OF NURSING AND HEALTH SCIENCE BEYSTER INSTITUTE
FOR NURSING RESEARCH**

105. **A Scaffolded Approach to AI Course Development in a PhD Program**
Caroline Etland, Sheree Scott, Carrie Fry, Razel B. Milo, Cynthia D. Connelly
106. **Depression Related Factors in Hispanic Adolescents**
Elisa Romero
107. **Empathy in a Palliative Care Scenario: The Standardized Patient Perspective**
Karen Anderson
108. **Ethical Awareness in Novice Pediatric Nurses: A Concept Analysis**
Heather Garcia
109. **Factors Associated with ECMO Survivability in an Intensive Care Setting**
Shuaa Aldajani
110. **Navigating High-Stakes Choices: ICU Surrogate Shared Decision-Making**
Jessica Ritchie
111. **Palliative and End of Life Simulation: Quantitative and Qualitative Evaluation**
Caroline Etland
112. **Post-stroke Depression Among Stroke Survivors in the Acute Stroke Phase**
Sheryn Shahwan-Solorzano
113. **Survivorship Related to Pediatric Cardiac Arrest: A Concept Analysis**
Paulina Schuler
114. **Transitioning While Serving: Lived Experiences of Transgender Service Members**
Stephany Daniels

UNIVERSITY OF UTAH COLLEGE OF NURSING

115. **Category Error and Moral Dissonance in Healthcare: A New Theory**
Garrett Schwanke, Emily Barrows
116. **Cue-Based Care for Improved Preterm Infant Sleep: An Evidence-Based QI Project**
Amanda Chamberlain, Katherine Doyon
117. **Implementing a CNA Palliative Care Intervention: A QI Project**
Caroline Sariah Howell, Rebekah Perkins, Caroline Stephens, Laura Block, Rachel Alexander, Pamela Barrientos, Jennifer Hamilton, Lynn Flint
118. **Implementing a Nurse Wellness Program in an Oncology Critical Care Unit**
Mykel Winter, Scott Christensen
119. **Implementing a School Nurse-Led Toolkit to Reduce Chronic Absenteeism in Utah**
Katherine Sardonj, Natasha Ansari
120. **Implementing the MENO10 Screener: A QI Initiative**
Kelley Keenan, Gwen Latendresse
121. **Optimizing the Expanded Role of the Nurse for the Underserved**
Jenneth Doria
122. **Pain and Self-Efficacy Among Adolescents and Young Adults with Cancer**
Nemeh Manasrah, Paula Meek, Lee Ellington, Lauri Linder, Jeannine Brant, Kristin Stegenga

123. Preparing PhD Students for Tenure-Track Faculty Positions

Mary Killela, Jessica Williams, Harry Adynski, Gillian Adynski, Cassandra Dictus, Leah Morgan, Elizabeth Myer, Hayden Hmiel

124. Severe Drought Around the Great Salt Lake and Its Influence on Asthma

Wen Tu, Runyue Pu, Xiaoming Sheng

125. Using Mini-Plays to Foster Clinician Confidence in Advance Care Planning

Moroni Fernandez Cajavilca, Jacqueline Eaton, Sara Bybee, Kara Dassel, Nicole Fleming

SAMUEL MERRITT UNIVERSITY COLLEGE OF NURSING

126. Returning Home: A Caritas Journey of Spiritual Reconnections and Ancestral Healing in the Ashanti Region of Ghana

Carmen Ward-Sullivan

POSTER SESSION 4 | FRIDAY, APRIL 24 | 8 AM - 12 PM

Poster presenters in Poster Session 4 should stand by their posters from 9:45 – 10:45 AM.

WIN PEER-REVIEWED POSTERS

AI

1. **AI Avatars: Bringing Technological Innovations to Online Asynchronous Education**
Christina Baker
2. **AI Meets the Adjunct: Voices from the Virtual RN-BS Nursing Classroom**
Delia Rico, Lynn Nichols, Darci McCall, Ava Farahany
3. **Artificial Intelligence Augmented Thematic Analysis for Intervention Effectiveness**
Jinseon Hwang, Jessica Ziemek, Elaine A. Thompson, Li Juen Chen, Cynthia M. Dougherty
4. **Artificial Intelligence in Diabetes Self-Management: An Integrative Review**
Michael Le, Annika Daphne Bilog, Sorina Neang Long, Jaden Tonthat, Pomona Siatong, Dante Anthony Tolentino
5. **Artificial Intelligence in Sleep Health: A Systematic Review**
Shumenghui Zhai, Adam Haley, Jingyi Li, Frances Chu, Zhuoran Huang, Serena J. Xie, Liying Wang, Weichao Yuwen
6. **Artificial Intelligence: Enhancing Patient Safety, A Scoping Review**
Evangeline Fangonil-Gagalang, Sarah Flores, Fang-yu Chou, Hannah J. Kim, Mary Anne Schultz
7. **Culturally Adapted Conversational Agent and User Experience: A User Study**
Yanjing Liang, Serena J. Xie, Shumenghui Zhai, Jingyi Li, Xuehong Fan, Weichao Yuwen
8. **Enhancing AI Literacy and Leadership Communication Skills in DNP Education**
Julie Astrella
9. **Explainable AI (XAI) for Personalized Inpatient Fall Risk Prediction**
Ji Young Lim, Mi Jin Lee, Seong Kwang Kim
10. **Generating Automated Texts for Nurses Supporting Older Adults with Aging-in-PLACE**
Roschelle Fritz, Diane J. Cook
11. **Mapping Nurse Educator Adoption of Generative AI: A Framework for Innovation Diffusion**
Necole Leland, Lisa Nicholas, Jennifer Vanderlaan
12. **Motivations Driving Nursing Student Use of AI during Clinical Reasoning**
Daniel Bulek, Nicole Harvey

DIGITAL HEALTH/EHEALTH/MHEALTH

13. **A Theory Analysis of Robot Acceptance by Formal Caregivers Using the TAM**
Charles Kwanin
14. **App-Based Insights into Subjective Memory Complaints in Older Adults**
Maryam Niazi, Ross Andel, Joseph Saenz
15. **Tech-Wise Parenting: Mapping a Conceptual Framework for Digital Parenting**
Sunny Chieh Cheng, Frances Marcus Lewis, Elaine Walsh, Mayumi Willgerodt

16. **Using Andersen's Model to Examine Factors Affecting Telehealth for Mental Health**
Erwin Simanjuntak, Roschelle Fritz
17. **Vaxcom, a Digital Tool to Improve Recruitment for Phase 1 HIV Vaccine Trials**
Christine Tagliaferri Rael, Jorge Soler, Hong-Van Tieu, Brittany Curet, Samantha Stonbraker

MENTAL HEALTH/BEHAVIORAL HEALTH

18. **ACEs Screening in a Cognitive Behavioral Therapy Intensive Outpatient Program**
Serena Lee
19. **Alcohol Consumption and Shift Work: Correlates of Neurobehavioral Health Outcomes**
Kevin Dangler, Jinyoung Kim
20. **An Investigation of Therapeutic Processes in an Innovative Mental Health Treatment**
Makenzie Maker, Allen Alford, Alexandra Lichota, Paul Cook, Rachel Johnson-Koenke
21. **Armed with Information: Digital Tools to Reduce First Responder Burnout**
Emily Reichman, Patricia Inman, Heather M. Ross
22. **Discrimination, Coping and Postpartum Depression in Black American Fathers**
Joseph Onwuka, Adeline Nyamathi, Jung-Ah Lee, Yuqing Guo
23. **Empowering Recovery: Implementing ACE Screenings to Enhance Care for Patients with SUD**
Joshua A. Wolf
24. **Implementing CBT-I Coach App during Evaluations: Provider Quality Improvement**
Sarah Jeanhee Kang
25. **Mental Distress, Drinking Motives, Problematic Alcohol Use, and Condom Use Resistance**
Kavya Juwadi, Julia Hammett, Weiqi Chen, Raheleh Bahrami, Kelly Cue Davis
26. **Reducing Harm Via Columbia Suicide Scale: A Process Evaluation Study**
Michelle Martinez
27. **Social Media Use and Mental Health Outcomes Among Hispanic Adults**
Sally Moyce, Mey Palomino
28. **Utilizing Nature Inspired Interventions on a Behavioral Health Unit**
Kimberly Robinson, Jessan Sison

QUALITATIVE

29. **Exploring the Lived Experiences of Gynecological Teaching Associates**
Theresa Asmus
30. **Exploring Views on Healthy Beginnings for Unhoused Women: A Qualitative Study Protocol**
Benissa E. Salem, Adey Nyamathi, Barbara Riegel, Lillian Gelberg, Melissa Y. Wei, Nicholas Jackson, Dana Rose Garfin, Stephanie S. Covington, Evelyn Vega, Andrea Loera, Tori Prescott, Kimberly Navarro
31. **Moral Distress Experienced by the Certified Nursing Assistants Working in Nursing Home**
Kirsi Toivanen-Atilla
32. **The Collective Work of a Transdisciplinary Research Center: A Qualitative Study**
Aliria Rascón, Shelby Langer, Heather Ross, Julia Hammett, Angel Algarin, Alyssa Robillard, Felipe Gonzalez Castro, Fiorella L. Carlos Chavez, Joseph Daniels, Kelly Cue Davis, Rachel Gur-Arie, Rodney P. Joseph, Sunny Wonsun Kim, Rebecca Lee, Chung Jung Mun, Eyitayo Omolara Owolabi, Megan E. Petrov, Shawn Youngstedt, Gabriel Q. Shaibi

33. **The New Normal: A Qualitative Study of Experiences of Today's Academic Nursing Faculty**
Lisa Scott

QUANTITATIVE

34. **Curriculum Effects on Student Knowledge, Attitude, and Intent to Work with Older Adults**
Kelly Henrichs, Lisa S. Zenoni, JoAnn Crownover, Kenneth Oja, Figaro Loresto
35. **Nurse Perceptions and Outcomes Following Implementation of the Co-Caring Model**
Trisha Saul, Amanda Espinosa, Mindy Luebs, Ross Bindler
36. **Early Implementation Study of a Co-Caring Nursing Model**
Trisha Saul, Cara Gallegos, Troy Larkin
37. **Improving Elementary School Staff Knowledge of Minor Trafficking: An Evaluation**
Erin McCauley, Alex Wyse
38. **The Return on Investment of a DNP Degree: Insights from a Reputation Fitness Plan**
Kelly Fox, Carolina Echeverria

PAIN

39. **Factors Influencing the Type of Pain Interventions in Patients Who Are Nonverbal**
Oliver Erece
40. **Heterogeneity of Treatment Effects in TDCS and Meditation for Knee Osteoarthritis Pain**
Chiyoung Lee, Juyoung Park, Allison J. Huff, Dasol Ahn, Hongyu Miao, Hyochol Ahn
41. **Implementation of Pain Management Menu for Intrauterine Device Insertion**
Yongchuan Lin, Mary Jo Russo, Jennifer Hanlon-Wilde
42. **Introducing Nurse Navigators to Address PAIN Care Inequities**
Haley Donovan, Beth Feustel, Fionnuala Brown, Ross Bindler, Jennifer Miller
43. **Symptom Management Theory in Rare Disease Research: Gaucher Disease Type 1 Insights**
Shauna Mangum, Stephen H. A. Hernandez, Elizabeth Dickson, Wendy Packman, Beth Tigges

PALLIATIVE AND END OF LIFE CARE

44. **A Conceptual Framework for the Study of Nursing Self-Efficacy in Postmortem Care**
Kaleigh Barnett, Cindy Rishel
45. **An Integrative Review: Palliative Care Among Older Adults with Heart Failure**
Yuka Imai, Benissa E. Salem
46. **Development of a Manual for Psychedelic Therapy in HIV+, Hospice, and Palliative Care**
Hannah Rose Whitmore, Sara Lewis, Lesley C. Greene, Heather Leutwyler, Brian T. Anderson
47. **Equity at the End of Life: Nursing Approaches to Advance Care Planning**
Kayla N. Ideozu
48. **Interpreters' Role as Cultural Brokers in Serious Illness Conversations**
Adebusola Oluwatoba-Adeyemi, Carolina Cannard, Hannya Ornelas, Sadia Abdulkadir, Naomi Mwamba, Sunny Smart, Katherine Doyon

SLEEP

49. **Sleep Better: Educating Dementia Caregivers on Healthy Sleep**
Yingyan Huang, Erin Tharalson, Julie Fleury, Zachary G. Baker
50. **Sleep Improvements during Cecebot Intervention in Breast Cancer Survivors**
Hyo Chan Park, Chi-shan Tsai, Hyunhae Lee, Warren J. Szewczyk, Hongyu Yu, Alexi Vasbinder, Julia K. Palmer, Jamiee L. Heffner, Michelle Drerup, Heather Greenlee, Kerryn W. Reding, Sophie Putnam

STUDENTS

51. **Bipoc Nursing Students' Experiences with Faculty Advisement: A Mixed-Methods Study**
Marjorie Attis-Josias, Layla Garrigues
52. **Bridging School to Practice: A Collaborative Clinical Model Evaluation**
Nassrine Nouredine, Trisha L. Powers
53. **Building Professional Identity in Senior Nursing Students: A Pilot Study**
Yeon Kim
54. **Engaging Students: Academic Support Aligned with CCNE II-C/D**
Kate C. Turpin
55. **Evaluating the Use of Learning Assistants in an Undergrad Pathopharmacology Course**
Gordon Williamson, Megan Alangui, Alyssa Canafe, Alyssa Cansino, Natalia Hernandez-Bernal, Kaleigh Paul, Korayma Romero Polanco, Citlalli Sanchez-Lopez, Serenity Swangchaeng, Lauren Stemple
56. **Factors Influencing Gen Z Nurses to Stay: Review and Recommendations**
Leticia Lara
57. **Feasibility of Mindfulness App for Parents in Nursing School: Pilot Study**
Chinma E. Njoku, Ryoko Kausler
58. **Integrating Pilina into a Cohort of First-Year Nursing Students**
Katie A. Azama, Donna-Marie Palakiko
59. **Navigating Dual Roles: Understanding Parental Stress Among Nursing Students**
Emma J. Stover, Ryoko Kausler
60. **Nursing Students' Intentions to Adopt Artificial Intelligence in Future Practice**
Kholoud Hardan-Khalil, Jill Kardously, Michael Williams
61. **The Bridge from Education to Practice: Insights from a Longitudinal Clinical Model**
Leslie S. Barnum, Salina Bednarek
62. **Undergraduate Nursing Students and Care of Older Adults in Nursing Homes**
Omotayo O. Omotowa, Mary Nies, Kaitlynn R. Gist, Leah Ankarberg
63. **School Context Matters: Predictors of Post-Training Empathy in Suicide Prevention**
Amanda Hapenny, Elaine Walsh

THEORY

64. **Nurses as Secondary Adopters of Innovation: Applying Gallivan's Framework**
Ian Klug, Rodney P. Joseph
65. **Promoting Belonging: A Theory-Based Virtual Intervention for Older Adults with MCI**
Raena Nolan, Julie Fleury, Allie Peckham

- 66. **Fostering Educator Well-Being: A Pedagogical Wellness Framework in Nursing**
Stephanie Au
- 67. **Reimagining the Health Professions Pipeline: A Multidimensional Framework**
Stephanie Au, Jocelyn Ludlow, Amanda Valbuena, Ashley Cheri, Ashley Cheri, Alondra Garcia Bedolla

RESEARCH AND INFORMATION EXCHANGE POSTERS (R&IE)

ALTAMED HEALTH SERVICES, ALTAMED INSTITUTE FOR HEALTH EQUITY

- 68. **Advancing Care in FQHCs: The Impact of Nurse Engagement Scores on Practice & Outcomes**
Laura Shouse, Vivian Nguyen
- 69. **Pharmacy–Nurse Collaboration in Developing Infusion Protocols in FQHCs**
Abigail Villalobos
- 70. **A Nursing-Led Approach to Equitable Care Delivery**
Angela Hughes
- 71. **Celebrating Culture, Strengthening Teams: Building a Heritage Month Program in a Safety-Net System**
Zurisadai Inzunza, Adrienne Martinez-Hollingsworth, Monika Scherer
- 72. **Familismo Care Model: A Framework Reenvisioning Health Care Provider’s Role Serving Latinx Adults**
Jackie Martin, Adrienne Martinez-Hollingsworth
- 73. **Navigating the Currents of Trust: Models, Epistemologies, and Strategies Among US Latinx Communities**
Rosario Jaime-Lara, Sally Moyce, Samia Valeria Ozorio Dutra, Adrienne Martinez-Hollingsworth, Mary Nies
- 74. **Nurse Leadership Development Pathways in FQHCs**
Dave Tilford, Joumana Rechdan
- 75. **Nursing Roles in Centralized Critical Results Management in an FQHC Setting**
Justin Maldonado
- 76. **Phenomenology as Prediction: Developing Archetypal Avatars to Assess Workforce Post-Disaster Needs**
Adrienne Martinez-Hollingsworth, Bryant Andrade, Monika Scherer, Zuri Inzunza
- 77. **Simulation for Quality, Access, and Equity: The Center for Clinical Excellence**
Paul Carnavale, Andrea Alvarez, Sophia Hernandez, Ali Tayyeb
- 78. **The Price of Convenience: AI, Intellectual Deskilling, and the Loss of Organizational Insight**
Adrienne Martinez-Hollingsworth, Clayton Chalmers, and Emre Sezgin

ARIZONA STATE UNIVERSITY EDSON COLLEGE OF NURSING AND HEALTHCARE INNOVATION

- 79. **Rural and Remote Maternity Care Integration**
Deborah Acker
- 80. **The Impact of Mentorship on Students Preparing for Transition into Practice**
Nichole Hackbarth, Lauren Underwood

BETTY IRENE MOORE SCHOOL OF NURSING AT UC DAVIS

- 81. **Beyond the Novice: A Competency-Based Model for Primary Care APP Success**
Ana Marin Cachu, Deb Bakerjian, Jonathan Kwan, Kristen Bettega
- 82. **Building Reproductive Health Savvy in New Advanced Practice Providers**
Marla Shauer, Deb Bakerjian, Holly Kirkland-Kyhn, Jonathan Kwan

83. **Driving Innovation: The Future of APP Primary Care Provider Fellowship Partnerships**
Surani Hayre-Kwan, Deb Bakerjian, Darcy Wikoff, Edna Esquer, Marla Shauer, Shamika Brooks, Jonathan Kwan, Ana Marin Cachu
84. **Early Esophageal Cancer Detection in High-Risk Kenyan Women with HIV**
Laura L. Van Auker, Janet Meda, Charleen Singh, Stephen J. Cavanagh, Mariana Javeza Omenda
85. **Empowering the Next Generation of Nurse Educators: A Faculty Residency Curriculum**
Amy Nichols, Deb Bakerjian, Shana Ruggenberg, Elizabeth Rice
86. **From Clinician to Educator: An Evaluation Model Using NLN Novice Competencies**
Deb Bakerjian, Amy Nichols, Shana Ruggenberg, Elizabeth Rice
87. **From Deep Sedation to Awake and Walking ICU Care: Implementation Insights Using CFIR**
Kerri Maya
88. **Integrating Clinical and Technical Expertise for Contactless Sensor Evaluation**
Shu-Fen Wung, Alisha H. Johnson, Chang-Chun Chen, Marge Skubic, Ahmad Alsharoa, Mihail Popescu
89. **Methodological Adaptations for Health Technology Research in Older Adults**
Shu-Fen Wung, Alisha H. Johnson, Chang-Chun Chen, Melinda Fauss
90. **Navigating Complexity: Insights from a HIV Post-Exposure Prophylaxis Pilot Study**
Alona Chamblee, Jocelyn C. Anderson, Jessica Draughon Moret
91. **Searching for the Optimal Time to Collect Lactate Levels**
Laura Senn
92. **Trauma-Informed HIV Post-Exposure Prophylaxis Decision Making after Sexual Assault**
Patricia Fernandez, Tequila Porter, Lakyn Webb, Jocelyn Anderson, Jessica Draughon Moret

CALIFORNIA STATE UNIVERSITY, FULLERTON

93. **Enhancing Fall Prevention Strategies: RN and CNA Re-Education**
Patricia Wekhomba, Najood Azar, Rachel McClanahan
94. **Exploring Fresh Gas Flow Rates for Sevoflurane and Creating Best Practice Recommendations**
Samantha Ferraro, Kannitha Lor, Hunter Jeffers, Kyle O'Reilly, Sandra Bordi, Rachel McClanahan
95. **Increasing Awareness of the Impact of Night Shift Work on New Graduate Nurses**
Julia Apenahier, Shauna Pearce, Rachel McClanahan
96. **Increasing Pre-Exposure Prophylaxis (PrEP) Initiation for Patients at Risk for HIV and Supporting Patient Adherence**
Tigist Teshale, Deanna Jung, Najood Azar
97. **Optimizing Team Dynamics to Improve Self-Efficacy and Cardiopulmonary Resuscitation**
Soriya Liddell, Kate Bayhan, Laura Sarff
98. **Patient Care Experiences with Anesthesia Based on an Outpatient and Ambulatory Surgery Survey**
Philip Caro, Shawn Weinburger, Abigail Kahn, Mark Gabot, Sadeeka Al-Majid
99. **Pediatric Functional Constipation: Evaluation of a Multidisciplinary Bowel Management Program**
Kristen Ginger, Jill Berg, Rachel McClanahan
100. **Standardizing Bowel Preparation Efficacy for Outpatient Colonoscopies**
Jean Cahn, Kate Bayhan, Diana Tai

LOMA LINDA UNIVERSITY SCHOOL OF NURSING

101. **Communication for Patients with Intellectual and Developmental Disabilities**
Amyela Adarlo, Robin D. Pueschel, Salem Dehom
102. **Community-Based Education for HTN Lifestyle Management: An EBP Project**
Elizabeth Mkroyan, Kathy Valdeverona, Salem Dehom
103. **Cultural and Societal Influences on Returning to Work After Maternity Leave**
Safiye Sahin, Sabine S. Dunbar, Rachelle Chanmany-Pastor, Lisa R. Roberts, Jan M. Nick, Gurmeet Sehgal
104. **From Metrics to Meaning: Transforming Admissions through a Wholistic Lens**
Brianna Bolaños, Lena Dailey, Salem Dehom
105. **Mental Health Help-Seeking among Filipino-American RNs: A Preliminary Study**
Annika Bilog, Elizabeth Johnston Taylor
106. **New Graduate Nurse Practitioner Practice Readiness: A Concept Analysis**
Jessica Padilla, Rachelle Chanmany Pastor
107. **Raising the Bar through SBAR: A Quality Improvement Project**
Autumn Chang, Robin D. Pueschel, Salem Dehom
108. **New Normal, Life After Diagnosis with Multiple Sclerosis: A Concept Exploration**
Jaimie Scott, Rachelle Chanmany Pastor
109. **TB Mortality Declines as Incidence Stalls: Lessons from WHO Surveillance Data**
Prisana Mandeville, Jan M. Nick, Safiye Sahin
110. **Teaching Psychiatric Handoff Communication: A Quality Improvement Project**
Kevin Kim, Joanna Yang, Salem Dehom
111. **Use of a Structured Communication Rounding Model in a Medicine Unit**
Jackie Raygoza, Robin D. Pueschel, Salem Dehom
112. **Why Emotional Intelligence Matters for Senior Nursing Students: Pilot Study**
Kimberly Dunker, Sandra Ringer, Vicki Moran

SAN DIEGO STATE UNIVERSITY SCHOOL OF NURSING

113. **Advancing Institutional Capacity Toward a Formalized Concurrent ADN-to-BSN Pathway**
Diane Greenwood

UNIVERSITY OF WASHINGTON SCHOOL OF NURSING

114. **A Preliminary Analysis of Musculoskeletal Experience and Work Conditions of Manicurists**
Johnny Nguyen, Jenny Hsin-Chun Tsai
115. **A Logic Model to Highlight Impacts of the de Tornyay Center**
Wenting Peng, Priscilla Carmiol-Rodriguez, Sarah McKiddy, Yanjing Liang, Basia Belza
116. **Insights and Future Directions From the 2026 University of Washington Healthy Aging Forum**
Sarah McKiddy, Nicolai Wohns, Basia Belza, et al.
117. **Empowerment Among AGYW Seeking Contraception at Retail Pharmacies in Kenya**
Meshack Otewa, Benard Rono, Bernard Nyerere, David Katz, Felix O. Mogaka, Greshon Rota, Josephine Odoyo, Katrina Ortblad, Meena Lenn, Melisa Mugambi, Monisha Sharma, Victor Omollo, Zachary Kwena, Elizabeth Bukusi, Jillian Pintye

118. **Facility Delays as a Driver of Stillbirth and Neonatal Death in Kenya**
Brenda Wandika, K. Ronen, J. Unger, J. Pintye, et al.
119. **Misinformation & Disinformation Susceptibility of UW Nursing Students**
Genevieve Aguilar, Kyla Haggith, Charles Kwanin, Gilliane Nwafor
120. **Centering Patients in Mobile and Street-Delivered MOUD in King County, WA**
Marin Strong, Kaitlyn Harbick, Ohshue Gatanaga, Chelsea Rodgers, Kathy Wang, Sara Glick, Maria Corcorran, Omeid Heidari
121. **Strategy in Action: Aligning Budget, Infrastructure, and Investment to Advance Nursing Research**
Sarah Zangrillo, Erlene Guieb, Allison Webel
122. **Physical Activity and Sarcopenia in Older Adults with HIV (Prosper HIV)**
Allison Webel, Vitor Oliveira
123. **Physical Activity, Diet, and Physical Function in Adults With HIV (Prosper HIV)**
Allison Webel, Vitor Oliveira
124. **Queering Drug Use: Chemsex, Queer Theory, & Enhancing Safety**
Michael Moore, Victoria Adams, Omeid Heidari, Allison Webel
125. **Undergraduate Study Abroad Experiences and Implications for Mental Health**
Hyunhae Lee, Chi-Shan Tsai, Alexi Vasbinder, Damien Hyo Chan Park, Kerry Reding

WASHINGTON STATE UNIVERSITY COLLEGE OF NURSING

126. **Implementing an ERAS Protocol for Hip and Knee Arthroplasty in a Rural Clinic**
Elizabeth Wood, Mary Jo Russo, Oren Larson
127. **Preceptor Perspectives on PMHNP Clinical Preparedness and Practice Readiness**
Amanda Stewart, Anne Marie Reed

SAMUEL MERRITT UNIVERSITY COLLEGE OF NURSING

128. **Quantitative Analysis of Typhon Data: Impact of COVID-19 on CM Students' Clinical Work**
Fusae Abbott, Janet Rowland, Rebecca Boyd Anderson

CONFERENCE FLOOR PLAN

Conference Map: Floors 1-3

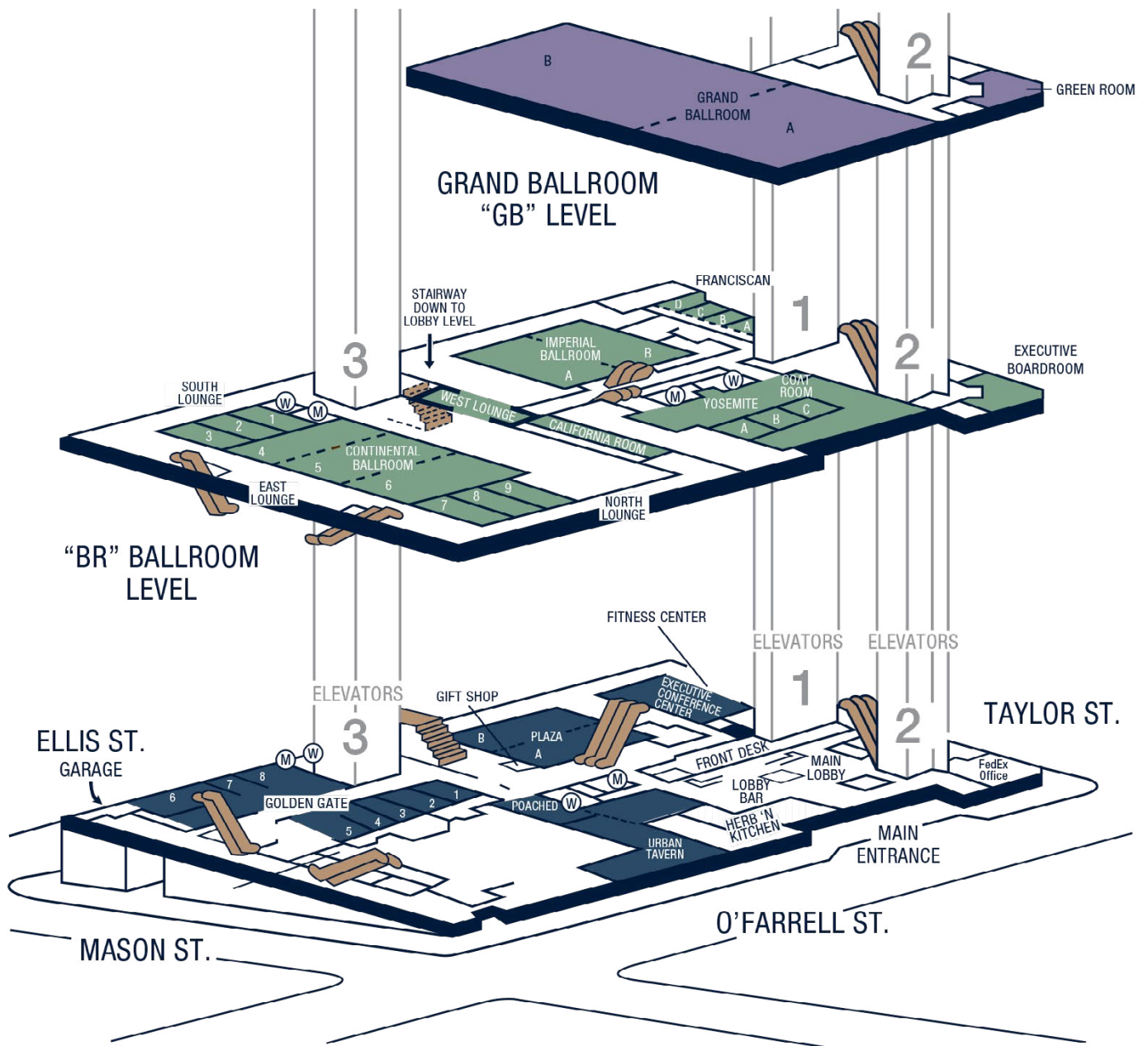

- ESCALATORS AND STAIRS TO BALLROOM LEVELS**
- LOBBY LEVEL**
Golden Gate, Urban Tavern, Lobby Bar, Herb n' Kitchen, Poached, Plaza A/B and Executive Conference Center (Seacliff, Presidio, Sunset, Marina)

- BALLROOM LEVEL**
Continental, Imperial, Yosemite, Franciscan, Executive Boardroom
- GRAND BALLROOM LEVEL**
Grand Ballroom and Green Room

ACCESSIBLE FACILITIES
Accessible restrooms are located on the following levels: L (LOBBY), B (BALLROOM), M (GRAND BALLROOM, MEZZANINE)

- * Package Express located in Tower 3, Garage Level
- * Pool located in Tower 3, 16th Floor
- * Cityscape and Vista Located at Top of Tower 1

CONFERENCE FLOOR PLAN

Tower 1, 2 & 3: Lobby Level

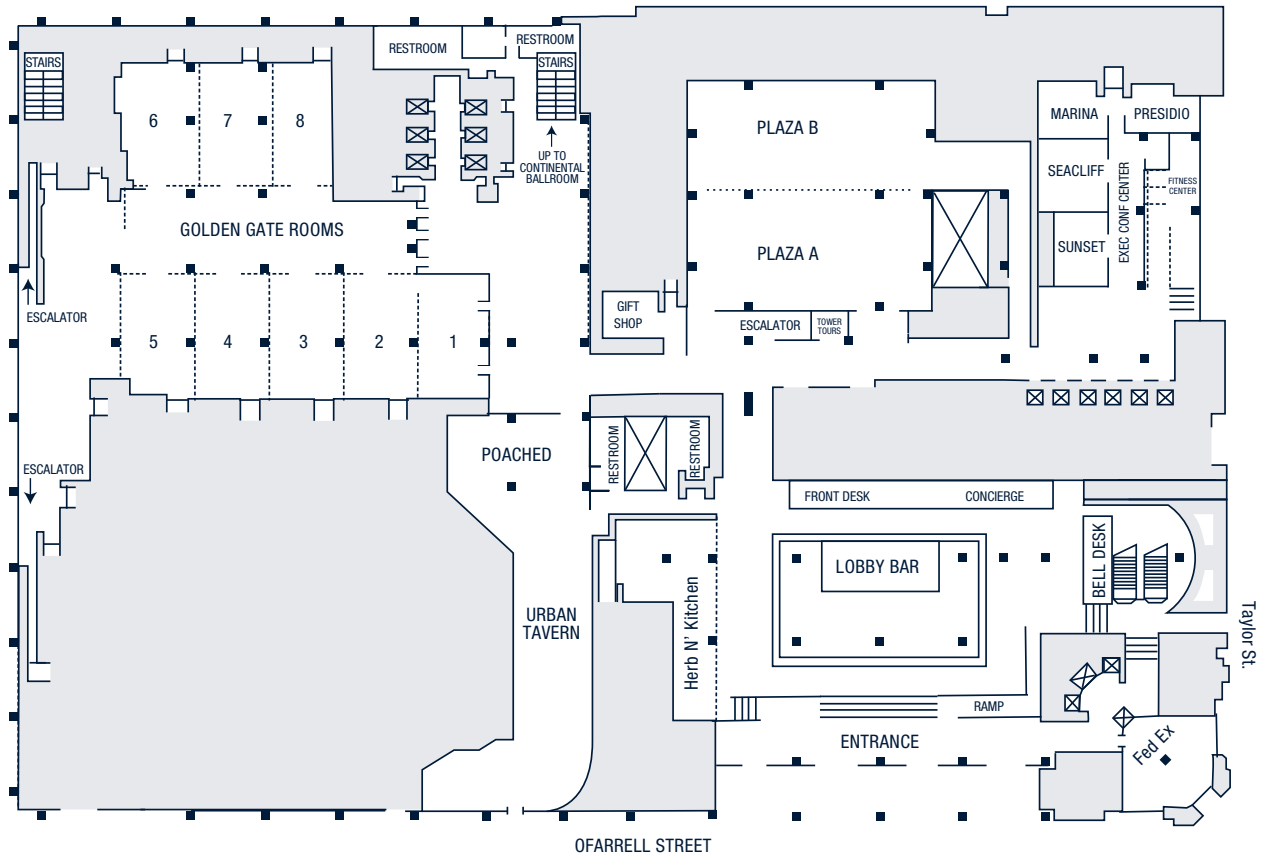

Tower 1, 2 & 3: Ballroom Level

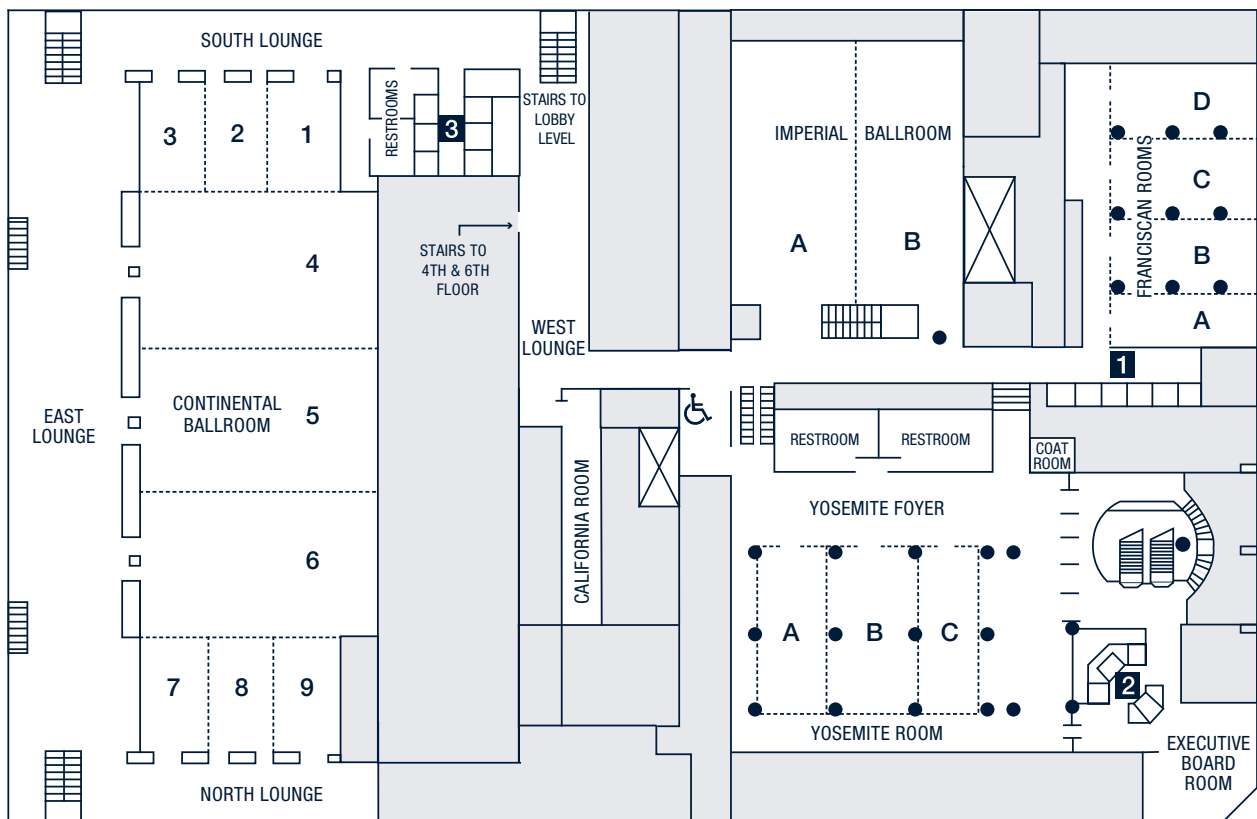

CONFERENCE FLOOR PLAN

Tower 2 - Grand Ballroom

