

SOCIETY FOR ACADEMIC CME **ANNUAL MEETING**

February 26 - March 1, **2019** | Charleston, SC

← The Medical Education Continuum →

HINDSIGHT INSIGHT FORESIGHT

M E E T I N G
B R O C H U R E

Society *for* ACADEMIC
Continuing Medical Education

LEADERSHIP • SCHOLARSHIP • COLLABORATION





Table of Contents

Welcome Message from the President	4
Welcome Message from the Chair, Program Committee	5
How to Claim CME Credit	6
SACME Board of Directors	7
SACME Past Presidents	8
Schedule of Events	9
Tuesday, February 26	9
Wednesday, February 27	10-14
Thursday, February 28	15-19
Friday, March 1	20-21
Meeting Floorplan	22
Keynote Speakers - Biosketches	23
Get Involved in SACME	24
Academy of Fellows of the Society for Academic Continuing Medical Education	25-26

SACME Meeting Wi-Fi Network: Francis Marion Meeting Password: 8071



Welcome to the 2019 SACME Annual Meeting **Hindsight, Insight, Foresight**



This year we welcome more than 200 of you to Charleston to explore vital issues of academic continuing medical education affecting medical schools, teaching hospitals and health systems, professional medical societies, publication/education companies, and others. We will take stock of what we have accomplished (hindsight), where we currently stand (insight), and examine opportunities for the future (foresight). In attending and interacting at the meeting's many offerings, we will better understand and prioritize the challenges and means for furthering scholarship and leadership in continuing professional development.

At this year's meeting, you will have more learning formats and engagements from which to choose. The many subjects cover a wide range of timely and critical topics facing our Society. Several keynote speakers, expert-led discussions, and thought-provoking panels will be interspersed between oral and poster research presentations from the largest number of abstract submissions. Several high-quality pre-conference workshops and skillset building sessions will emphasize the scholarly focus of our Society.

Networking and connecting with friends and colleagues in different disciplines have always distinguished our annual meetings. This year's meeting will have the most program participants, most institutions represented, and the most non-members in attendance. Plan to attend the Welcome Reception on Wednesday evening and the Wine and Cheese Party on Thursday evening, both held in the Colonial Ballroom. Enjoy great cuisine, historic sights, ocean scenery, and Southern charm which can best be found in Charleston.

Our hope is for this meeting to be a prime time for you to reflect and learn so that you feel more enlightened and invigorated to better integrate and lead at your institution in the days ahead!

William Rayburn, MD, MBA
President

Welcome from Program Chair

On behalf of the SACME Program Committee, welcome to our 2019 Annual Meeting. The program, the Medical Education Continuum: Hindsight, Insight, Foresight is rich with dynamic keynote speakers and varied learning formats including expert panelists, pre-conference workshops, SACME leadership insights, abstract presenters and poster presenters. We hope to accomplish our goal of ensuring a stellar and cutting-edge program.

Our theme aims to convey where we have been, where we are now, and where we will go, with careful thought to reflection and introspection in the field of continuing medical education. As importantly, coming together in Charleston gives us the opportunity to network, collaborate, develop, and foster friendships within our CPD community.

If you are new to SACME, please consider joining one of the open committee meetings, such as Scholarship, Communications, Membership, and Program Committees. Please be sure to visit the poster sessions and exhibit area as you network and connect with your colleagues.

Our conference attendees include over 200 registrants from all over the United States and Canada. Attendees consist of physicians, nurses, other healthcare professionals, medical education professionals, and researchers who share a common interest: strengthening their CME/CPD knowledge base and expanding their scholarship, research and leadership skills.

Finally, I would like to thank the Program Committee members and Bostrom, for their service and their commitment to our program. Working with this group has been my greatest pleasure as this year's Chair of the Program Committee.

Leticia Bresnahan, MBA, CHCP
Chair of Program Committee
Society for Academic Continuing Medical Education
Director, Office of Continuing Medical Education
Joe R. and Teresa Lozano Long School of Medicine
University of Texas Health Science Center at San Antonio



How to Claim CME Credit

Look for “Claim My CME Credit” on the left navigation bar of the Annual Meeting website (and also in the menu bar of the conference app).

From there, you will be asked to check which days and sessions you attended.

This form should only be completed once on your final day at the conference. After submitting your attendance, your credit certificate or certificate of attendance will be sent to the email you provide on the form. The form will be available until March 22.

Contact cme@ohsu.edu or call 503-494-8700 if you have any questions.

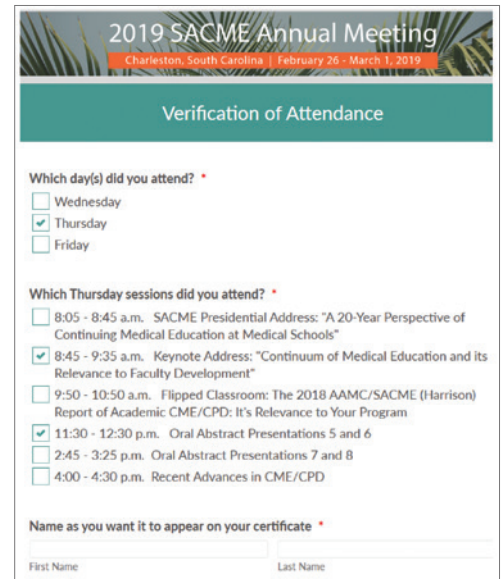

The screenshot shows the '2019 SACME Annual Meeting' header with the location 'Charleston, South Carolina' and dates 'February 26 - March 1, 2019'. Below this is a teal bar labeled 'Verification of Attendance'. The form contains two sections of checkboxes. The first section, 'Which day(s) did you attend?', has 'Wednesday' unchecked, 'Thursday' checked, and 'Friday' unchecked. The second section, 'Which Thursday sessions did you attend?', lists several sessions with checkboxes: '8:05 - 8:45 a.m. SACME Presidential Address: "A 20-Year Perspective of Continuing Medical Education at Medical Schools"' (unchecked), '8:45 - 9:35 a.m. Keynote Address: "Continuum of Medical Education and its Relevance to Faculty Development"' (checked), '9:50 - 10:50 a.m. Flipped Classroom: The 2018 AAMC/SACME (Harrison) Report of Academic CME/CPD: It's Relevance to Your Program' (unchecked), '11:30 - 12:30 p.m. Oral Abstract Presentations 5 and 6' (checked), '2:45 - 3:25 p.m. Oral Abstract Presentations 7 and 8' (unchecked), and '4:00 - 4:30 p.m. Recent Advances in CME/CPD' (unchecked). At the bottom, there is a section 'Name as you want it to appear on your certificate' with input fields for 'First Name' and 'Last Name'.

Accreditation

This activity has been planned and implemented in accordance with the accreditation requirements and policies of the Accreditation Council for Continuing Medical Education (ACCME) through the joint providership of OHSU School of Medicine and the Society of Academic Continuing Medical Education (SACME). The OHSU School of Medicine is accredited by the ACCME to provide continuing medical education for physicians.

Credit

OHSU School of Medicine designates this live activity for a maximum of 12.25 *AMA PRA Category 1 Credits™*. Physicians should claim only the credit commensurate with the extent of their participation in the activity.



2018-2019 SACME Board of Directors

President

William Rayburn, MD, MBA

President-Elect

Betsy Williams, PhD, MPH

Past President

Ajit Sachdeva, MD, FRCSC, FACS

Treasurer; Chair, Finance Committee

Joyce Fried, CHCP

Secretary

Tym Peters

Regional Representative, Canada

Sanjeev Sockalingham, MD, MHPE,
FRCPC(C)

Regional Representative, Central Region

Laura Werts, MS

Regional Representative, Northeastern Region

Allison Rentfro, PhD

Regional Representative, Southern Region

Bob Best, PhD

Regional Representative, Western Region

Leslie Doering

Chair, Communication Committee

Stacey Samuels, MA

Chair, Membership Committee

Linda Caples, MBA

Chair, Program Committee

Leticia Zuniga Bresnahan, MBA, CHCP

Chair, Scholarship Committee

David Wiljer, PhD

Chair, Strategic Affairs Committee

Barbara Barnes, MD

Executive Director

Katie Keel, MPA, CAE



SACME Past Presidents

2016

Ajit Sachdeva, MD, FACS, FRCSC, FSACME
American College of Surgeons

2015

Mary Turco, EdD
Geisel School of Medicine at Dartmouth

2014

Ginny Jacobs, MEd, MLS, CHCP
University of Minnesota Medical School

2013

Deborah Samuel, MBA
American Academy of Pediatrics

2012

Pam McFadden
University of North Texas Health Science Center

2012

Gordon West, PhD
Annenberg Center for Health Sciences at Eisenhower

2011

Gabrielle Kane, MB,EdD, FRCPC
University of Washington School of Medicine

2010

Todd Dorman, MD
Johns Hopkins University School of Medicine

2009

Lois Colburn
University of Nebraska Medical Center

2008

Melinda Steele, MEd
Texas Tech University Health Sciences Center

2007

Jocelyn Lockyer, PhD
University of Calgary

2006

Michael Fordis, MD
Baylor College of Medicine

2005

Martyn O. Hotvedt, PhD

2004

Craig M. Campbell, MD
Royal College of Physicians and Surgeons of Canada/ Le Collège royale des médecins et chirurgiens du Canada

Schedule of Events

Tuesday | February 26, 2019

9:00 AM - 5:00 PM	Registration Opens Registration Desk, Mezzanine/Meeting Level
	Pre-Conference Workshops
9:30 AM - 11:00 AM	1 - Curriculum Mapping to Broaden Scope and Impact of Your Continuing Professional Development Program Development Carolina A Heather A. Lochnan, MD, FRCPC – University of Ottawa
9:30 AM - 11:00 AM	2 - Qualitative Data and IPE: Assessing a Complex Educational Experience Carolina B Mary Grantner, MA, CHCP – Rush University Medical Center
11:15 AM - 12:45 PM	3 - Leveraging Technology for Effective Face to Face (F2F) Teaching Carolina A Heather MacNeill, MD, BSc(PT), MScCH (HPTE), FRCPC – University of Toronto
11:15 AM - 12:45 PM	4 - Utilizing CME Activity Evaluations to Enhance Education Calhoun Alisa Nagler, JD, MA, EdD – American College of Surgeons
11:15 AM - 12:45 PM	5 - Developing a Scholarly Approach to Conducting a Workshop Carolina B David Wiljer, PhD – University Health Network; Mary G. Turco, EdD – Dartmouth-Hitchcock Medical Center and Geisel School of Medicine at Dartmouth; Betsy Williams, PhD, MPH – Professional Renewal Center
1:00 PM - 3:00 PM	6 - Longitudinal Assessment: Roles in Continuing Certification and Continuing Professional Development Carolina A David Swanson, PhD – American Board of Medical Specialties
1:00 PM - 4:00 PM	8 - Scholarly Writing 101 Calhoun Savithiri Ratnapalan, MBBS, MEd, PhD(c), MRCP, FRCPC, FAAP – University of Toronto, Hospital for Sick Children
1:00 PM - 5:00 PM	9 - Enhancing Your Continuing Professional Development Program through Simulation Design Carolina B Stephanie Sliekers, MEd – Centre for Addiction and Mental Health; Asha Maharaj, MBA, CELP – Centre for Addiction and Mental Health; Sanjeev Sockalingam, MD, MHPE, FRCPC – Centre for Addiction and Mental Health
3:15 PM - 5:15 PM	7 - A Walk in the Digital Woods: A Workshop on Practice-Based Learning from Electronic Consultations Carolina A Douglas Archibald, PhD – University of Ottawa; Rachel E. Grant, BScN, MN, PhD(c) – Bruyère Research Institute
4:00 PM - 5:30 PM	GEA/CPD Meeting (Closed) Calhoun
5:00 PM - 6:00 PM	Regional Representative Meeting (Closed) Laurens
5:00 PM - 6:00 PM	Scholarship Committee Meeting (Closed) Rutlegde
6:00 PM - 8:00 PM	SACME Board Dinner & Meeting (Closed) Pinckney



Schedule of Events

Wednesday | February 27, 2019

7:00 AM - 5:00 PM	Registration Open Registration Desk, Mezzanine/Meeting Level
7:00 AM - 8:00 AM	Continental Breakfast Pre-Function
7:00 AM - 4:30 PM	Sponsor & Exhibitor Set-Up Pre-Function
7:00 AM - 8:00 AM	Finance Committee Meeting (Closed) Laurens
8:00 AM - 8:30 AM	SACME Presidential Welcome & Today's Program Overview Carolina A & B William F. Rayburn, MD, MBA, – University of New Mexico School of Medicine; Leticia Z. Bresnahan, MBA, CHCP – University of Texas Health Science Center at San Antonio
8:30 AM - 9:30 AM	Keynote Address: Professionalism across the Medical Education Continuum Carolina A & B Maxine Papadakis, MD – UCSF & San Francisco Veterans Administration Medical Center
9:30 AM - 10:45 AM	Addressing Lapses in Professionalism Across the Education Continuum Carolina A & B Maxine Papadakis, MD; Panelists: Don Moore, PhD, Vanderbilt University School of Medicine, Vanderbilt University; Betsy Williams, PhD MPH, Professional Renewal Center; Joyce Fried, CHCP, David Geffen School of Medicine at UCLA; Mary G. Turco, EdD, FSACME – Dartmouth-Hitchcock and Geisel School of Medicine at Dartmouth
10:45 AM - 11:00 AM	Break Pre-Function
11:00 AM - 12:15 PM	Concurrent Sessions SESSION A: Oral Abstract Presentations Best Practice: Helping Clinicians in Various Roles Carolina A Moderator: Todd Dorman, MD – Johns Hopkins School of Medicine Fostering the Development of Health Professions Education Scholars through Collaborative Learning & Practice Shari Whicker, EdD – Carilion Clinic/Virginia Tech Carilion School of Medicine Palliative and End-Of-Life Care Preceptorships: Sensitive Topic Education Done Sensibly Richard van Wylick, MD – Queen's University, Office of Professional Development and Educational Scholarship A Systems Thinking Approach to Enhancing Scholarly Activity Across the Medical Education Continuum Tricia C. Elliott, MD, FAAFP – JPS Health Network Valuing Perspectives: Streamlining CFPC and RCPSC Accreditation Requirements in a Single User-friendly Online Application Trevor Cuddy, BCom, BA, MEd, DBA – University of Toronto

Please note, the primary presenter(s) are listed below each presentation in the printed program book by name and organization only. Additional information on presenters and other contributors can be found on the event website or on the app.

Schedule of Events

Collaboration to Increase Value: For Learners, Academic Programs, and CPD

Christine Flores, MPH – Oregon Health & Science University

SESSION B: Oral Abstract Presentations | Best Practice: Using Technology in CME/CPD

Carolina B

Moderator: Olivier Petinaux, MS – American College of Surgeons

Rethinking CPD: Building a Simulation Program Through Collaboration

Martin Tremblay, PhD – Fédération des médecins spécialistes du Québec

Using an Online Web Based Blog to More Timely Deliver Research Publication and Create A Professional Community of Discussion for Emergency Room Healthcare Providers

Leticia Z. Bresnahan, MBA, CHCP – University of Texas Health Science Center at San Antonio

Impact of Acute Care Physician's Age on Crisis Management Performance and Learning after Simulation-based Education

Fahad Alam, BHSC, MD, FRCPC – University of Toronto

Applying a Microlearning Concept to Enhance Faculty's Teaching Technology Skills

Shari Whicker, EdD – Carilion Clinic/Virginia Tech Carilion School of Medicine

12:15 PM - 1:20 PM

Networking Lunch - Meet Your Regional Representatives and Colleagues

Carolina A & B

12:20 PM - 1:20 PM

Communication Committee (Open)

Pinckney

1:20 PM - 2:25 PM

Poster Presentations Session #1 w/ Lightning Rounds

Colonial

Moderator: Mary Turco, EdD – Geisel School of Medicine at Dartmouth

A Gap Analysis of Opioid Prescribing Highlighting Inter-Professional Disparities: Scope of the Epidemic, Risk Reduction, and Clinical Practice Standards

Robert J. Birnbaum, MD, PhD – Partners Healthcare, Professional Development & Implementation Science; Nicole M. Clark –Partners HealthCare

ABC's of Diabetes

Theresa Barrett, PhD – NJAFP

Beyond the Blues: A Major Depressive Disorder Quality Improvement for Primary Care

Theresa Barrett, PhD – NJAFP

Can We Measure Meaningful Outcomes?: Commitment Cards to Assess Practice Change Following a Medical Education CME Conference

Megan A. Koster, MD, PharmD – Massachusetts General Hospital, Pulmonary & Critical Care Medicine Fellowship

Common to Complex - Project ECHO: Pediatric Depression

Laura Werts, MS, MEd, CMP – Cincinnati Children's Hospital Medical Center

Please note, the primary presenter(s) are listed below each presentation in the printed program book by name and organization only. Additional information on presenters and other contributors can be found on the event website or on the app.



Schedule of Events

Wednesday | February 27, 2019 | *Continued*

Educating Providers About Patient-Directed Mobile Applications for Improved Pregnancy Monitoring

William F. Rayburn, MD, MBA, – University of New Mexico School of Medicine

Knowledge and Implementation of Current Opioid Guidelines Among Health Care Providers

Diana C Sanchez Ramirez, PhD, MPH, PT – Rady Faculty of Health Sciences

Patient Simulation Leads to Significant Learner Behavior Change When Diagnosing and Treating Women With Chronic Pelvic Pain

Jacob I. Cohen – MedSims

Predictive Modeling to Identify Educational Needs for Primary Care to Close the Gap in Spirometry Use in Chronic Obstructive Pulmonary Disease

Katie Stringer Lucero, PhD – Medscape, LLC

Promoting Opioid Use Monitoring Strategies in Rural Primary Care Settings Through Academic Detailing Interventions

Odessa B. Ussery, MEd CHCP – Medical University of South Carolina

Road to Improvement: Our Dashboard Journey

Laura Werts, MS, MEd, CMP – Cincinnati Children's Hospital Medical Center

Safe and Competent Opioid Prescribing Education (SCOPE of Pain): The Effect of Mandatory Education on CME Outcomes

Julie L. White, MS, CHCP – The Barry M. Manuel Continuing Medical Education Office, Boston University School of Medicine; Sophie Peloquin, MMedSc – AXDEV Group

Standardized Search of the Medical Literature for Scholarly Publications Cited in CE News

William F. Rayburn, MD, MBA, – University of New Mexico School of Medicine

The Emory Quality Academy: Using Continuing Medical Education to Fuel Improvement

Nathan Spell, MD – Emory University School of Medicine

2:25 PM - 3:25 PM

CONCURRENT SESSIONS

SESSION A: Oral Abstract Presentations | Best Practice: Real World Issues, Needs & Wants.....

Carolina A
Moderator: Joseph Szot, MD – University of Iowa Carver College of Medicine

'They Never Asked' A Symposium Driven by Demand

Stacy Sattovia, MD MBA – Southern Illinois University School of Medicine

Pigs' Feet and Oranges: Small Group Practical Learning of Basic Dermatological Procedures for Primary Care Providers

Richard van Wylick, MD – Queen's University, Office of Professional Development and Educational Scholarship

Please note, the primary presenter(s) are listed below each presentation in the printed program book by name and organization only. Additional information on presenters and other contributors can be found on the event website or on the app.

Schedule of Events

Free Lessons! Incident Learning from Near-Miss Events

Gabrielle Kane, MB EdD FRCPC – University of Washington

Use of a Mobile Device Audience Response System To Achieve Scored, Identified Assessments during Surgery M & M, for participants' self-reported MOC

Rob Martin, MBA, CHCP, CPHIMS – NYU Winthrop Hospital

SESSION B: Oral Abstract Presentations I Quality/Performance Improvement.....Carolina B Mary G. Turco, EdD, FSACME – Dartmouth-Hitchcock and Geisel School of Medicine at Dartmouth

What Happens When You Combine Morbidity and Mortality Conferences, Quality Improvement, and Grand Rounds?

Jennifer Alessi, MA, CHCP – St. Jude Children's Research Hospital

Improving Imaging Utilization Efficiency: A QI/CPD Collaboration

Reema Mustafa, MPH – UT Southwestern Medical Center Office of Continuing Medical Education

Quality Improvement by Design: Building Capacity for Continuous Performance Improvement by Engaging Health Care Professionals in an Innovative Learning Lab

Mila Kostic, CHCP, FACEHP – Penn Medicine, University of Pennsylvania

Control Charts: Aligning Quality with Maintenance of Certification

Christine Flores, MPH – Oregon Health & Science University; Nels L. Carlson, MD – Oregon Health & Science University, School of Medicine; Kenneth Devane, MS, MBA – Oregon Health & Science University, School of Medicine

3:25 PM - 3:45 PM

BreakPre-Function

3:45 PM - 4:45 PM

Poster Presentations Session #2 w/ Lightning Rounds.....Colonial
Moderator: Mila Kostic, CHCP, FACEHP – Penn Medicine, University of Pennsylvania

Assessing the Educational Needs of the Urologic Healthcare Team Managing Patients with Bladder Cancer

Shelby Englert – American Urological Association

Campus-wide Unconscious Bias training: How CME played a role in achieving an ambitious training goal

Christine Flores, MPH – Oregon Health & Science University

Can Journal Clubs Enhance Quality and Practice Improvement?

Helena Filipe, MD – Hospital das Forças Armadas/PL-EMGFA

Development and Evaluation of Continuing Professional Development (CPD) Program about Technological Innovations in Prostate Cancer Radiation Therapy

Ewa F. Szumacher, MD, FRCP, MEd – Department of Radiation Oncology University of Toronto

Empowering Pathologists and Lab Professionals as Change Agents for Quality Improvements in Immuno-oncology

Joseph Kim, MD, MPH, MBA – Q Synthesis LLC

Please note, the primary presenter(s) are listed below each presentation in the printed program book by name and organization only. Additional information on presenters and other contributors can be found on the event website or on the app.



Schedule of Events

Wednesday | February 27, 2019 | *Continued*

How Are New Technologies Affecting Patient Health?

Patty Peterson – @Point of Care

Life-Long Learning Foundations: Continued Advancement of Research and Scholarly Activity Through the RESQIPS Framework

Debra Schneider, MEd, MLIS – HonorHealth

Obesity Intervention for Front-line Healthcare Providers

Diana C Sanchez Ramirez, PhD, MPH, PT – Rady Faculty of Health Sciences

Patient Partnership Practices in CME: An Innovative Initiative Involving Dialysis Patients at SUNY Downstate

Edeline Mitton, MEd – SUNY Downstate Medical Center

Pediatric Critical Care Simulation: Innovation and Best Practices

Vallerie Kolasinski, MPH CHES – The Permanente Medical Group

The Implementation of an Enduring Hypertension Education Series Targeting High Risk Rural Underserved Populations

Daniel Lackland, DrPH – Medical University of South Carolina

Using the Other Category to Provide Continuing Medical Education Credit for Trauma Education Based on Performance Improvement Data

Terry Liddell, RN, MICN – Dignity Health St. Mary Medical Center

Weathering the Storm: Best Practices Learned from Hurricane Cancellations

Victoria Clifton, MLIS, ELS – Mayo Clinic

Patient and Family Advisors: Raising the Bar in Clinical Education Strategy and Oversight

Monica Bourke, MSN, RN – Sutter Health

4:45 PM - 5:45 PM

Gender in Medical Education (GiME) Special Interest Group (SIG) Laurens
Mary G. Turco, EdD, FSACME – Dartmouth-Hitchcock and Geisel School of Medicine at Dartmouth

4:45 PM - 6:15 PM

Academy of Fellows Meeting (Closed) Pinckney

5:30 PM - 7:00 PM

SACME Welcome Reception with Exhibitors Gold Ballroom/Second Floor

Please note, the primary presenter(s) are listed below each presentation in the printed program book by name and organization only. Additional information on presenters and other contributors can be found on the event website or on the app.

Schedule of Events

Thursday | February 28, 2019

7:00 AM - 8:00 AM	Continental Breakfast & Exhibits Open Pre-Function
7:00 AM - 8:00 AM	Membership Committee Meeting (Open) Pinckney
7:00 AM - 8:00 AM	Strategic Affairs Committee Meeting (Closed) Laurens
8:00 AM - 8:05 AM	Today's Program Overview Carolina A & B
8:05 AM - 8:45 AM	SACME Presidential Address: Hindsight about Continuing Medical Education at U.S. Medical Schools: What Have We Learned? Carolina A & B William F. Rayburn, MD, MBA – University of New Mexico School of Medicine
8:45 AM - 9:35 AM	Barbara Barnes Plenary Keynote Address: Continuum of Medical Education and its Relevance to Faculty Development Carolina A & B Alison Whelan, MD – Association of American Medical Colleges
9:35 AM - 10:35 AM	Flipped Classroom: The 2018 AAMC/SACME (Harrison) Report of Academic CME/CPD: Its Relevance to Your Program Carolina A & B Moderator: Alison Whelan, MD – Association of American Medical Colleges Panelist: Barbara E. Barnes, MD – University of Pittsburgh Panelist: Morris J. Blachman, PhD, MA – University of South Carolina School of Medicine and Palmetto Health Panelist: Carla Schroedl, MD MS – Northwestern University Feinberg School of Medicine
10:35 AM - 11:30 AM	Break & Exhibit Hall Open Pre-function
11:30 AM - 12:30 PM	CONCURRENT SESSIONS SESSION A: Oral Abstract Presentations Quality/Performance Improvement Carolina A Moderator: Suzanne Ziemnik, MEd – American Society for Clinical Pathology Wound Care Continuing Professional Development and Bootcamps: Interprofessional before it was cool Karen Smith, MD, FRCPSC – Office of Professional Development and Education Scholarship, Queen's University; Jolene Heil Improving Patients' Outcomes Through Better Screening, Treatment and Follow-up of Lung Cancer Martin Tremblay, PhD – Fédération des médecins spécialistes du Québec Facilitating Reflection and Improving Performance in Treating Upper Limb Spasticity Annette Schwind, MS, CHCP – Paradigm Medical Communications, LLC



Schedule of Events

Thursday | February 28, 2019 | Continued

Understanding the Relationships Among Self-efficacy, Burnout, and Insight in Developing an Effective CME Opportunity

Dillon Welindt, BS – Wales Behavioral Assessment; Betsy Williams, PhD, MPH – Professional Renewal Center

SESSION B: Oral Abstract Presentations | Research in CME/CPD:

Guidelines, Funding & Burnout..... Carolina B
Moderator: Bob Best, PhD, Greenville Health System

Stand Up and Be Counted Too: Arthritis Care Practitioners Tell Us What Counts for Their Advanced Continuing Professional Development in Canada

Morag Paton, MEd, PhD – University of Toronto

Exploring Clinical Care Among Patients with Type 2 Diabetes: Alignment with Clinical Practice Guidelines and Choosing Wisely Recommendations

Diana C Sanchez Ramirez, PhD, MPH, PT – Rady Faculty of Health Sciences

Evaluating Predictors of Successful Funding to an Education Development Grant: The Role of the Person and the Project

Morag Paton, MEd, PhD – University of Toronto

12:30 PM - 1:45 PM

"Learn at Lunch" and Exhibits Open Carolina B & Pre-Function

Learn at Lunch Topics:

1. Fee Schedules for CME/CPD Activities, Don Moore, PhD
2. Serving on a SACME Committee, Annette Donowa, PhD
3. Comparing Your CME Activities with Other Accredited CME Providers, Ron Ben Ari, MD
4. Recognizing Community Faculty for Teaching Our Students and Residents, Dan Lackland, DrPH
5. Guidelines for Maintenance of Certification in Each Medical and Surgical Specialty, David Price, MD
6. Simulation is for trainees, not practicing physicians. True or false? Randall Steadman, MD, MS
7. Technology Committee Forum, Dena Silva
8. Meaning of CPD, Alison Rentfro, PhD
9. Commendation Criteria, Ellen Seaback, CHCP
10. Shifting Institutional Culture/Leading Change, Bob Best, PhD & Morris Blachman, PhD
11. How could we use the SACME listserv better, Bruce Nitsche, MD & Leslie Doebling
12. Mentoring SACME Members, Jack Kues, PhD

12:30 PM - 1:45 PM

Virtual Journal Club Editorial Board Meeting (Closed) Laurens

1:45 PM - 2:45 PM

Poster Presentations Session #3 w/ Lightning Rounds..... Colonial
Moderator: Kimberly Northrip, MD, MPH, University of Kentucky Healthcare CECentral

A Needs Assessment to Support Implementation of the Electronic Medical Record (EMR) in Newfoundland and Labrador, Canada

Lisa J. Fleet, MA, Dip Ad Ed, BEd – Memorial University

A Novel Adaptive e-Learning Product Helping General Internists Pass Their ABIM IM-MOC Exam

Michael G. Healy, EdD – Department of Surgery, Massachusetts General Hospital, Harvard Medical School and NEJM Group

Schedule of Events

An Application of Educational Theory to Enhance Physician Engagement in a PI/QI-CME Activity.

Gary C. Bird, PhD – American Academy of Family Physicians

Can Social Media and Other Patient-Generated Data Play a Role in Planning and Implementing CME Programs?

Steven Haimowitz, MD – RealCME

Conceptualization of Competency-Based Medical Education, Competency, and Competence within the CPD/CME and Residency Family Medicine Educational Literature

Heather A. Lochnan, MD, FRCPC – University of Ottawa

Effect of the Pause Procedure on Reflection and Behavior Change in Conference-Based Continuing Medical Education: A Randomized Controlled Trial

John T. Ratelle, MD – Mayo Clinic

Incorporating Qi into a Blended Learning Program: The Primary Care Obesity Certificate Management Program

Eric D. Peterson, EdM, FACEHP, CHCP – AAPA; Sophie Peloquin, MMedSc – AXDEV Group

KY LEADS: Innovative and Collaborative Approaches to Research Through CPD Best Practices

Kimberly D. Northrip, MD, MPH, FAAP – CECentral and the University of Kentucky College of Medicine

Making Cents of CME Funding

Alisa Nagler, JD, MA, EdD – American College of Surgeons

Medical Assistance in Dying: A Resource Library for Practitioners

Richard van Wylick, MD – Queen's University

More than a Thank You: Aligning CME Speaker Evaluations with Promotion & Tenure Requirements

Christine Flores, MPH – Oregon Health & Science University

Use of Simulation to Expand Access to Care for Victims of Sexual Assault

Stacy Sattovia, MD MBA – Southern Illinois University School of Medicine

2:45 PM - 3:45 PM

CONCURRENT SESSIONS

SESSION A: Oral Abstract Presentations | Research in CME/CPD:

Addressing the Opioid Crisis.....Carolina A

Moderator: Sanjeev Sockalingam, MD, MHPE, Centre for Addiction and Mental Health

Army and Navy ECHO Pain Telementoring Improves Clinician Opioid Prescribing for Military Patients: An Observational Cohort Study

Joanna G. Katzman, MD, MSPH – UNM School of Medicine/The ECHO Institute

Answering the Call: A Controlled Substance Prescribing Series

Vickie M. Skinner, DHA – University of Mississippi Medical Center



Schedule of Events

Thursday | February 28, 2019 | *Continued*

Addressing the Opioid Crisis: Evaluating the Safer Opioid Prescribing Program (SOP)

Morag Paton, MEd, PhD – University of Toronto

SESSION B: Oral Abstract Presentations | Research in CME/CPD:

Scholarship & LearningCarolina B

Moderator: Robert Malcolm, MD – Medical University of South Carolina

Charting a path to scholarship in Continuing Professional Development

Morag Paton, MEd, PhD – University of Toronto

A Novel Method for Measuring Learner Engagement in CME

Chris Stephenson, MD – Mayo Clinic

An innovative multi-method approach to assess perceived and unperceived needs of practicing physicians in the province of Quebec: A comparison study

Francesca Luconi, Bach, MA, PhD – McGill University

A Time/Cost Analysis of Multiple CME Activities: Making the Value-Added Case for CME Services

Ryan Spaulding, PhD – University of Kansas Medical Center

3:45 PM - 4:00 PM

Break & Exhibits OpenPre-Function

4:00 PM - 4:30 PM

General Session: Recent Advances in CME/CPDCarolina A & B

Craig Campbell, MD, FRCPC – Royal College of Physicians and Surgeons of Canada

4:30 PM - 5:30 PM

Poster Presentations Session #4 w/ Lightning Rounds | Wine & Cheese ReceptionColonial

Moderator: Gabrielle Kane, MB, EdD, FRCPC – University of Washington School of Medicine

A Geo-Targeting Approach to Planning Migraine Education for Non-Academic Neurologists

Lilia Zurkovsky, PhD – Forefront Collaborative; Marianna Shershneva, MD, PhD – Forefront Collaborative

Adaptive CPD: Impact of Medical Marijuana on Pain and Opioids Cohort Trial (IMMPACT study)

William F. Rayburn, MD, MBA – University of New Mexico School of Medicine

Advancing Alignment of Physician Well-Being Initiatives with Continuing Certification Programs

Susie Flynn, BS – American Board of Medical Specialties

An Exploratory Study of Best Practices for Facilitating Physician Work/Life Balance in Newfoundland and Labrador, Canada

Lisa J. Fleet, MA, Dip Ad Ed, BEd – Memorial University

Connecting Social Cognitive Data to Performance Change: Methods, Results and Implications

Betsy Williams, PhD, MPH – Professional Renewal Center; Mary G. Turco, EdD, FSACME – Dartmouth-Hitchcock and Geisel School of Medicine at Dartmouth

Schedule of Events

Education in Change and Change Management

Savithiri Ratnapalan, MBBS, MEd, PhD(c), MRCP, FRCPC, FAAP – University of Toronto, Hospital for Sick Children

I Think, Therefore I AM Biased – and How Reflecting on Our Ontological and Epistemological Positions Can Improve Our Research

Vjekoslav Hlede, DVM, CHCP – Lancaster University

Impact of Environmental Health Education on Healthcare Professionals

Jesia L. Boykin, BBA – Texas Tech University Health Sciences Center El Paso Paul L. Foster School of Medicine

Improve Your Data Collection and Reporting Process During Pre and Post Activity Phases

Jason Daiger – Attendee Interactive

Improving Communication Skills to Enhance Resiliency

Trisha Veenema – University of Utah, School of Medicine; M. Sheetz, MD – University of Utah

Rising Trend of Clinician Educators Among Faculty at U.s. Medical Schools

William F. Rayburn, MD, MBA – University of New Mexico School of Medicine

Role of Project Echo in Quality Improvement: Data from Mental Health and Addictions

Sanjeev Sockalingam, MD, MHPE, FRCPC – Centre for Addiction and Mental Health

Strength in Numbers: Using group peer review model to enhance the quality of national grant review process

Shari Whicker, EdD – Carilion Clinic/Virginia Tech Carilion School of Medicine

5:30 PM - 6:30 PM

Academy of SACME Fellows (Mentoring/Closed Session)Pinckney

5:30 PM - 6:30 PM

Program Committee (Open)



Schedule of Events

Friday | March 1, 2019

7:00 AM - 7:50 AM	Continental BreakfastPre-Function
7:00 AM - 7:50 AM	Portfolio Sponsor Interest Group Community of Practice (Open)Rutledge
7:00 AM - 7:50 AM	Scholarship Committee Meeting (Open)Laurens
7:50 AM - 7:55 AM	Today's Program OverviewCarolina A & B
7:55 AM - 8:55 AM	CONCURRENT SESSIONS: Skill Set Building Communities of Practice: Building skills to help clinical teams explore strategies to continuously improve practice.Carolina A & B John Parboosingh, MBCHB – University of Calgary, Canada Fostering Scholarship in CPDPinckney David Wiljer, PhD – University Health Network, Centre for Addiction and Mental Health, University of Toronto; Mary G. Turco, EdD, FSACME – Dartmouth-Hitchcock and Geisel School of Medicine at Dartmouth; Dave Davis, MD – University of Toronto; Betsy White. Williams, PhD MPH – Professional Renewal Center Obtaining Quality Improvement Data at My Institution to Incorporate in CME Activity PlanningCalhoun Rob Armstrong Martin, MBA, CHCP, CPHIMS – NYU Winthrop Hospital
8:55 AM - 9:55 AM	Manning Award Winner PresentationsCarolina A & B Understanding the Relationship Between Data-Informed Learning & Orientation to Lifelong Learning Sanjeev Sockalingam, MHPE, MD, FRCPC – Centre for Addiction and Mental Health; David Wiljer, PhD – University Health Network Supporting Self-Directed Learning and Transfer through Testing in Continuing Medical Education Mark Feldman, MD, FRCPC – University of Toronto & The Hospital for Sick Children and Saint Joseph's Health Centre
9:55 AM - 10:10 AM	BreakPre-Function
10:10 AM - 11:10 AM	Programs of the Academy of SACME FellowsCarolina A & B Ajit K. Sachdeva, MD, FRCSC, FACS – Past President, Society for Academic CME; Barbara E. Barnes, MD – University of Pittsburgh; Don Moore, PhD – Vanderbilt University School of Medicine, Vanderbilt University Medical Center; John Parboosingh, MBCHB – University of Calgary; Jack R. Kues, PhD, CHCP, FACEHP – University of Cincinnati College of Medicine

Schedule of Events

11:10 AM - 12:10 PM	Annual Updates from Accreditation Council for Continuing Medical Education (ACCME); Journal of Continuing Education for Health Professionals (JCEHP); and Virtual Journal Club (VJC) Carolina A & B Graham McMahon, MD, MMSc – Accreditation Council for Continuing Medical Education; Simon Kitto, PhD – University of Ottawa; Mila Kostic, CHCP, FACEHP – Penn Medicine, University of Pennsylvania
12:10 PM - 1:10 PM	Lunch and Annual SACME Business Meeting Carolina A & B
1:10 PM - 2:10 PM	Keynote Address: Continuum of Medical Education and the Role of CME/CPD Carolina A & B David P. Sklar, MD – UNM School of Medicine
2:10 PM - 2:40 PM	Town Hall Meeting with the Editors Carolina A & B Moderator: Linda D. Caples, MBA –The Medical College of Wisconsin Panelists: Simon Kitto, PhD – University of Ottawa; David P. Sklar, MD – UNM School of Medicine
2:40 PM - 2:55 PM	Awards Presentation Carolina A & B
2:55 PM - 3:00 PM	Annual Meeting Close Carolina A & B



Meeting Floorplan

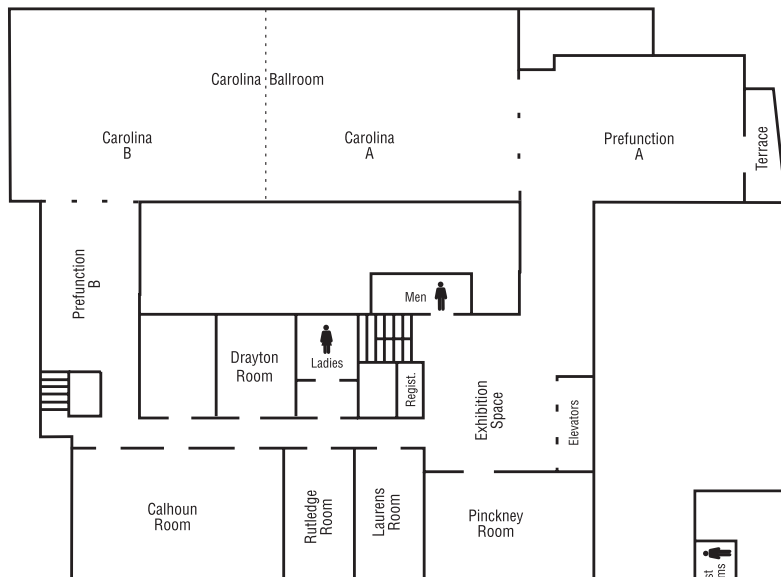

Mezzanine/Meeting Level

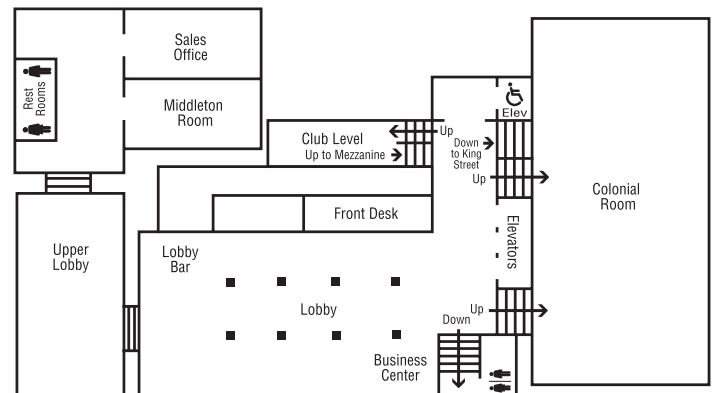

The Colonial Room/Lobby Level

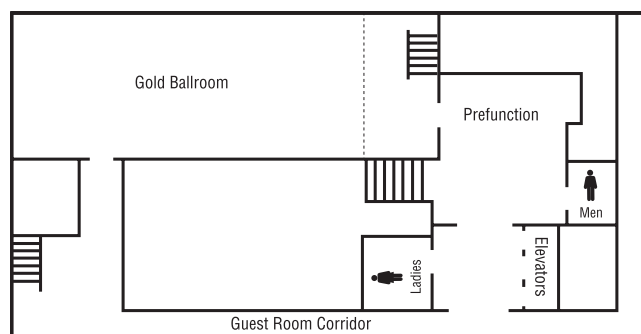

The Gold Ballroom/Second Floor

Biosketches



Maxine A. Papadakis, MD

**Professor of Medicine, Emeritus, UCSF and a practicing internist
San Francisco Veterans Administration Medical Center**

Maxine A. Papadakis, MD is a UCSF Professor of Medicine, Emeritus. She was the Associate Dean for Students in the School of Medicine at UCSF and a leading investigator in the field of professionalism. In a series of ground-breaking studies in collaboration with the Federation of State Medical Boards and the American Board of Internal Medicine, Dr. Papadakis linked long term outcomes of disciplinary action against physicians by licensing boards to performance of physicians during their training. She further advanced the field by describing the types of unprofessional behavior that are linked with disciplinary action. Dr. Papadakis is the recipient of numerous awards, including the John P. Hubbard Award from the National Board of Medical Examiners and the Distinguished Alumni Award from the University of Cincinnati College of Medicine. She is also an editor on the annually published Current Medical Diagnosis and Treatment. Upon her retirement from UCSF, the School created the Maxine Papadakis Awards to recognize faculty who are exemplars in treating students and all others in the clinical environment with professionalism, courtesy and respect.



David P. Sklar, MD

**Distinguished Professor, Department of Emergency Medicine & Internal Medicine
UNM School of Medicine**

Dr. David Sklar is a Professor in the College of Health Solutions and Advisor to the Provost at Arizona State University and Editor in Chief of Academic Medicine. He is also Distinguished Professor and Associate Dean Emeritus at University of New Mexico where he was a Chair of Emergency Medicine, Associate Dean and DIO for Graduate Medical Education and Associate Dean for Clinical Affairs.

Dr. Sklar received his medical degree at Stanford University and did an internal medicine residency at the University of New Mexico and an emergency medicine Fellowship at the University of California in San Francisco. He was on the faculty of the school of medicine at the University of New Mexico for 37 years teaching, providing patient care and doing research.

His main areas of interest in research have concerned injury prevention, medical education, health policy and ethics. He is particularly interested in how medical education can transform the health care delivery system to provide better health and lower costs. He has published over 200 hundred articles in the medical literature as author or co-author.

He served in the Senate Finance Committee as part of an RWJF Health Policy Fellowship in 2011 and 2012 and worked on the Affordable Care Act, physician payment and graduate medical education. Upon completion of the fellowship, he was chosen as Editor in Chief of Academic Medicine, the leading journal in health professions education.



Alison Whelan, MD

**Chief Medical Education Officer
Association of American Medical Colleges (AAMC)**

As Chief Medical Education Officer, Alison J. Whelan, MD, leads AAMC initiatives to transform the current models of education and workforce preparation across the full continuum of medical education. She also directs AAMC efforts that support medical education officers, regional campuses, education researchers, students, and residents. Prior to joining the association in 2016, Dr. Whelan had been a member of the faculty at Washington University School of Medicine since 1994. In 1997, she was appointed associate dean for medical student education and in 2009 was appointed senior associate dean for education. During her tenure, Dr. Whelan coordinated the creation of the Practice of Medicine curriculum and led the planning for the school's new education building and the creation of the Center for Interprofessional Education. Dr. Whelan received her bachelor's degree from Carleton College in 1981. She earned her medical degree from Washington University in 1986 and completed her postgraduate work and residency at the former Barnes Hospital, now Barnes-Jewish Hospital.



Get Involved in SACME

The following ancillary meetings are open to any SACME member interested in supporting our organization. Like many membership organizations, much of the work of the society is completed by the volunteers. We are most grateful for your service and look forward to seeing you there!

Day 2: Wednesday, 2.27.19

12:20 – 1:20 pm Communications Committee, Pinckney Room

4:45 – 5:45 pm Gender in Medical Education (GiME) SIG, Laurens Room

Day 3: Thursday, 2.28.19

7:00 – 8:00 am Membership Committee, Pinckney Room

5:30 – 6:30 pm Program Committee (Open), XXX Room

Day 4: Friday, 3.1.19

7:00 – 7:50 am Portfolio Sponsor Interest Group Community of Practice (Open), Rutledge Room

7:00 – 7:50 am Committee (Open), Laurens Room



Academy of Fellows of the Society for Academic Continuing Medical Education

Established 2017

Overarching Goals

The overarching goals of the new Fellowship of the Society for Academic Continuing Medical Education (SACME) are to recognize preeminent CME/CPD leaders of national and international renown for their seminal contributions, and to create a vibrant community of thought leaders through establishment of the new Academy of Fellows of SACME. The Academy was established in 2017 when the initial cohort of Fellows of SACME was inducted at the Annual SACME Meeting in Scottsdale, Arizona. This Academy of SACME Fellows serves as a think-tank to define megatrends in CME/CPD for the future; shape future directions of the field of CME/CPD; proactively address a range of national and international imperatives through innovation and creativity; and provide mentorship to aspiring leaders in the field of CME/CPD.

This Academy recognizes the past accomplishments of the renowned CME/CPD leaders and establishes mechanisms for them to continue making noteworthy contributions in the future. Individuals inducted into this Academy are able to use the initials FSACME after their names, in recognition of this high accomplishment and recognition.

Gloria Allington, MS Ed, FSACME
Barbara Barnes, MD, MS, FSACME
Morris J. Blachman, PhD, FACEHP, FSACME
Craig Campbell, MD, FSACME
Lois Colburn, FSACME
Robert Cullen, PhD, FSACME
Dale Dauphinee, MD, FSACME
Dave Davis, MD, FSACME
Nancy Davis, PhD, FSACME
Todd Dorman, MD, FSACME
William Easterling, Jr., MD, FSACME
Gerald Escovitz, MD, FSACME
Helena P. Filipe, MD, MSc, FSACME
Michael Fordis, MD, FSACME
Meryl Haber, MD, FSACME
Professor Ronald M. Harden, OBE, MD, FRCP (GLAS), FRCS (ED), FRCPC, FSACME
R. Van Harrison, PhD, FSACME
Martyn Hotvedt, PhD, FSACME
Ginny Jacobs, MEd, MLS, CHCP, FSACME

Gabrielle Kane, MB, EdD, FRCPC, FSACME
Martin Kantrowitz, MD, FSACME
John Kues, PhD, FSACME
Paul Lambiase, FSACME
James Leist, EdD, FSACME
Jocelyn Lockyer, PhD, FSACME
Phil Manning, MD, FSACME
Jack Mason, PhD, FSACME
Paul E. Mazmanian, PhD, FSACME
Pam McFadden, FSACME
Graham T. McMahon, MD, MMSc, FSACME
Don Moore, PhD, FSACME
Curtis Olson, PhD, FSACME
John T. Parboosingh, MB, FRCSC, FSACME
Ajit K. Sachdeva, MD, FACS, FRCSC, FSACME
Deborah Samuel, MBA, FACEHP, FSACME
Joan Sargeant, PhD, FSACME
Melinda Steele, MEd, CHCP, FACEHP, FSACME
Mary Turco, EdD, FSACME
Dennis Wentz, MD, FSACME

Academy of Fellows of the Society for Academic Continuing Medical Education

Steering Committee of the Academy of SACME Fellows

Ajit K. Sachdeva, MD, FACS, FRCSC, FSACME (Chair, Academy of Fellows of the Society for Academic CME)

Barbara Barnes, MD, MS, FSACME*

Morris J. Blachman, PhD, FACEHP, FSACME

Dave Davis, MD, FSACME

John Kues, PhD, FSACME**

Paul E. Mazmanian, PhD, FSACME

Don Moore, PhD, FSACME

Joan Sargeant, PhD, FSACME

* Chair, Subcommittee for the SACME National Certificate Program for CPD Leaders

** Chair, Subcommittee for SACME National Mentorship Program

New Fellow of Sacme and Member of the Academy to be Inducted at the 2019 Annual Sacme Meeting

David W. Price, MD, FAAFP, FACEHP





Driving toward a higher level of patient care?

Pick up your pace with Premier®.

Visit our booth and talk to experts about how we can accelerate your learning and education efforts and for a chance to win a Nintendo Switch™.

PremierInc.com

© 2019 Premier Inc.
All rights reserved.

CloudCME®

THE CE BUSINESS PLATFORM
YOU WON'T OUTGROW

<http://cloud-cme.com>



2020 SACME ANNUAL MEETING

February 18 - 21, 2020



Miami, FL | Miami Marriott Biscayne Bay