



# Transportation Options to the NorCal Spring into TDM Summit Thursday, April 16<sup>th</sup>

**Bishop Ranch Roundhouse**  
**Tenaya Conference Room**  
**2600 Camino Ramon, Suite 100**  
**San Ramon, CA 94583**

**Trip planner** – This tool can be used even if you don't plan on taking BART.

<https://www.bart.gov/planner>

The red star marks the summit location.



## Bike Parking –

Store your bike in the Bishop Ranch Bike Shop, located at 2600 Camino Ramon and accessible through the Roundhouse Gym. Secure your bike safely with your own lock and use our free lockers (wait list applies). Register ahead of time.

<https://tenants.bishopranch.com/connect/support-forms/bicycle-room-access-and-registration/>

## Bikes on Transit

All buses have bicycles racks or storage areas, and all rail options allow bicycles free of charge.

- [Load Your Bike on a Bus Rack](#)
- [Bikes on BART 11 Rules](#)
- [Bike Lockers at BART](#)
- [ELockers at BART](#)

**The Tenaya Room is located on the first floor.**

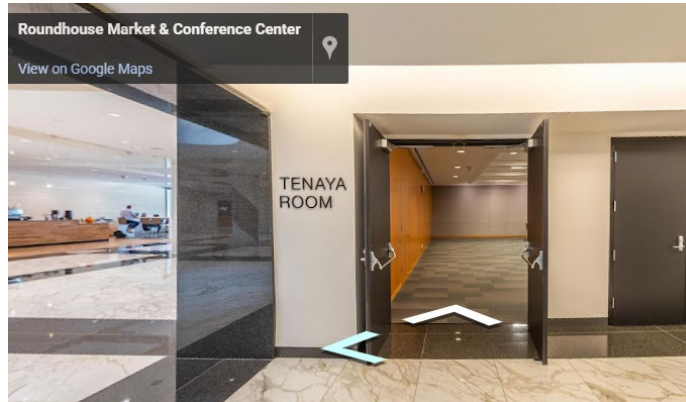
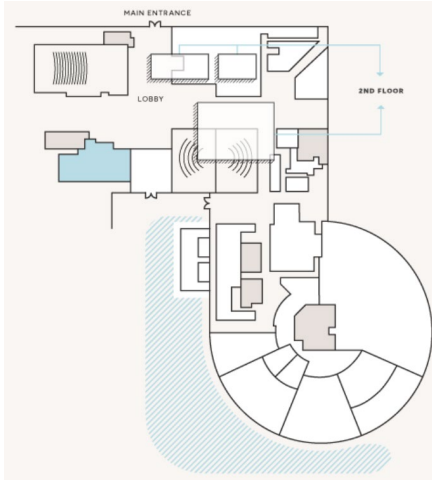

**On-site parking – Free parking garage (lower level is the easiest). Park in the garage closest to the building with the red star.**



## EV Charging –

Electric vehicle charging infrastructure is available throughout Bishop Ranch on the EV Connect network. Bishop Ranch 1, Bishop Ranch 3, and Bishop Ranch 15 all offer public level 2 EV charging.

ChargePoint electric vehicle charging stations have been installed at 2633 Camino Ramon (BR3) (about a 5-7 minute walk) and BR2600.

### Program Rules & Regulations

ACCESS TO CHARGING STATIONS	Open to public 24/7
COST	\$.36 cents per KWh for all users
TIME LIMITS	<ul style="list-style-type: none"><li>• Users allowed to charge to full battery</li><li>• User will receive a text notification when their charging session is complete</li><li>• Built-in 30-minute grace period provided to give user enough time to move their vehicle or a fine is incurred*.</li></ul>
PENALTIES	<ul style="list-style-type: none"><li>• \$10 connected fee <i>per hour</i> incurred if user does not move their vehicle within the 30-minute grace period</li><li>• Penalty only applies Monday through Friday. <b>Weekends the vehicle does not need to be moved and no fee will be assessed.</b></li></ul>

GO TO [MY.EVCONNECT.COM](https://my.evconnect.com) TO REGISTER FOR AN EV DRIVER ACCOUNT AND DOWNLOAD THE [EV CONNECT MOBILE APP](#) ON ITUNES OR GOOGLE PLAY

Find a Carpool Partner provided by Crewz: <https://crewz.co/r/rm2vd7>



### Bauer's Shuttle Schedule –

A sponsored shuttle will travel between BART Dublin/Pleasanton stop and Bishop Ranch during these times at the passenger loading zone. **A map is attached.**

- Morning Pick-Up from BART to Bishop Ranch - 7:30am, 8am, 8:30am, 9:15am & 9:45
- Afternoon Drop-Off from Bishop Ranch to BART – 4pm, 4:30pm, 5pm, 5:30pm, 6pm & 6:30pm

### BART System Map & Options -

Take BART to Walnut Creek or Dublin/Pleasanton and board a Bishop Ranch Local or Express bus to the park. Bikes are allowed on all trains, except the lead car.

BART has five lines: the Pittsburg/Bay Point (Yellow) line serves Walnut Creek north of Bishop Ranch and the Dublin/Pleasanton (Blue) line serves Dublin/Pleasanton BART south of Bishop Ranch. These stations provide direct and frequent local and express bus connections throughout the morning and evening commute.

- [BART Trip Planner](#)
- [BART Mobile Apps](#)
- [How To Use Your BRECO/Clipper on BART](#)
- [Park Your Bike and Hop On BART](#)

## BART Dublin / Pleasanton Station

- BART Parking Lot (South Side), 5801 Owens Drive, Pleasanton, CA 94588
- BART Station Park & Ride (North Side), 5067 Campus Drive, Pleasanton, CA 94588



## BART from the Bay Area –

**North option:** BART Blue-N to Dublin/Pleasanton and take the Bauer’s sponsored shuttle. **A map is attached.**

Or transfer to the County Connection Route 97X (7:20am departure) or Route 95X (7:30am), then arrive at Bishop Ranch.

- <https://www.bart.gov/schedules>
- <https://countyconnection.com/routes/97x/>
- <https://countyconnection.com/routes/95x/>

\*If you’re traveling from Berryessa/North San Jose, take the BART Green or Orange line and transfer to the BART Blue-N at the Bay Fair stop.

## From Millbrae/South San Francisco/San Francisco/Berkley/Walnut Creek:

**Fastest Route** - BART Yellow Line to the Walnut Creek stop, then transfer to the County Connection Route 96X (7:15am departure) or Route 95X (7:30am departure), then arrive at Bishop Ranch.

- <https://www.bart.gov/schedules>
- <https://countyconnection.com/routes/>
- <https://countyconnection.com/routes/96x/>

- <https://countyconnection.com/routes/95x/>

### **ACE Rail Options –**

The Altamont Corridor Express (ACE) offers four trains daily between the Central Valley and Pleasanton. The Bishop Ranch County Connection 92X Express meets these trains to provide a seamless car-free commute without congestion on I-205 and I-580.

ACE Rail Station

4950 Pleasanton Avenue

Pleasanton, CA 94566

- [Ace Train Schedule and Connections](#)
- [FREE Test Ride](#)

### **ACE Rail from San Jose/Santa Clara/Great America/Fremont:**

ACE Rail Eastbound and get off at Pleasanton (4950 Pleasanton Avenue, Pleasanton, CA 94566). Take the ACE 03 for a 6:48am arrival or ACE 05 for a 7:53am arrival. Transfer to the County Connection 92X ACE Express Route to Bishop Ranch. Or Routes 95x or 97x, depending on your arrival time.

- <https://acerail.com/stations/#%20>
- <https://acerail.com/schedules/>
- <https://countyconnection.com/routes/92x/>

### **Sonoma-Marin Area Rail Transit (SMART)**

SMART offers passenger rail service in Sonoma and Marin counties. The 43 mile corridor includes 10 stations, from the Sonoma County Airport to Downtown San Rafael.

- **System Map** - <https://www.sonomamarintrain.org/sites/default/files/Images/System-Map-2025.jpg>
- **Schedules**
- **Trip Planner**

### **Ways to pay -**

- **BART:** <https://www.bart.gov/tickets>
- **County Connection** - Clipper, Cash & Clipper Passes: <https://countyconnection.com/fares/fare-types-prices/>
- **ACE Rail:** <https://acerail.com/tickets/>

### **Bus Options –**

<https://tenants.bishopranch.com/transportation/bus/>

Bishop Ranch tenants ride all County Connection buses free with a Bishop Ranch Bus Pass (BRECO/Clipper Card). The most popular express routes that serve Bishop Ranch include the 92X from

the Pleasanton ACE Train station, the 95X and the 96X from Walnut Creek BART, and the 97X from Dublin/Pleasanton BART. Local routes serving Bishop Ranch include the 21 from Walnut Creek BART and the 35 from Dublin/Pleasanton BART.

### SF Airport -

- BART at the airport: <https://www.bart.gov/stations/sfia>
- [BART at airport map](#)
- [Google Options](#) – public transit options from the airport
  
- **Fastest:** BART Yellow-N Line to Walnut Creek BART stop. Transfer to [County Connect 96x](#) which stops at Bishop Ranch.
- [Google Map](#)
  
- **To take our sponsored shuttle:** BART Red-N Richmond and transfer to BART Blue-N at [Balboa Park](#). Get off at [Dublin/Pleasanton](#) and take the Bauer's sponsored shuttle.
- [Google Map](#)

### From the Sacramento & Northern Areas –

Soltrans - <https://www.soltrans.org/>

- Starts as North as the UC Davis Mondavi Center to Walnut Creek BART – [Blue Line](#) then transfer to the [County Connection bus 96X](#) to Bishop Ranch.
- From Fairfield: Take the [Blue Line](#) Express Bus from Walnut Creek. [County Connection bus 96X](#) from Walnut Creek BART to Bishop Ranch.

Amtrak - <https://www.amtrak.com/home.html>

<https://www.amtrak.com/routes/gold-runner-train>

- **Suisun-Fairfield stop:** Take the Soltrans [Green Line](#), then transfer to the [Blue Line](#) Express Bus in Fairfield. Take it to the Walnut Creek BART and transfer to the [County Connection bus 96X](#), which stops at Bishop Ranch.
  
- **Martinez stop:** Transfer to [County Connect 98x](#) then transfer to the [County Connection Route 96X](#) then arrive at Bishop Ranch.
- [Google Map Route](#)

# Transit Stops

Paradas del tránsito

公車站地圖



## Transit Information

### Dublin/Pleasanton Station

#### Map Key

- ★ You Are Here
- 5-Minute Walk  
1000ft/305m Radius
- Bus
- Transit Stop
- BART Parking
- Bike Parking
- Elevator
- Escalator
- Passenger Pick-up/Drop-off
- Restrooms
- Stairs
- Station Agent Booth
- Station Entrance/Exit
- Taxi Stand
- Telephone
- Ticket Vending:
  - Clipper/Add Cash Value
  - Addfare
- Transit Information

#### Transit Lines

- County Connection**
  - 35 San Ramon TC via Daugherty Valley
  - 97X Bishop Ranch
  - 335 San Ramon TC via Daugherty Valley
- San Joaquin RTD**
  - BART Commuter Stockton-Downtown TC
- Stanislaus Regional Transit Authority (StanRTA)**
  - Route C Patterson / Turlock Transit Center
  - Commuter Modesto
- Wheels**
- Local Bus Lines**
  - 1 Santa Rita Jail
  - 3 Stoneridge Mall
  - 8 Hopyard Rd/First St
  - 10R Santa Rita Rd/Livermore Transit Center
  - 14 Outlets/Livermore Transit Center
  - 20X Livermore Transit Center/LLNL
  - 30R West Dublin BART
  - 30R Las Positas College/LLNL
  - 54 ACE
  - 70X Pleasant Hill BART/Walnut Creek BART
- Early Bird Express**
  - 703 San Francisco, Salesforce Transit Center

Note: Service may vary with time of day or day of week. Please consult transit agency schedule or contact 511 for more information.



Call 511 | 511.org

Sponsored by the Metropolitan Transportation Commission in cooperation with AC Transit. Contact us at signcomments@bayareametro.gov.

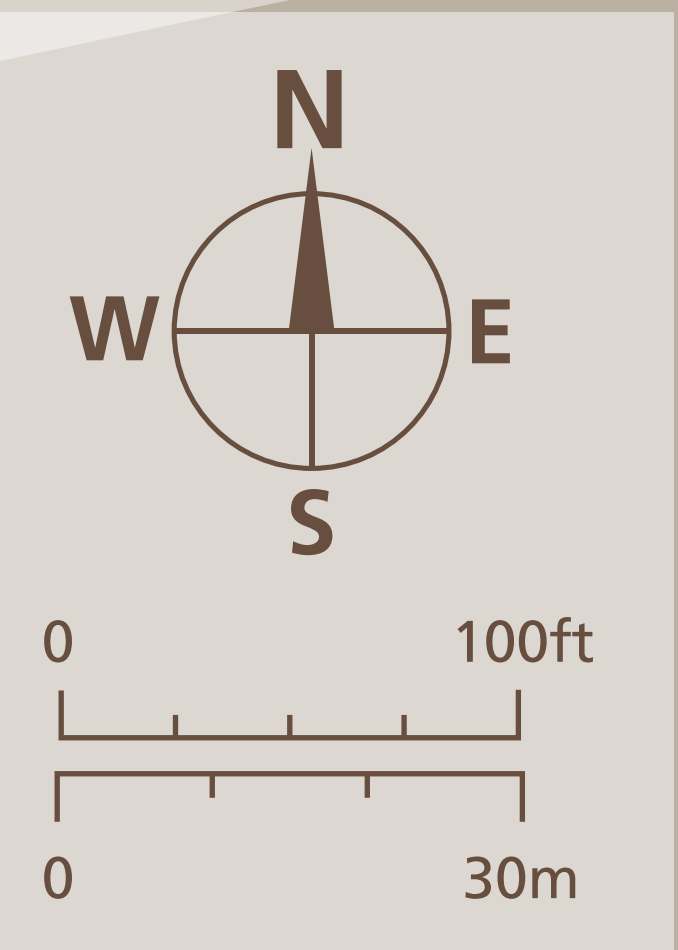
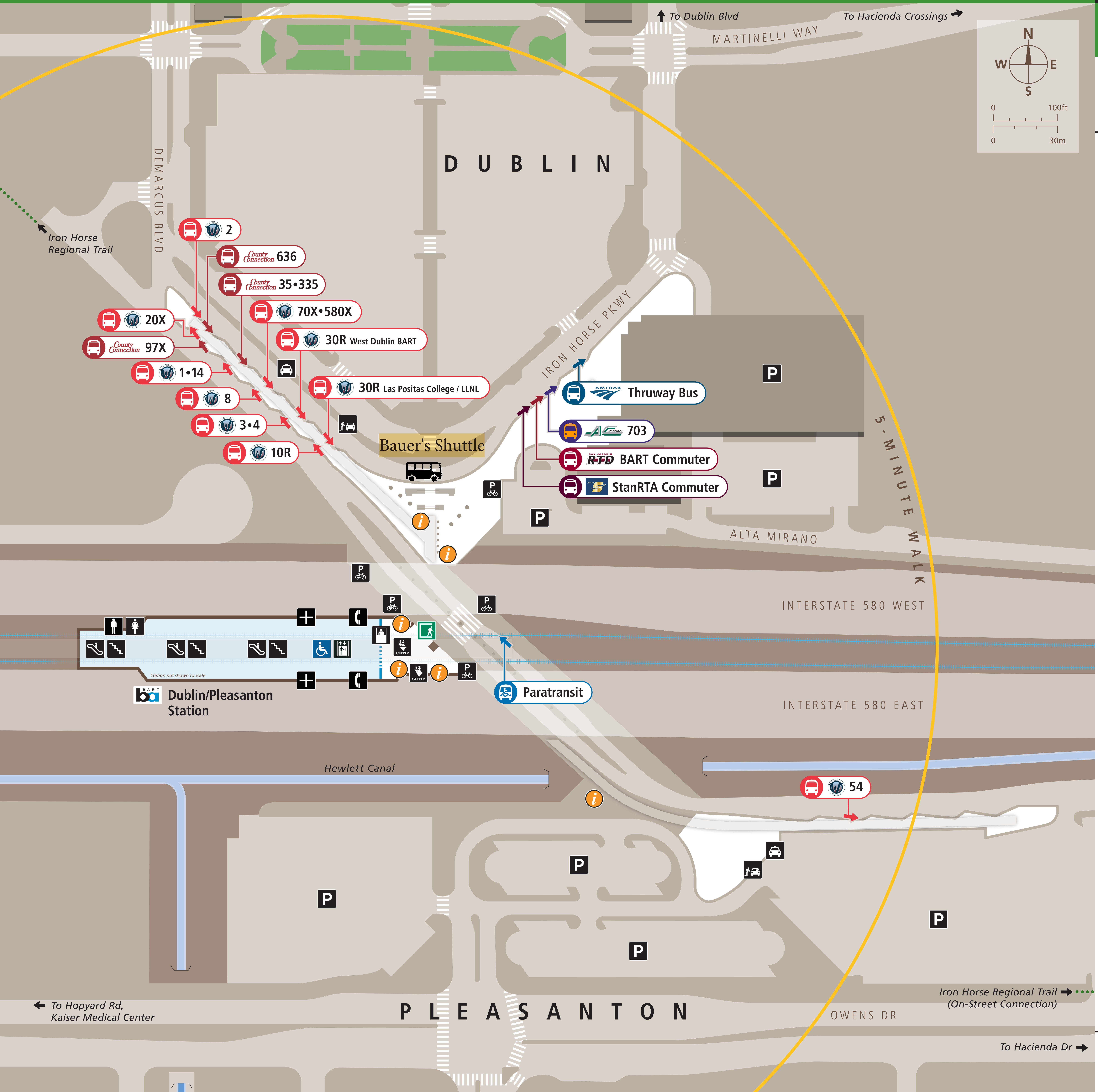

← To Hopyard Rd, Kaiser Medical Center

Iron Horse Regional Trail (On-Street Connection) →

To Hacienda Dr →