



American College of Osteopathic
Obstetricians and Gynecologists
2018 Fall Conference
October 25-28, 2018

Joseph Bottalico, DO
Program Chair

Becky Graham, DO
Program Chair



Program



2018 Fall Conference
Online Materials

2018 Fall Conference

Table of Contents

Schedule at a Glance	4
Meetings	8
Maps of Conference Area	10
Meet the Program Chairs	12
Agenda	14
Faculty Disclosures	38
CME Credit procedures	40
CME Attestation Info	41
Mobile Info	42
ACCOG Future Events	45
Exhibitors	45
Attendees	52

2018 Fall Conference

Schedule at a glance

Thursday, October 25, 2018

12:00 PM - 5:00 PM	Early Registration	Worthington Ground Level
12:00 PM	Residency Research Seminar	Rio Grande Room
3:00 PM - 5:00 PM	OMT in Women's Health: Simple, Safe & Effective Manipulation Specifically for Your Patients David Mason, DO & Meaghan Nelsen, DO	West Fork/Trinity Central

Meetings and Events... see pages 7 & 8

Friday, October 26, 2018

7:00 AM - 4:45 PM	Registration	Grand Ballroom Foyer Level 2
7:00 AM - 7:30 AM	Breakfast / Exhibitors	Rio Grande Ballroom
7:30 AM - 4:45 PM	General Session	Grand Ballroom
7:30 AM	Pearls of MFM <i>Past Presidents Honorary Lecture</i> Lisa Thiel, DO	
8:15 AM	Management of Complicated Monochorionic Multifetal Pregnancies Anthony Johnson, DO	
9:00-9:45 AM	Break with Exhibitors	
9:45 AM	Update on Red Cell Alloimmunization Kenneth J Moise, MD	
10:30 AM	Cardiac Disease in Pregnancy Robert Debbs, DO	
11:15 AM	Designing and Running Simulations David Jaspan, DO	
12:00 PM	ACGME Update David Jaspan, DO	
12:00-1:15 PM	Lunch with Exhibitors	Rio Grande Ballroom
1:15 PM	Abnormal Uterine Bleeding in Reproductive Age Woman David Jaspan, DO	

Meetings and Events ... see pages 7 & 8

Friday, October 26, 2018, *continued*

- 2:00 PM **Gynecologic Cancer Prevention**
Howard Saul, DO
- 2:45-3:15 PM Break with Exhibitors
- 3:15 PM **Genetic Screening Update**
Allan Donnenfeld, MD
- 4:00 PM **Managing Abnormal Pap Smears**
Howard Saul, DO

Saturday, October 27, 2018

- 7:00 AM-4:30 PM Registration Grand Ballroom Foyer Level 2
- 7:00 AM-7:30 AM Breakfast with Exhibitors Rio Grande Ballroom
- 7:30 AM - 4:30 PM General Session** Grand Ballroom
- 7:30 AM **Morbidly Adherent Placenta**
Gregory S. Willis, DO
- 8:15 AM **The Dreaded Antenatal Consult for Obesity**
Eric Carlson, DO
- 9:00 AM **Medical Judgement: The Cognitive Psychology of Prediction & Judgement**
Brad Irving, DO
- 9:45-10:30 AM Break with Exhibitors Rio Grande Ballroom
- 10:30 AM **Management of Trauma in Pregnancy**
Stephanie Martin, DO
- 11:15 AM **Update on Diabetes in Pregnancy**
Tracy Papa, DO
- 12:00-1:30 PM Lunch on your own
- 1:30 PM **Long Term Follow-up Recommendations for Women with Gynecologic Cancer/Dysplasia**
Gregory S. Willis, DO
- 2:15 PM **Hormone Therapy Update 2018**
Patricia Sulak, MD
- 3:00 PM **Weird Sites for Endometriosis**
Jennifer Nichols, DO
- 3:45 PM **Death in America: Startling Statistics**
Patricia Sulak, MD

Meetings and Events ... see pages 7 & 8

Sunday, October 28, 2018

7:30 AM-12:00 PM	Registration	Grand Ballroom Foyer Level 2
7:30 AM -8:00 AM	Breakfast	
8:00 AM - 12:00 PM	General Session	Rio Grande Room
8:00 AM	Ethical Issues in Caring for Patients Across Language Barriers Elizabeth Heitman, PhD	
8:45 AM	Informed Consent in an Era of Team Medicine: Whose Professional Responsibility? Elizabeth Heitman, PhD	
9:30-9:45 AM	BREAK	
9:45 AM	Choosing an EMR For Your Office Sheryl Bushman, DO	
10:30 AM	EMR Pitfalls Sheryl Bushman, DO	
11:15 AM	Electronic Charting, Your Best Friend for The REST of Your Career! William Bradford, DO	
12:00 PM	Adjourn	

Meetings and Events... see pages 7 & 8

Meetings

Thursday, October 25, 2018

8:00 AM-12:00 PM	ACCOG Board of Trustees Meeting	Post Oak
12:00 PM-3:00 PM	Residency Research Seminar	Rio Grande Room
1:00 PM-4:00 PM	PESC Meeting	Live Oak 1

Friday, October 26, 2018

1:00 PM-3:30 PM	Council of Postgraduates	West Fork
3:30 PM-5:00 PM	CMEC Meeting	West Fork

Saturday, October 27, 2018

8:00 AM-12:00 AM	Medical Student Education Program	West Fork/Trinity Central
1:30 PM-3:00 PM	National Student Society (NSS-ACCOG)	West Fork/Trinity Central
3:00 PM-4:30 PM	Membership & Promotion Committee	West Fork/Trinity Central

Events

Friday, October 25, 2018

5:00 PM -7:00 PM

MEFACCOOG Fundraiser Chili Cook-Off

Terrace

Friday, October 26, 2018

5:30 PM - 7:00 PM

Residency Fair/NSS Mixer

Rio Grande Ballroom

Saturday, October 27, 2018

6:00 PM 10:00 PM

Social Event

Four Day Weekend Improv Comedy Show

312 Houston St

Fort Worth, TX 76102

Dinner at 6:00 PM in Private Party Room. Show begins at 7:30pm.

Conference Maps

Maps

(First Floor)

Live Oak

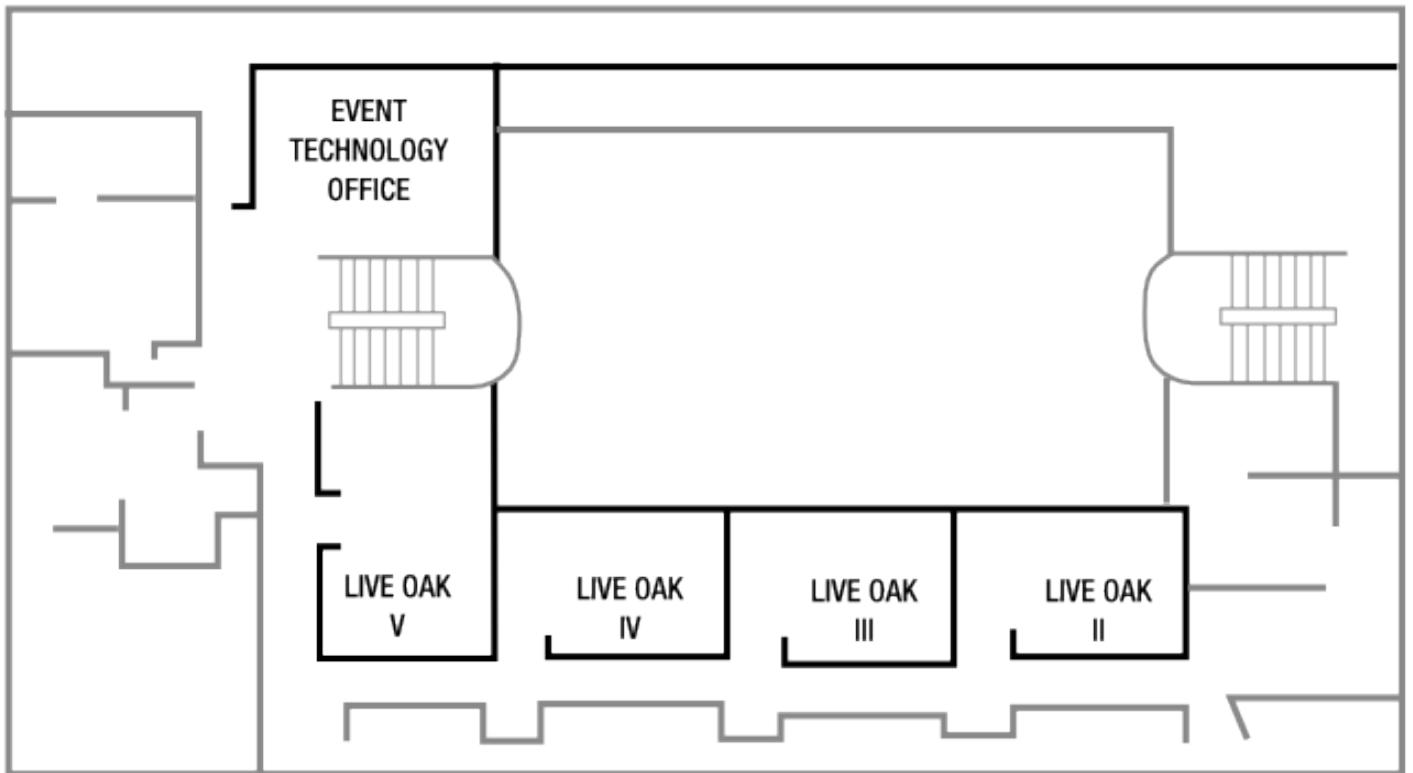

MEZZANINE

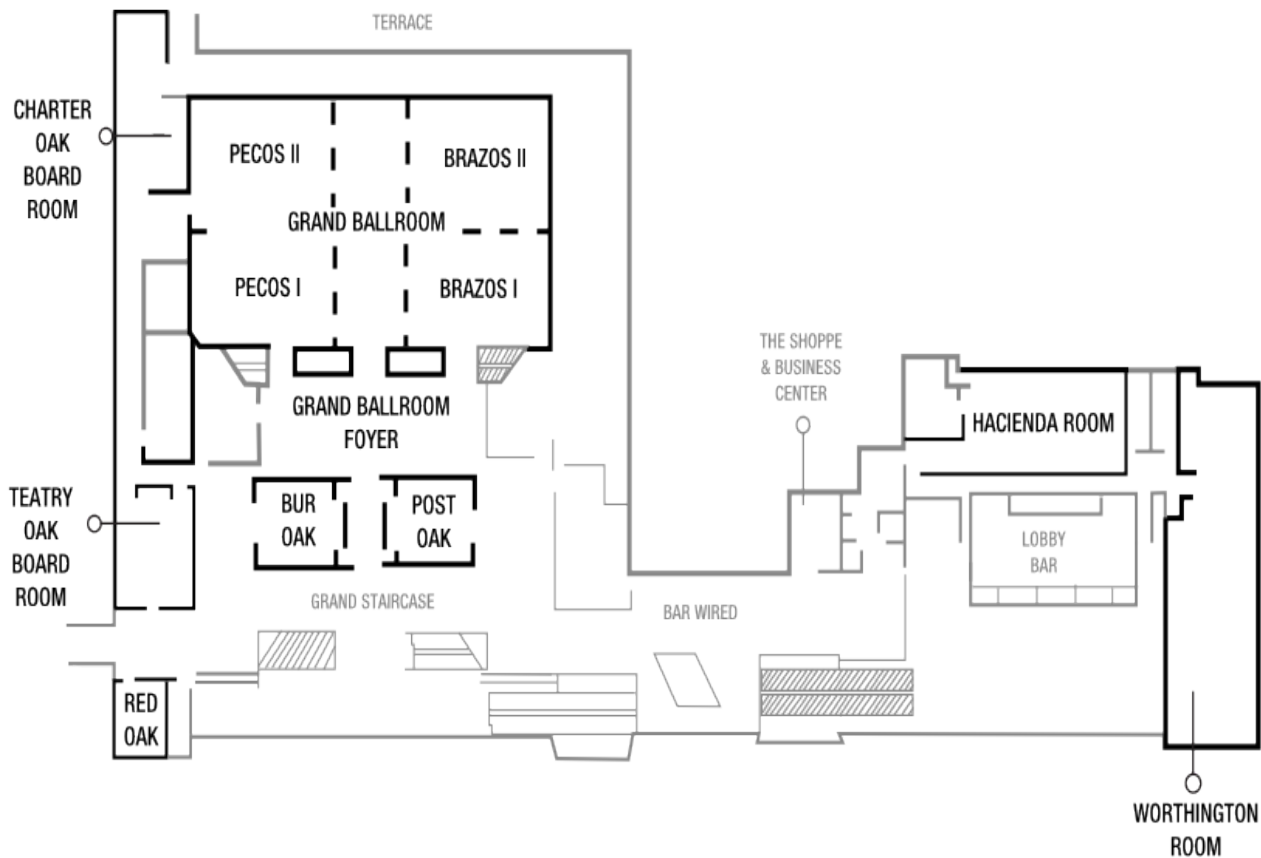

Trinity

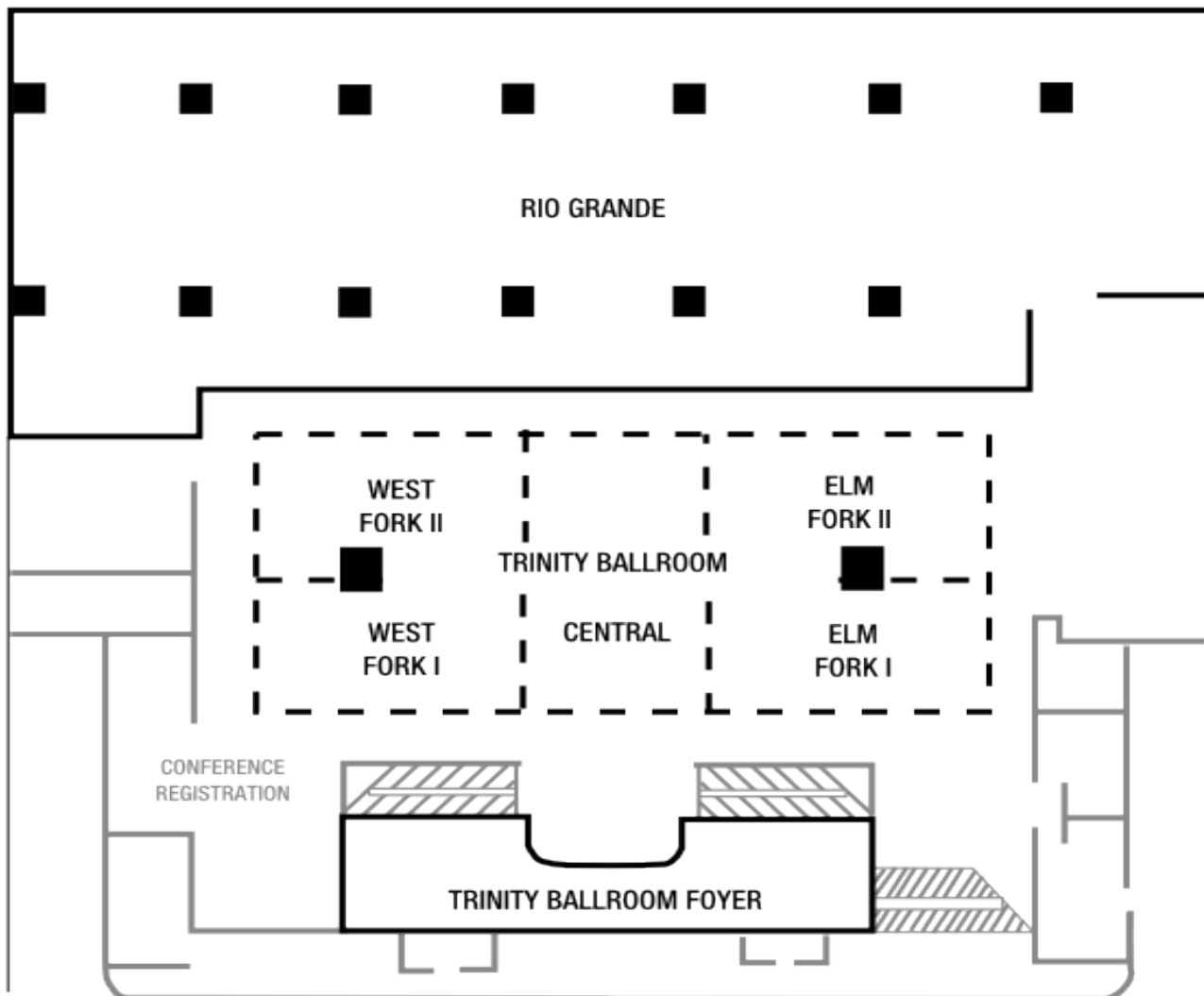

WEST FRONT DRIVE

Program Chair

Joseph Bottalico, DO



Dr. Joseph Bottalico hails from Southern New Jersey. In 2012, he moved to Midland, Texas to join a respected group of MFMs in a Regional Perinatal Center, where they maintain a busy consultative and inpatient high-risk transport service.

After his MFM Fellowship at Pennsylvania Hospital in 1987, Dr. Bottalico directed the MFM unit at Kennedy Hospital in Southern New Jersey, the major teaching affiliate of what is now Rowan University School of Osteopathic Medicine. In 2010, he re-joined Pennsylvania Hospital and their Regional MFM Network under the direction of our esteemed colleague Dr. Robert Debbs, Past President of the ACOOG, also an MFM specialist.

Dr. Bottalico has served in many leadership roles including that of past president of the Southern New Jersey Perinatal Cooperative and the New Jersey Maternal-Fetal Medicine society. He has also served as a volunteer with several organizations, including the New Jersey Chapter of the March of Dimes, where he helped organize annual postgraduate conferences in Princeton. Dr. Bottalico has been recognized with resident teaching awards and the Distinguished Alumnus Award from his medical Alma Mater in New Jersey, and has proudly served on the Research and Awards, Editorial and CME Committees of the ACOOG.

Program Chair

Becky Graham, DO



After 10 years in the teaching profession, Dr. Graham was accepted and attended medical school at Kansas City College of Medicine and Biosciences in Kansas City, Missouri. Her rotating Internship was completed at Park Lane Medical Center in Raytown, Missouri, and she completed her OB/GYN residency at Deaconess West Hospital in Des Peres, Missouri, where she had the opportunity to train with Sheryl Bushman, D.O., who recruited Dr. Graham to join ACOOG.

Dr. Graham served as Chair for the ACOOG Fall Conference in Kansas City, Missouri in 2003, where the tradition of fun and fellowship with attending physicians, residents and medical students began. At that conference, and every Fall Conference following, attending physicians contributed so the residents and students could participate in a recreational activity, facilitating collegiality, and forming lasting relationships with the ACOOG and its members.

After 20 years of private practice, Dr. Graham became an OB Hospitalist. She is currently the team lead at the OB Hospital Group at the Norman Healthplex in Norman, Oklahoma. She believes strongly in the value of continuing medical education (CME) and its potential to improve patient care, which is why she is serving her second term on the ACOOG Continuing Medical Education Committee. She also loves OMT, which holds an important place in her treatment armamentarium.

8:15-9:00 AM

Management of Complicated Monochorionic Multifetal Pregnancies

Anthony Johnson, DO

Learning Objectives:

1. Define hematologic disorders unique to monochorionic (MC) multifetal pregnancies
2. Describe the screening protocol for MC pregnancies
3. Identify pre- and postoperative risk factors for poor outcome following laser in TTTS
4. Describe classification, diagnostic criteria and management of sIUGR in MC twins.

10:30-11:15 AM

Cardiac Disease in Pregnancy
Robert Debbs, DO

Learning Objectives:

1. Enhance the skills needed to provide preconceptual assessment and counseling to women with congenital heart disease
2. Implement strategies to reduce the risk of adverse events in women with cardiovascular disease in pregnancy
3. Recognize cardiac deterioration in pregnancy related conditions

1:15-2:00 PM

Abnormal Uterine Bleeding in Reproductive Age Woman
David Jaspan, DO

Learning Objectives:

1. Provide differential diagnosis of abnormal uterine bleeding (AUB)
2. Describe normal physiology and pathophysiology
3. Identify treatment options for AUB

3:15-4:00 PM

Genetic Screening Update
Alan Donnenfeld, MD

Learning Objectives:

1. Describe the differences between biochemical screening and cell free fetal DNA screening for aneuploidy
2. Explain the concept of Expanded Carrier Screening
3. Develop a practical approach to offering genetic screening tests for prenatal patients

7:30-8:15 AM

Morbidly Adherent Placenta

Gregory S. Willis, DO

Learning Objectives:

1. Define placental anomalies: Accreta, Increta, Percreta
2. Describe the pathogenesis of the normal placenta and why it can sometimes invade outside of the uterus
3. Describe medical and surgical implications of management of the abnormal placenta.
4. Recall the anatomy of the normal and abnormal placenta and pregnant uterus.
5. Describe multidisciplinary approaches to the problem.

9:00-9:45 AM

Medical Judgement: The Cognitive Psychology of Prediction & Judgement
Brad Irving, DO

Learning Objectives:

1. Explain the cognitive psychology of prediction and judgement
2. Describe the processes that the mind uses to make judgements
3. Recognize how these processes impact decision making (generally & medically)
4. Assess how the psychology of prediction and judgment impacts evidence-based medicine and how best practices can improve care
5. Reduce the chance of cognitive errors in your own thinking

11:15-12:00 PM

Update on Diabetes in Pregnancy
Tracy Papa, DO

Learning Objectives:

1. Describe the different screening options for diabetes in pregnancy
2. Counsel diabetic patients about dietary recommendations in pregnancy
3. Plan fetal monitoring and delivery of diabetic patients
4. Describe therapeutic options for treating diabetes during pregnancy

Saturday, October 27, 2018

1:30-2:15 PM

Long Term Follow-up Recommendations for Women with Gynecologic Cancer/Dysplasia

Gregory S. Willis, DO

Learning Objectives:

1. Explain the concept of a gynecologic survivorship program and how it relates to the Osteopathic philosophy
2. Identify the short and long term follow-up guideline-based recommendations for women diagnosed with cervical, vaginal, vulvar, uterine, or ovarian cancers

2:15-3:00 PM

Hormone Therapy Update 2018
Patricia Sulak, MD

Learning Objectives:

1. Review the evidence regarding risks and benefits of hormone therapy
2. Describe and differentiate available hormone therapeutic options
3. Identify strategies to individualize menopause patient management
4. Discuss essential elements of health and wellness

3:45-4:30 PM

Death in America: Startling Statistics
Patricia Sulak, MD

Learning Objectives:

1. Discuss the W.H.O. definition of wellness
2. List the common causes of death in U.S.
3. Discuss suicide and alcohol /drug abuse in U.S.
4. Describe increasing death rates of middle age individuals and their causes
5. Describe essential elements to health and happiness and the role of healthcare professionals

8:45-9:30 AM

Informed Consent in an Era of Team Medicine: Whose Professional Responsibility?
Elizabeth Heitman, PhD

Learning Objectives:

1. Outline physicians' historical professional commitment to withholding information from patients and their families as a means of promoting hope
2. Describe how informed consent became the professional standard for therapeutic communication in the modern era
3. Articulate the professional challenges and responsibilities of sharing communication around informed consent when Ob/Gyn care is provided by a team of physicians and other care providers

10:30-11:15 AM

EMR Pitfalls

Sheryl Bushman, DO

Learning Objectives:

1. Describe common EMR pitfalls and how to avoid them
2. Identify the negative impact your use of your EMR is having on your patients, practice and well-being
3. Create a strategy to improve your EMR efficiency and accuracy

DISCLOSURES

The following presenters have nothing to disclose:

- Eric Carlson, DO, FACOOG (Dist)
- Alan E Donnenfeld, MD, FACOG
- Elizabeth Heitman, PhD
- Brad Irving, DO, FACOOG
- David Jaspán, DO, FACOOG (Dist)
- Anthony Johnson, DO, FACOOG
- David Mason, DO, FACOOG
- Meaghan C Nelsen, MS, DO, FACOOG
- Tracy Papa, DO, FACOOG
- Howard Saul, DO, FACOOG (Dist)
- Lisa Thiel, DO, FACOOG

The following presenters have indicated their presentation will include these off-label discussions:

- William Bradford, DO, FACOOG (Dist)
This presentation discusses off-label uses of medications to control postpartum hemorrhage and medications for preeclampsia.
- Jennifer Nichols, DO, FACOOG (Dist)
This presentation mentions the possible off-label treatments for endometriosis: Combined oral contraceptives, Etonogestrel/ethinyl E2 vaginal ring, Progestins Medroxyprogesterone Dienogest GnRH antagonists Cetrorelix, Ganirelix, Elagolix (oral), PPAR-g agonists Rosiglitazone Pioglitazone Aromatase inhibitors Letrozole, Anastrozole P4 releasing. IUD, Raloxifene, Selective estrogen receptor modulator, Statins, Immunomodulator: infliximab Immunomodulator: etanercept Valproic acid.
- Patricia Sulak, MD
This presentation mentions off-label uses of oral contraceptives to treat menopausal symptoms.
- Gregory S. Willis, DO, FACOOG
This presentation contains mention of the use of etoposide for ectopic placental tissue/pregnancy

The following presenters have a relationship with a commercial interest to disclose:

- Dr. Bushman has indicated she is a stockholder in the following companies: Baxter International, Bristol-Myers Squibb, Celgene Corp., CVS, Gilead Science, Inc., Illumina Inc., Ions, Pharmaceuticals, Eli Lilly & Co., Pfizer Inc., Shire, Johnson & Johnson.
- Dr. Debbs has disclosed that he has received speaker honoraria from Natera and Hologic.
- Dr. Martin has indicated she is a consultant for Daiichi Sankyo.
- Dr. Moise has disclosed that he has received research funding from Momentum Pharmaceuticals for the development of novel immune therapy for red cell alloimmunization.

Disclosures, *continued*

The following CME Committee Members and ACOOG Staff have nothing to disclose:

Catherine Bernardini, DO
Cecilia W. Banga, DO
Jessica Lee Branham, DO
Joseph N. Bottalico, DO
Octavia M. Cannon, DO
Stephen A. D'Abreau, DO
Becky Graham, DO
Eav Lim, DO
Rosalyn Green Miller, DO
Jennifer L. Nichols, DO
Gregory P. Norwood, DO
Paige Paladino, DO
Elizabeth Stevenson, DO
Andrew Zink, DO
Lauryn Przeslawski, DO
Michael J. Geria, DO
Valerie Bakies Lile, CAE
Andrew D. Crim, CHCP
Martha Prud'homme

Neither the ACOOG nor any staff members in a position to influence content have anything to disclose.

The following Moderators have nothing to disclose:

Rupesh Patel, DO
Jen Humel DO
Howard Kaufman, DO
Carol Anderson, DO
Leslie Ollar-Shomake, DO

CME CREDIT PROCEDURES

How to Claim CME Credit

Members who wish to receive CME credit must attest to the sessions attended and complete activity evaluations, available only through ACOOG's website. Please visit the on-site ACOOG CME computer kiosk for assistance, or log-in to acoog.org from your own computer before **November 12, 2018**. Non-member participants will receive a limited access log-in and password to the web site for CME purposes. CME credit cannot be reported unless the attestation and evaluation are completed and verified by the ACOOG office.

Deadline to Claim Credit (November 12, 2018)

Attestation will remain open for 14 days from the close of the conference. The final day to claim credit is **November 12, 2018**. After this date, requests for CME will require a written explanation and be assessed a \$50 non-refundable fee. Requests for special consideration are decided on a case-by-case basis.

Opportunity for Additional Credit

Between 14 and 30 days after the conference, you will be e-mailed an outcomes measurement assessment. Those who complete this assessment before the deadline will earn up to 3 additional Category 1-A CME credits, per AOA guidelines, at no additional charge.

Grievances

Any registrant finding evidence that the continuing medical education program presented is inappropriate with regard to facilities, handouts, program content, or observes any unacceptable promotion of a specific product in the same room as the educational activity, whether by company representative or lecturer, may submit a grievance in writing to ACOOG, 201 Main Street, 6th Floor, Fort Worth, TX 76102. Unresolved issues regarding compliance with AOA Division of CME guidelines or ACOOG will require a formal written complaint to the American Osteopathic Association, Division of Continuing Medical Education, 142 East Ontario Street, Chicago, IL 60611.

CME CREDIT PROCEDURES

Don't forget to attest for CME credits!

New System!

Visit our web site at www.acoog.org
- Sign In with your ID and password

Your ID is your AOA number (IF it begins with a zero, do not use the leading zero) and your password is the first letter of your last name in lowercase followed by your AOA number (again, no leading zero).

EXAMPLE Joe Davis

AOA #: 012345
Login: 12345
Password: d12345

- Click on **EDUCATION** on the navigation bar
- Then click on **CME**
- Click on **CME EVENT ATTESTATION**

New system will open

2018 Fall Conference
Oct. 25-28, 2018

Pretest Results



Demographics



Session Evaluation



Overall Evaluation



Return to Instruction Page

Logout

WE ARE MOBILE!

To access the ACOOG mobile site visit this link:
<https://www.acoog.org/web/FC18Mobile/home>

Speakers
Icon: A person standing next to a presentation board.

Community
Connect with your colleagues
Icon: A group of three people.

Syllabus
View the on-line Power Point Presentations

Agenda
Icon: A calendar.

Evaluate the program and attest for CME credits
Icon: A document with a pencil and a checklist.

2018 Fall Conference
FORT WORTH STOCK YARDS
Worthington Renaissance
Fort Worth, TX
Oct. 25-28, 2018

WELCOME TO THE
2018 FALL CONFERENCE

2018 Fall Conference Online Materials



proudly supports

**2018 Fall Conference
American College of Osteopathic
Obstetricians and Gynecologists**

Serving thousands of Women's Health providers and their patients daily, PathGroup is one of the largest providers of Women's Health laboratory services in the United States. And like you, PathGroup is committed to excellence in Women's Health Services.

To learn more about our comprehensive Women's Health laboratory services, call 888.410.4618 or visit PathGroup.com/Womens-Health



SOCIAL EVENT

Four Day Weekend Improv Comedy Show



Comedy improvisers and actors will be delivering a night of full entertainment.

Saturday, Oct. 27, 2018

6:00 PM-10:00 PM

Each guest will receive 2 drink tickets. Cash bar available.
Dinner is at 6:00 PM in Private Party Room. Show begins at 7:30pm.
Cost: \$75.00

FUTURE EVENTS



86th Annual Conference
March 24-29, 2019
Hilton Riverside
New Orleans, LA



2019 Fall Conference
October 3-6, 2019
Hyatt Regency Downtown
Columbus, OH



87th Annual Conference
March 29-April 2, 2020
Hilton La Jolla Torrey Pines
San Diego, CA

DONATIONS TO MEFACCOOG

Other ways to



amazonsmile
You Shop. Amazon Gives.

You shop. Amazon gives.

Amazon donates 0.5% of the price of your eligible AmazonSmile purchases to the charitable organization of your choice.

Search for charity:

Medical Education Foundation of the Amer Coll of Osteopathic Ob-Gyn

Location: Fort Worth, TX

to start shopping at smile.amazon.com



MENSTRUAL PRODUCT DRIVE

When donating to the homeless, menstrual products are a frequently overlooked need. Let's help by donating unopened packages of tampons or pads.

Please donate at the registration desk.

Exhibitors

MEFACCOG Corporate Partner

AbbVie Metabolic

Platinum Level
AbbVie Metabolic

Silver Level

Duchesnay USA
Minerva Surgical

Bronze Level

CHRISTUS Physician Group
GSquared Medical
Hologic, Inc.
PathGroup
Trophikos

Exhibitors

Ashlar Medical
EHRC Technologies
Florajen Probiotics
GE Healthcare
Medi Lazer
Merck Women's Health Division
Ob Hospitalist Group
Success Concepts, an Elsevier Affiliate
TherapeuticsMD
Wolters Kluwer

Commercial Support

ACCOG would like to thank the following company for providing an educational grant and/or in-kind support:

Hologic, Inc.
Tesaro

Company Name	Booth #
AbbVie Metabolic	--
<p>AbbVie is a global, research-based biopharmaceutical company formed in 2013 following separation from Abbott Laboratories. At AbbVie, we have the expertise of a proven pharmaceutical leader and the focus and passion of an entrepreneur and innovator. As a result, AbbVie is a leading company with the stability, resources, expertise and passion to discover, develop and bring to market groundbreaking science to solve the biggest health problems that face the world today and tomorrow. AbbVie employs approximately 25,000 people worldwide and markets medicines in more than 170 countries</p>	
Ashlar Medical	19
<p>Ashlar Medical is committed to offering innovative solutions for the diagnosis and treatment of common urinary conditions. Urinary incontinence is one of the most common urinary conditions affecting people of all ages and gender with symptoms being more common in individuals over age 65. To help better serve the needs of this ever-aging patient population, Ashlar makes Urodynamics and its revenue opportunities easy to integrate into any medical practice with the rediCADDY® system.</p>	
CHRISTUS Physician Group	2
<p>CHRISTUS Health is a Catholic, not-for-profit system made up of more than 600 centers, including long-term care facilities, community hospitals, walk-in clinics and health ministries. We are a community 45,000 strong, with over 15,000 physicians providing individualized care.</p> <p>At CHRISTUS we value what each individual brings to our faith-based mission of healing and our commitment to quality health care. In return, we aim to create a culture where quality of work and quality of life live harmoniously, talent is recognized and each employee's unique passions and skills are nurtured to develop meaningful careers.</p>	
Duchesnay USA	6
<p>Duchesnay USA is a specialty pharmaceutical company with a long-standing commitment to women's health. We have a broad portfolio of products to offer safe and effective therapeutic options that meet the health and quality of life needs of women and their family members at different stages of their lives. To learn more, visit www.DuchesnayUSA.com.</p>	
EHRC Technologies	8
<p>We specialize in promoting FDA approved medical device. Our device combines two cutting-edge technologies in the area of non-invasive, pain-free solutions for rehabilitation and repair of damaged cells, tissues and nerves.</p>	
Florajen Probiotics	15
GE Healthcare	16
GSquared Medical	17
<p>GSquared Medical develops intra- and post-operative patient positioning and wound care devices for the high BMI patient. Our intra-operative device facilitates quick and reliable patient positioning without strain or injury to clinical staff. The post-op wound care device promotes healing and helps prevent SSIs. It is worn up to 14 days, even in the shower, is adjustable and gentle to the skin.</p>	

Company Name	Booth #
Medi Lazer	11
Medi Lazer provides a variety of healthcare solutions to many different industries. We work on developing and identifying the best medical care to help diverse professional groups overcome their challenges.	
Merck Women's Health Division	14
Minerva Surgical	1
Minerva Endometrial Ablation System delivers the result patients are asking for..Zero Bleeding. Minerva produced 72% of Amenorrhea Rate, twice as high as the nearest competitor. Recent market research suggests that 90% of women interested in an endometrial ablation prefer Amenorrhea vs. a significant reduction in bleeding. MINERVA ES features proprietary Extension Tubes that flow CO2 evenly throughout the entire uterine cavity to detect perforations. Visit www.minervasurgical.com to learn more.	
Ob Hospitalist Group	12
PathGroup	5
PathGroup is a single-source provider of anatomic, clinical and molecular pathology laboratory testing. Led by a strong physician and scientific team, we are committed to Women's Health laboratory services. With a focus on patients, PathGroup offers testing across the continuum of a woman's life – from adolescence to reproductive and middle age years to her mature years. And because we know test results matter, we provide industry-leading turnaround time while ensuring accurate and quality assured results. We adapt to each practice to ensure you remain focused on what you do each day – care for your patients. For more information, visit pathgroup.com/womens-health .	
Success Concepts, an Elsevier Affiliate	20
TherapeuticsMD	13
Trophikos	4
ellura is a medical-grade supplement proven effective as a non-antibiotic alternative for UTI prevention. Backed by a robust portfolio of research, only ellura contains 36 mg PAC (proanthocyanidins) and inhibits bacterial adhesion to the bladder wall, stopping the UTI before it starts. Patients can take ellura once daily to prevent UTIs associated with menopause or choose our convenient 'on-demand' intercourse dosing. Visit our booth to learn more about proven UTI prevention, without the side effects and resistance associated with antibiotics. myellura.com	
Wolters Kluwer	7

Attendees

as of Oct 4, 2018

Danielle Abril, OMS
Christopher David Ackerman, DO
Julie Adams, DO
Andrew Adamson, DO
Kimberley Agbo, OMS
Alya Ahmad, OMS
Rana Akkad, OMS
Jamie Lee Aldakkour, OMS
Amal Amir, OMS
Carol K. Anderson, DO
Talon Anderson, DO
Tracy Arghavani, DO
Shalin Arnett, DO
Steven D. Ater, OMS
Michelle Auerbach, DO
Kurt Aurand, DO
Ariella Azimi, OMS
Monica M. Bachamp, DO
Terry King Badzinski, DO
Billie Marie Baggett, OMS
Rikki Baldwin, DO
Elizabeth Bautista-Whitaker, OMS
J. Martin Beal, DO
Nisha Beard, OMS
David L. Beaton, DO
Adriena Cothron Beatty, DO
Kathryn Becker, OMS
Jacqueline Belen, DO
Patricia A. Bell, DO
Chloe Benichou, OMS
Benjamin Benitez, DO
Janelle Blickensderfer, DO
David J. Boes, DO
Joseph N. Bottalico, DO

Heather Bourkovski, DO
Alisa Bowersock, DO
William C. Bradford, DO
Melissa Bradley, DO
Sarah Bradley, DO
Kathleen Bridges, OMS
Israel K. Brown, DO
Steve P. Buchanan, DO
Madison Buchman, OMS
Christopher S. Buckley, DO
Sheryl A. Bushman, DO
Christina Caito, DO
Victoria Calvelage
Christy L. Campbell, DO
Eric J. Carlson, DO
James Carlson, DO
Denise F. Carnegie, DO
Sheila Carnett, DO
Craig W. Chandler, DO
Carolyn Chatterton, DO
Thomas Rees Checketts, OMS
John Cherry, DO
Lauren Chew, OMS
Gunjan Chitnis, DO
Chelsea Clarke, OMS
Michelle Coates, DO
Hannah Colby, , OMS
Alexis Colter, DO
Cassandra R. Cook, DO
Alexandra Cooke, OMS
Jessica Cooper, OMS
Mary P. Cornelius, DO
Bethany Correa, OMS
Carla Cortez, OMS

Robin M. Cox, DO
Courtney Cox, OMS
Julia Craig, OMS
Stephen A. D'Abreau, DO
Laura S. Dalton, DO
Darlene F. Daly, DO
Thomas Dardarian, DO
Steven R. Daube, DO
Urania Davis, DO
Daniela Maher Davison, OMS
Mark W. Day, DO
Robert H. Debbs, DO
Raymond W. Deiter, DO
Lauren Delana, DO
Joseph DeRosa, DO
Bhavishya Devireddy, OMS
Mahima Dhume, OMS
Walter Dodard, DO
Lorene Dreisbach, DO
Courtney Duncan, OMS
Sherman Dunn, Jr., DO
Samar Eisa, OMS
Samantha Engel, OMS
Gerald W. Englund, DO
Ari Joshua Epstein, OMS III
Nathan Fairbourn, OMS
Sira Faizi, OMS
Layla Corene Farahani, OMS
Kari Farris, DO
Ellen D. Faucett, DO
Anita Fazeli, OMS
Ryan Findlay, OMS
Nicole M. Fitch, OMS
Angela Fleming, DO

David A. Forstein, DO
Sarah Frank, OMS
Amber C. French, DO
Alexa Fritsch, OMS
Daniel Gabrielson, DO
Amber Gadson, OMS
Michele Garant-Smotherman, DO
Sarah Garcia, DO
Erin Garner, DO
Cathy L. Geria, DNP, APN, C
Michael J. Geria, DO
Stephanie Getz, DO
Brent W. Gillum, DO
Daniel D. Gilman, DO
Becky Graham, DO
Deborah L. Gregory, DO
Mary Traci Groening-Wang, DO
Tracey S. Grosinger, DO
John R. Guerra, DO
Melvin B. Habecker, DO
Megan Elizabeth Haber, OMS
Dustin Hall, DO
Justin Lee DePaula Haloot, OMS
Edward W. Halpren, DO
Kenneth E. Hamilton, DO
Leslie Hardick, DO
Amy Hardin, DO
Elizabeth K. Harris, DO
Christina Harris, DO
Kurt D. Harrison, DO
Joseph Hartfiel, DO
Cherise Hatch, OMS
Joel T. Hendryx, DO
Nicole D. Henry, DO
Kristi Herbst, DO
Breanne Hileman, DO

Amanda Hill, MD
Erin Hill, DO
Emily Hill Engstler, DO
Sarah Diane Hmaidan, OMS
April Hoffman, DO
Timothy A. Hoffmeister, DO
Lauren Holmes, OMS
Karen Hong, DO
W. Ashley Hood, DO
Mickey L. Hooper, DO
Teresa Ann Hubka, DO
Jennifer Hummel, DO
Genevieve Hunkele
Jackilyn Huse, OMS
Angie T. Huynh, OMS
Mary Joy Hyde, DO
Renee Hypolite, DO
Timothy James Immonen, DO
Grace Isaacson, OMS
Michele Jacobson, DO
Alana Jadowski-Revoal, DO
Alessandra Jannette, OMS
Margaret A. Jaskowski-Lutsic, DO
David M. Jaspan, DO
Sara Javadi, OMS
Corinne E. Jedynek-Bell, DO
Jeffery E. Jensen, DO
Madeline Jentink, OMS
Deanah A. Jibril, DO
Dr. Darryl C. Johnson, DO
Joseph R. Johnson, DO
Zoe Johnson, OMS
Sarah M. Jones, DO
Karen Jones, OMS
Laurel M. Jordan, DO
Judith A. Joslin-Page, DO

Sung Eun Kang, OMS
Shin Young Kang, DO
Harika Kantamneni, DO
Rachel Kaplan, DO
Bradley L. Kasavana, DO
Howard K. Kaufman, DO
Rebecca Kawagoe, OMS
Michael Kelly, DO
Whitney Kelly, OMS
Leah Kemble, OMS
Michael F. Kenner, DO
Jun D. Kim, DO
Joseph A. Kingsbury, DO
Robert S. Kinsella, DO
James D. Koerner, DO
Ju Yong Koh, OMS
Carolyn Kollar, DO
Shruti Konda, OMS
Alexandra Koontz, OMS
Michael R. Krause, DO
Sara E. Krueger, DO
Claire Kunkel, OMS
Maria Labra, OMS
Jennifer Landes, DO
Ashley M. Lane, DO
Michelle M. Lang, DO
Rhodesia N. Lastrap, DO
Scott D. Lauer, DO
Lauren Lauer, OMS
Casey E. Laws, DO
Mark M. LeDuc, DO
Dr. Mark Lee, DO
Lindsey Leggett, OMS
Kayci Lewis, DO
Elizabeth G. Lindsey, DO
Adrienne Loftis, DO

Karla F. Loken, DO
Yelizavet D. Lomakova, OMS
William P. Long, DO
Megan Looby, DO
Brendan Lushbough, OMS
Thanh Luu, DO
Meghan M. Mace, OMS
Ankita Mahajan, DO
Kavita Mahajan-Merritt, DO
Kiley Manetta, DO
Gregory A. Mann, DO
Sarah Manners, DO
Caitlin Marshall, OMS
Valerie Martin, OMS
Tracey N. McCarthy, DO
Thomas McCartney, DO
Kirsten McDaniel, DO
Alysha McFalls, OMS
Tracey McIntire, DO
Nikki Ann Medina, OMS
Kelly Menge, DO
Brigham Merrell, OMS
James E. Merrill, DO
Jessica Millard, OMS
Klas Daniel Miller, DO
Emma Miller, DO
Rosalyn Green Miller, DO
Seth Minton, OMS
Jacqueline C. Mirate, DO
Mary Mitchell, OMS
Chavone Momon-Nelson, DO
Douglas W. Moore, DO
Madeline Moore, OMS
Kaori Morimoto, OMS
Cynthia Morris, DO

David C. Murphy, DO
Kateryna Mykhaylova, OMS
Daniel Toufic Nassar, OMS
Arax B. Nazarian, DO
Meaghan Nelsen, DO
Jeffrey R. Nelson, DO
Emily Nelson, OMS
Mollie Newbern, OMS
Adam Joseph Newborn
Nguyen Nguyen, DO
Hannah Nguyen, OMS
Thy Nguyen, OMS
Gregory P. Norwood, DO
Emmanuel U. Nwogu, DO
James O'Neil, OMS
Patricia O'Toole, DO
Leslie J. Ollar, DO
Kristin Oller, OMS
Paul Russell Osterdahl, Jr., DO
Elizabeth A. Ott, DO
Mychelle A. Owen, DO
Amy Owen, OMS
Roger Packard, DO
Simonette Padron, OMS
Priya Panneerselvam, DO
Dr. Gerald E. Pass, DO
Monica Quinlan Paulson, OMS
James J. Perez, DO
Kerry Anne Perkins, DO
Connie M. Perkins, DO
James D. Peters, II, DO
Tram Pham, Student
Ruth A. Pickering, DO
Richard R. Polk, DO
Mary E. Pugmire, DO

Fatima Rahlouni, OMS
George B. Ramie, DO
Nathan Rapp, DO
Marydonna M. Ravasio, DO
Marlee Reardon, DO
Edward O. Reece, II, DO
Mary Ann Reed, OMS
Lindsay Renz, OMS
Kathleen Riley, OMS
Caitlin Roach, OMS
Jessica Roberts, OMS
Connie S. Roberts, DO
Matthew Robison, DO
Lawrence E. Rogina, DO
Brunilda Rosario, DO
Blake Rosenthal, OMS
Clare Rudman, OMS
Tracie Rulewicz, DO
Harika Sandhu, OMS
Stephanie Sandoval, OMS
Radmila A. Sarkisova, DO
Nancy Sarmiento, OMS
Laura Schoerning, OMS
Jonathan Sefton, DO
Kate Seideman, OMS
Robert J. Seiler, DO
Sissi N. Selinger, DO
Janet Marie Shackelford, MD
Evan Shikora, DO
Kelly D. Shrum, DO
Tameka Sisco, DO
Kevin Skuran, DO
James W. Smith, DO
Adam T. Smith, DO
Lucy Smith, OMS

Dana Snell-Hargrove, DO
Kaylie Snyder, DO
Natalia Ann Sopiartz, OMS
Kevin Sorah, DO
Melanie Spall, OMS
Paul B. Spartzak, DO
Lynn M. Speaks, DO
Christina Spencer, DO
Abigail Sprunger, OMS
Emily Staudenmaier, DO
Christy L. Stevens, DO
Elizabeth Stevenson, DO
Melissa R. Stoffel, DO
Stephanie Stoker, OMS
David M. Sullivan, OMS
Renee K. Sundstrom, DO
Heidi Sungurlu, DO
Madison Tackett, OMS
Tanya Taival, DO
Selma J. Taylor, DO
Holly Trace Taylor
Joseph H. Tedesco, DO
Angela Teige, DO
Jill R. Terry, DO
Stacy D. Thomas, DO
Lorie A. Thomas, DO
Michaela Thomas
William C. Tindall, DO
Alicia Tomlin, OMS
Mark C. Torres, DO
Douglas N. Toussaint, DO
Theresa D. Tran, DO
Brittanie Tran, OMS
Terry B. Tressler, DO
Lakeeya K. Tucker, DO

Geron D. Turke, DO
Kelsey Ulanowicz, OMS
Stefanie Navarrete, OMS
Ann-Sophie Van Backle, OMS
Kelsi Van Heise, OMS
Kristina Van Nuys, OMS
Noel Varghese, DO
W. Nolley Vereen, DO
Canh Jeff V. Vo, DO
Ifeanyi Walson, OMS
Shelbie Walters, OMS
Bruce S. Wang, DO
Bonita M. Wang, DO
Rachel Watson, OMS
Michelle E. Webster, DO
Taylor Marie Weidman, DO
Colleen R. Wells, DO
Erin Westerholm, DO
Zsa Zsa C. Whyce, OMS
Hannah Wikoff, OMS
Jodi Wiley, OMS
Martha E. Wilfong, DO
Tracy L. Wilkerson, DO
Sonja Williams, DO
Eleanor Williams, OMS
Gregory S. Willis, DO
Jessica Wilson, DO
Gregory L. Woodfill, DO
Emily Woods, DO
Micah Wright, DO
Jamie Wright, DO
Shelley Xu, OMS
David B. Young, DO
Alyssa Zalenski Stapf, DO

Mission

The American College of Osteopathic Obstetricians and Gynecologists is committed to women's health through the Osteopathic and holistic practice of obstetrics and gynecology.

Vision

The American College of Osteopathic Obstetricians and Gynecologists will provide an Osteopathic Community for the support, fellowship and engagement of women's healthcare professionals.

Values

ACOOG Offers Member Support:

Member driven
Compassionate
Accountable

ACOOG Promotes Fellowship:

Lifelong Community
Access to Member Network

ACOOG Provides Opportunities for Engagement:

Leadership Roles
Teaching and Mentorship
Scholarly Activity

ACCOG Staff

Michael J. Geria, DO, FACOOG (Dist.)
Executive Vice President

William Bradford, DO, FACOOG (Dist.)
Vice President of Evaluation

Valerie Bakies Lile, CAE, FACOOG (Hon.)
Executive Director

Andrew Crim, CHCP
Director of Education and Professional Development

Jimmie L Evans II
Accounting Manager

Nnamdi Ibegbu
Membership Coordinator

Martha Prud'homme
Program Manager

